

SUMMER 2025

6 WEEK SESSION

Monday, June 9, 2025 –
Thursday, July 17, 2025

8 WEEK SESSION

Monday, June 9, 2025 –
Thursday, July 31, 2025



REGISTRATION BEGINS

Wednesday, April 2, 2025



COLLEGE
of the **DESERT**

collegeofthedesert.edu

Apply online at www.cccapply.org



43-500 Monterey Avenue,
Palm Desert, California 92260

BOARD OF TRUSTEES

Joel Kinnamon, Ed.D.
Mark Meyer
Ronald Oden
Rubén AriAztlán Pérez
Mary Jane Sanchez-Fulton

ADMINISTRATION

Val Martinez Garcia
Acting Superintendent/President

Misty Burruel
Interim Vice President, Instruction

Amanda Phillips
Acting Vice President,
Student Services

Raymond “Skip” West III, Ph.D.
Interim Vice President,
Administrative Services

Diana Galindo
Vice President, Human Resources
and Labor Relations

Campus Telephones

Campus Operator	(760) 346-8041
Academic Skills Center	773-2557
Admissions and Records	773-2516
Assessment Testing	776-7413
Athletics	773-2591
Bookstore	773-2564
Campus Security	341-2111
Child Development Center.	862-1308
College Nurse.	776-7211
Cell Phone	413-1278
Counseling Center	773-2520
Disabled Student Programs & Services.	773-2534
East Valley - Indio.	776-7200
EOPS/CARE Programs	773-2539
Financial Aid Office.	773-2532
International Education Office	776-7205
Library, Main Desk.	773-2563
Office of Student Life	862-1317
Parking	773-2515
President’s Office	773-2500
Tutorial Center	776-7241
Veterans’ Services	773-2536
Vice President, Instruction	773-2590
Vice President, Student Services.	423-6644
Vice President, Administrative Services.	773-2511
West Valley - Palm Springs	674-7800

MISSION STATEMENT

College of the Desert is an inclusive, student-centered community college providing high-quality degree, certificate, and transfer programs that are accessible, affordable, and responsive to the diverse needs of students and our community. By preparing workforce professionals and leaders, the College enhances the local economy, closes persistent equity gaps, and improves the quality of life in the Coachella Valley and surrounding communities.

Academic Programs

Applied Sciences & Business	773-2571
Arts and Media	773-2574
Communication & Humanities	773-2572
Health Sciences and Education.	773-2579
Kinesiology and Athletics	773-2591
Library & Learning Resources	568-7517
Mathematics and Science	773-2573
Social Sciences	773-2574



Registration

Academic Calendar	4
Drop Deadlines	5
Important Dates	5
Payment Deadlines	4
Registration Priority Dates	4
Registration Fees, Refunds	6

Information

Administration	2
Bookstore	12
Campus Guide Index	47
Campus Guide - Palm Desert	48
Career & Workforce Solutions Center	41
Disabled Students Program & Svs	22
Disclaimer, Notice of	5
Learn Your Way	8
Library	23
Map - Indio	42
Mission Statement	2
Off Site Classes	43-45
pEDGE	25, 35, 45
Public Safety	3, 27, 31
Self Service	7
Technology Requirements	46
Tutoring & Academic Skills Ctr	13
Work Experience	9

Class Listings

Accounting	10
Adult Basic Education (ABE)	10
Agriculture/Environmental Horticulture	11
Agriculture/Plant Science	12
Air Conditioning/HVAC	12
American Sign Language	12
Anthropology	12
Applications & Inform. Systems	13
Architecture	13
Art	13
Art History	14
Astronomy	14
Automotive Technology	14
Biology	15
Business Management	16
California State Fire Marshal	29
Chemistry	16
Child Development & Education	16
Communication Studies	17
Computer Info. Systems	18
Computer Science	19
Counseling	19
Criminal Justice	20
Culinary Arts	21
Digital Design & Production	21
Disabled Students Prog. & Svs	23
Drafting	23
Economics	23
Emergency Medical Responder	23
English	24
ESL - Non-Credit (ESLN)	26
Ethnic Studies	27
Film	29
Finance	29
Fire	29
Geography	29
Geology	29
Health Sciences	30
History	31
Hotel & Restaurant	31
Kinesiology	32
Mass Communication	34
Mathematics	34
Music	36
Natural Resources	36
Philosophy	37
Physical Therapist Assistant	37
Political Science	37
Psychology	38
Sociology	39
Spanish	40
Varsity Sports Off Season	32
Vocational Nursing	41
Welding	41
Work Experience, General	41

Student Services

see page 11 and_
collegeofthedesert.edu

COD Bookstore

The Bookstore will be opened
Monday-Thursday
9:00 a.m. - 3:00 p.m.
Closed Fridays

COD - East Valley

To learn more about the East Valley Education Centers, call 760-776-7200, visit us online at www.collegeofthedesert.edu/indio or email offcampussites@collegeofthedesert.edu.

Student Health & Wellness

June 9 - July 31

Monday - Thursday
10:00 a.m. - 2:00 p.m.

Library

June 9 - July 31

The library will be opened
Monday - Thursday
8:00 a.m. - 6:00 p.m.
24/7 "Ask a Librarian"
is always available.

Tutoring & Academic Skills Center (TASC)

June 9 - July 31

(760) 773-2557

Monday - Thursday
8:00 a.m. - 6:00 p.m.
subject to change without notice.

Editor: Rosalyn Weissmann
Office of Instruction

Public Safety

Students and all others on campus should report any unusual occurrences regarding the damage or loss of property on campus to the Department of Public Safety in the SOUTH ANNEX, Room 16.

The District cannot be responsible for the personal property of students, employees or others utilizing college facilities. Students and all others on campus should report any unusual occurrences regarding the damage or loss of property to the Department of Public Safety.

CALL 911

or

Public Safety

(760) 341-2111 or

Ext. 2111 on campus

JUNE

S	M	T	W	T	F	S
1	2	3	4	5	6	7
8	9	10	11	12	13	14
15	16	17	18	19	20	21
22	23	24	25	26	27	28
29	30					

JULY

S	M	T	W	T	F	S
		1	2	3	4	5
6	7	8	9	10	11	12
13	14	15	16	17	18	19
20	21	22	23	24	25	26
27	28	29	30	31		

AUGUST

S	M	T	W	T	F	S
					1	2
3	4	5	6	7	8	9
10	11	12	13	14	15	16
17	18	19	20	21	22	23
24	25	26	27	28	29	30

Holidays
 No Classes
 Final Exam Day
 Add or Drop Deadline

Summer 2025 Registration Priority is based on units completed by the end of Winter 2025 Intersession

Registration Levels for Current and Re-enrolling Students in Good Standing

Level	Who	Date	Time
1A	DSPS, Veterans, EOPS-CARE, CalWorks, Foster Youth, Student Parents (unless 8A applies)*	Wednesday, April 2	9:00 a.m.
1B	TRIO-ACES, TRIO-DSPS, TRIO-Veterans, (unless 8A applies)*	Wednesday, April 2	12:00 p.m.
1C	91 - 100 COD Units & Athletics (unless 8A applies)*	Wednesday, April 2	3:00 p.m.
2A	81 - 90 COD Units & ASCOD & MESA (unless 8A applies)*	Thursday, April 3	9:00 a.m.
2B	71 - 80 COD Units & CINC, Tutors in TASC, Student Ambassadors, Black Student Success Center, International Education Students (unless 8A applies)*	Thursday, April 3	12:00 p.m.
2C	61 - 70 COD Units	Thursday, April 3	3:00 p.m.
3A	51 - 60 COD Units	Friday, April 4	9:00 a.m.
4A	ABE & ESLN Certificate Earned, Dreamer Resource Center (unless 8A applies)*	Monday, April 7	9:00 a.m.
4B	Winter 2025 EDGE/pLEDGE students with 12 or more units	Monday, April 7	12:00 p.m.
4C	Winter 2025 EDGE/pLEDGE students with fewer than 12 units	Monday, April 7	3:00 p.m.
5A	41 - 50 COD Units	Tuesday, April 8	9:00 a.m.
5B	31 - 40 COD Units	Tuesday, April 8	12:00 p.m.
5C	21 - 30 COD Units	Tuesday, April 8	3:00 p.m.
6A	15 - 20 COD Units	Wednesday, April 9	9:00 a.m.
6B	10 - 14 COD Units	Wednesday, April 9	12:00 p.m.
6C	5 - 9 COD Units	Wednesday, April 9	3:00 p.m.
7A	1- 4 COD Units, 0 COD Units earned; currently enrolled in 0-12 or more units.	Friday, April 11	9:00 a.m.
8A	New students to COD who have completed the online orientation requirement.	Monday, April 14	9:00 a.m.
9A	101 or more units; 2 or more terms of Academic Probation and/or 2 or more terms of Progress Probation.		
	*Applies unless students meet criteria for 8A. Foster Youth are exempt.	Tuesday, April 15	9:00 a.m.
9B	Open Enrollment	Tuesday, April 15	12:00 p.m.

ENROLLMENT FEE DEADLINE

To avoid being dropped from classes for non-payment, students must pay within three (3) days of registration for the Summer 2025 term. Count the day you enroll as the first day. Students enrolled in courses they do not attend are responsible for enrollment fees and final grades if not dropped by applicable course deadline. If you have been awarded financial aid, you will not be dropped for non-payment.



All Summer classes are short-term. Dates on this page apply to regularly scheduled classes meeting **in person**. Check Self Service for dates for online sections. Short-term start and end dates are printed below each section in the Class Schedule.

June 5 Residency Appeals.

June 9 Mon **6-WEEK CLASSES BEGIN**

June 10 Tues Last day to ADD for 6-week classes

June 10 Tues Last day to DROP and be eligible for a REFUND for 6-week classes.
Students enrolled beyond this date are financially responsible for their fees.

June 13 Fri Classes do NOT meet. College closed every FRIDAY through August 8

June 15 Sun Last day to DROP a 6-week class without a “W”

June 19 Thurs HOLIDAY - Juneteenth - NO THURSDAY CLASS MEETINGS

June 25 Wed Last day to submit Summer 2025 Application to Graduate

July 3 Thurs HOLIDAY - Fourth of July observed - NO THURSDAY CLASS MEETINGS

July 7 Mon Last day to DROP a 6-week class with a “W”

July 17 Thurs 6-WEEK CLASSES END - Final Exam Day

June 9 Mon **8-WEEK CLASSES BEGIN**

June 11 Wed Last day to ADD for 8-week classes

June 11 Wed Last day to DROP and be eligible for a REFUND for 8-week classes.
Students enrolled beyond this date are financially responsible for their fees.

June 13 Fri Classes do NOT meet. College closed every FRIDAY through August 8

June 17 Tues Last day to DROP an 8-week class without a “W”

June 19 Thurs HOLIDAY - Juneteenth - NO THURSDAY CLASS MEETINGS

June 25 Wed Last day to submit Summer 2025 Application to Graduate

July 3 Thurs HOLIDAY - Fourth of July observed - NO THURSDAY CLASS MEETINGS

July 17 Thurs Last day to DROP an 8-week class with a “W”

July 31 Thurs 8-WEEK CLASSES END - Final Exam Day

Notice of Disclaimer

Every reasonable effort has been made to determine that everything stated in this class schedule is accurate. Because this publication must be prepared well in advance of the period of time it covers, changes in some programs inevitably will occur.

Courses and programs offered, together with other matters contained herein, are subject to change without notice by the administration of the Desert Community College District of College of the Desert, and in addition, some courses or programs that are offered may have been canceled because of insufficient enrollment, or because of elimination or reduction in programs, or because of any other reason considered sufficient by the College Superintendent/President or designee.

Open enrollment policy: Unless specifically exempted by statute, every course, course section, or class which is to be reported for state apportionment, is open for enrollment, and participation by any person who has been admitted to the College and who meets the student success requirements.

The district cannot be responsible for the personal property of students, employees or others utilizing college facilities. Students and all others on campus should report any unusual occurrences regarding the damage or loss of property to College Security.

REGISTRATION FEES**REQUIRED FEES:**

Enrollment Fees (waived for CCPG (BOG) recipients).	\$46.00 per unit
Health Fee*	\$16.00 for Summer Session—Refer to Health Center for description of services.

*Health Fee: Only students who depend exclusively on prayer for healing are exempt from fee.

NON-RESIDENT TUITION:

Non-California Resident.....	\$325.00 per unit + \$0.25 per unit for Student Center Fee
Non-U.S. Citizen.....	\$325.00 per unit + \$0.25 per unit for Student Center Fee
Arizona Resident Fee.....	\$138.00 per unit + \$0.25 per unit for Student Center Fee

OTHER FEES:

Student Center Fee.....	\$ 0.25 per unit
Student Representation Fee.....	\$ 2.00 Supports student government representatives.
Nursing Malpractice Insurance.....	\$10.00 (Maximum \$20 per year.) Not covered by Fee Waiver.
Transportation Fee – Per Vehicle	\$ 0.00 No parking fee Summer 2025.
Audit Fee.....	\$15.00 per unit
Materials Fee.....	\$15.00-\$150.00 depending on the course. (See course note for exact amount)
International Student Medical Insurance is required. Please contact International Education Office for information.	

Please note: Enrollment fee is established by the California State Legislature and is subject to change.

NON-PAYMENT DROPS

Enrollment Fees must be paid within three (3) days of enrolling (count the day enrolled as the first day) to avoid being dropped for non-payment.

Students enrolled in courses they do not attend are responsible for enrollment fees and final grades if not dropped by applicable course deadline.

Petitions to drop past the established deadline are not accepted for courses not dropped due to lack of awareness of the withdrawal procedure or deadline. An online Course Information Report is available to provide all pertinent course deadline information.

REFUND POLICY

Refund deadlines vary for classes during each summer term. To qualify for a refund, a student must officially withdraw from the class by the Refund Deadline date on page 5.

Refunds, less a \$10.00 processing fee, will be processed automatically beginning July 22, 2025 and will either be mailed to the student's address on file with Admissions and Records, or returned as a credit to the credit card from which fees were originally paid. See Refund Policy in the Course Catalog for more information. Refunds of less than \$10 will not be processed and must be requested in person from the Bursar's Office.

REFUND DEADLINES:

A community college district shall not refund any enrollment fee paid by a student for program changes made after the first two weeks of instruction for a primary term-length course, or after the 10 percent point of the length of the course for a short-term course, unless the program change is a result of action by the district to cancel or reschedule a class or to drop a student pursuant to subdivision (l) of section 55003 where the student fails to meet a prerequisite.

Enrollment, Health and Non-Resident Tuition Fees.... Refundable if dropped on the 2nd day of a 4-week or 6-week class, the 3rd day of an 8-week class.

Student Representation Fee and Transportation Fee. Refundable if student completely withdraws by the 2nd day of a 4 or 6-week class, the 3rd day of an 8-week class. (Permit, receipt and proof of dropped classes must be returned to the Bursar's Office.)

Student Registration Has Changed



College of the Desert has transitioned from WebAdvisor to Self-Service for online student access. **Beginning Summer 2023**, students began to use Self-Service to add/drop courses, add themselves to waitlists, and utilize the add authorization process to enroll in closed courses. Important information on Self-Service has been placed in the student portal.

Students will still register according to their registration priority in the student planning area of Self-Service. An instructional How to Register video can be found on the student portal.

WebAdvisor will no longer be available and will be shut down on December 17, 2023.

The add code process has been replaced with Add Authorization via Self-Service to add a course during the *Add Authorization period*. Add Codes are not used.

Faculty, staff, and students may verify if a course requires approval to add a course (authorization to add) by using the tool below which is found in the Student Portal, Faculty Resource Webpage, and in the Catalogs & Schedules webpage.



In Self-Service, once the student receives instructor approval to add a course the authorized section will have a blue “Authorized for Add” flag on their schedule. When a student receives

instructor approval via Self-Service to add a course, the student will need to click the Register button to finish registering. Registration will process assuming all prerequisites and holds have been cleared.

Also, students should make sure to drop a course they have decided not to attend. Faculty are no longer required to drop during the semester. Not dropping a course will result in an FW grade.

LEARN YOUR WAY, ON YOUR SCHEDULE, AT COLLEGE OF THE DESERT

Attend classes in-person, online or a combination of both – you choose!
Our flexible course structure allows you to pick the mode that works best for you!

FULLY ONLINE

Synchronous

Fully online with required livestream class meetings at a scheduled time

Asynchronous

Fully online, no scheduled livestream class meetings, in-depth reading and writing due regularly

HYFLEX

Choose how to attend each session

1. Synchronous,
2. Asynchronous, or
3. Face-to-face

ON CAMPUS

Hybrid

Mostly online with some required on-campus meetings

Traditional Face-to-Face Sessions

Fully on campus at the scheduled class time and location



COLLEGE
of the
DESERT

Find out more at collegeofthedesert.edu
or call us at 760.346.8041



Career & Work Force Solutions Center, Administration Building, Rooms 5 & 6

Phone: (760) 862-1344

Email: workexperience@collegeofthedesert.edu,

Website: www.collegeofthedesert.edu/workexperience

8 Week Session: June 9 - July 31, 2025

Summer session office hours: By appointment only

What Is Work Experience Education?

College of the Desert's Work Experience Education is a unique academic program where students apply what they have learned in the classroom to a real work environment - all while earning college credit!

By enrolling in a Work Experience course, students will participate in experiential learning activities that will enhance their skill set and strengthen effective work habits. Additionally, students have the opportunity to be coached and mentored by a faculty advisor as a subject matter expert in the student's field of study.

All students who currently work, volunteer, intern, or that have a student worker or federal work study position are eligible to enroll. Credits earned are transferrable to the CSU system. Students may enroll in General Work Experience or an Occupational course based on the student's educational goal and current job-related duties.

General Work Experience (WEG-095A)

WEG-095A is for students who currently have a position that **does not** relate to the student's occupational/educational goal. 1-5 credits of General Work Experience per semester can be earned per semester providing that the hour requirement is met. See chart below.

Occupational Work Experience (XXX-095A)

Occupational courses, such as: AUTO-095A, KINE-095A, BUHM-095A, etc. are for students majoring in the respective field and have a current position that directly aligns with the major/educational goal. If their current position **does** relate to their educational/occupational goal, 1-5 credits in any occupational work experience course can be earned per semester, providing that the hour requirement is met. See chart below. Here's a full list of [participating Work Experience programs](#).

Registration Details

1. Student must have a job, internship, volunteer, student worker, or federal work study position to enroll.
2. Determine the number of units to enroll in (based on the hours you work, see chart below).
3. Determine which course you will be enrolling in: General or an Occupational course (see description above). If you need further assistance, contact the Work Experience Office before enrolling.
4. Enroll via Self Service:
 - Use the chart below to help you pre-determine up to how many units you may qualify to earn based on the number of hours you will complete. When registering via Self Service, you must choose from the drop-down menu to select the number of units you qualify for. There are no exceptions to the minimum hour requirement.
5. Check CANVAS by the first day of class to complete required forms and get started on the course.

Additional occupational courses may be available if not listed on Self Service. Call the Work Experience office for details.

Units	Total required hours	Average weekly hours
1	54	7
2	108	14
3	162	21
4	216	27
5	270	34

PAYMENT PLAN OPTION

College of the Desert offers an optional payment plan to assist with the payment of enrollment fees. Please note there is a \$20 administrative processing fee per semester for this service. For more information on the payment plan, please go to collegeofthedesert.edu Self Service, Finance. Please note: Students are responsible for their class schedules and fee payments. Please check the accuracy of your class schedule by going to collegeofthedesert.edu Go to MyCOD, then Self Service.

Adult Basic Education (ABE) and English As A Second Language (ESLN) Registration

Registration for new/continuing ABE students will begin on 4/15/2025.

English As A Second Language (ESLN) Registration:

Registration for new and continuing students will begin on 04/15/2025.

Please visit the College of the Desert Admissions webpage and click on the Adult Basic Education Registration link or the English As A Second Language link for details.

SECT	COURSE	TITLE	U	TIME	DAYS	BLDG/RM	INSTRUCTOR
------	--------	-------	---	------	------	---------	------------

Accounting

BUAC 010 uses QuickBooks, a complete computerized accounting system for small businesses. Learn how this well-designed accounting program is used to set up a chart of accounts, reconcile checking accounts, create and print invoices, receipts, and statements, track payables, inventory, and receivables, and generate reports and graphs. Additional topics include: A review of basic accounting concepts, payroll transactions, and the creation of a company using QuickBooks accounting.

0138	BUAC 010 ACCTG W/QUICKBOOKS		3.0	126 TOTAL HRS	TBA	FULLONLN	Romero,J
------	-----------------------------	--	-----	---------------	-----	----------	----------

Note: 6 week class: 06/09 - 07/17
 Note: Students must access this fully online class at www.collegeofthedesert.edu/ on or before June 9th, to begin the course.

BUAC 020A is the study of accounting as an information system including basic principles and procedures of accounting. Advisory: MATH 065

0164	BUAC 020A FINANCIAL ACCTG		4.0	72 TOTAL HRS	TBA	FULLONLN	Gerardi,J
------	---------------------------	--	-----	--------------	-----	----------	-----------

Note: 6 week class: 06/09 - 07/17
 Note: Students must access this fully online class at www.collegeofthedesert.edu/ on or before June 9th, to begin the course.

BUAC 020B emphasizes accounting procedures for planning and controlling operations. Focus on costing systems, cost-volume-profit relationship, profit planning, and performance analysis.

0157	BUAC 020B MANAGERIAL ACCTG		4.0	72 TOTAL HRS	TBA	FULLONLN	Gerardi,J
------	----------------------------	--	-----	--------------	-----	----------	-----------

Note: 6 week class: 06/09 - 07/17
 Note: Students must access this fully online class at www.collegeofthedesert.edu/ on or before June 9th, to begin the course.

Adult Basic Education

Note: All ABE classes are 8 weeks starting on June 9th and ending on July 31st and are fully online. Students must access these fully online classes at www.collegeofthedesert.edu/ upon enrollment, to begin the course. Classes are graded on a Pass/No Pass basis only.

7736	ABE 320A FUNDAMENTALS/ENGLISH	0.0	80 TOTAL HRS	TBA	FULLONLN	Williams,J
7902	ABE 320B FUNDAMENTALS/ENGLISH	0.0	80 TOTAL HRS	TBA	FULLONLN	Williams,J
7916	ABE 320C FUNDAMENTALS/ENGLISH	0.0	80 TOTAL HRS	TBA	FULLONLN	Williams,J
7920	ABE 320D FUNDAMENTALS/ENGLISH	0.0	80 TOTAL HRS	TBA	FULLONLN	Santucci,A
7966	ABE 323A AMERICAN LITERATURE	0.0	80 TOTAL HRS	TBA	FULLONLN	Williams,J
7968	ABE 323B WORLD LITERATURE	0.0	80 TOTAL HRS	TBA	FULLONLN	Williams,J
7972	ABE 324A READING CONTROL LAB I	0.0	80 TOTAL HRS	TBA	FULLONLN	Santucci,A
7742	ABE 324B READING CONTROL LAB II	0.0	80 TOTAL HRS	TBA	FULLONLN	Santucci,A
7744	ABE 326A U.S. HISTORY I	0.0	80 TOTAL HRS	TBA	FULLONLN	McGuire,C
7906	ABE 326B U.S. HISTORY II	0.0	80 TOTAL HRS	TBA	FULLONLN	McGuire,C
7746	ABE 328A AMERICAN GOVERNMENT	0.0	80 TOTAL HRS	TBA	FULLONLN	McGuire,C
7908	ABE 328B ECON	0.0	80 TOTAL HRS	TBA	FULLONLN	McGuire,C
7748	ABE 332A WORLD HISTORY I	0.0	80 TOTAL HRS	TBA	FULLONLN	McGuire,C
7950	ABE 332B WORLD HISTORY II	0.0	80 TOTAL HRS	TBA	FULLONLN	McGuire,C
7942	ABE 335A WORLD GEOGRAPHY I	0.0	80 TOTAL HRS	TBA	FULLONLN	McGuire,C
7944	ABE 335B WORLD GEOGRAPHY II	0.0	80 TOTAL HRS	TBA	FULLONLN	McGuire,C
7756	ABE 348A LIFE SCIENCE	0.0	80 TOTAL HRS	TBA	FULLONLN	McGuire,C
7910	ABE 348B PHYSICAL SCIENCE	0.0	80 TOTAL HRS	TBA	FULLONLN	McGuire,C
7956	ABE 348C EARTH SCIENCE	0.0	80 TOTAL HRS	TBA	FULLONLN	McGuire,C
7946	ABE 351A MARINE SCIENCE	0.0	80 TOTAL HRS	TBA	FULLONLN	McGuire,C
7926	ABE 361A FINE ARTS: ART	0.0	80 TOTAL HRS	TBA	FULLONLN	McGuire,C
7928	ABE 361B FINE ARTS: MUSIC	0.0	80 TOTAL HRS	TBA	FULLONLN	McGuire,C
7932	ABE 361C FINE ARTS: THEATER	0.0	80 TOTAL HRS	TBA	FULLONLN	McGuire,C
7752	ABE 364 GED TEST PREPARATION	0.0	80 TOTAL HRS	TBA	FULLONLN	McGuire,C
7780	ABE 368A BEGINNING TYPING I	0.0	80 TOTAL HRS	TBA	FULLONLN	McGuire,C
7922	ABE 391A HEALTH ISSUES I	0.0	80 TOTAL HRS	TBA	FULLONLN	McGuire,C
7924	ABE 391B HEALTH ISSUES II	0.0	80 TOTAL HRS	TBA	FULLONLN	McGuire,C

SECT	COURSE	TITLE	U	TIME	DAYS	BLDG/RM	INSTRUCTOR
Synchronous online classes - classes meet on TechConnect Zoom during the scheduled days/times.							
7856	ABE 342A	PRACTICAL BASIC MATH I	0.0	09:00a-11:00a	MTWR TBA	CNVSZOOM FULLONLN	Santucci,A
Note: This online class meets on TechConnect Zoom from 9:00am to 11:00am MTWR and assignments are completed on Canvas.							
7872	ABE 342A	PRACTICAL BASIC MATH I	0.0	05:00p-07:00p	MTWR TBA	CNVSZOOM FULLONLN	Castillo,J
Note: This online class meets on TechConnect Zoom from 5:00pm to 7:00pm MTWR and assignments are completed on Canvas.							
7858	ABE 342B	PRACTICAL BASIC MATH II	0.0	09:00a-11:00a	MTWR TBA	CNVSZOOM FULLONLN	Santucci,A
Note: This online class meets on TechConnect Zoom from 9:00am to 11:00am MTWR and assignments are completed on Canvas.							
7874	ABE 342B	PRACTICAL BASIC MATH II	0.0	05:00p-07:00p	MTWR TBA	CNVSZOOM FULLONLN	Castillo,J
Note: This online class meets on TechConnect Zoom from 5:00pm to 7:00pm MTWR and assignments are completed on Canvas.							
7862	ABE 344A	MATH FOR LIVING I	0.0	09:00a-11:00a	MTWR TBA	CNVSZOOM FULLONLN	Santucci,A
Note: This online class meets on TechConnect Zoom from 9:00am to 11:00am MTWR and assignments are completed on Canvas.							
7876	ABE 344A	MATH FOR LIVING I	0.0	05:00p-07:00p	MTWR TBA	CNVSZOOM FULLONLN	Castillo,J
Note: This online class meets on TechConnect Zoom from 5:00pm to 7:00pm MTWR and assignments are completed on Canvas.							
7864	ABE 344B	MATH FOR LIVING II	0.0	09:00a-11:00a	MTWR TBA	CNVSZOOM FULLONLN	Santucci,A
Note: This online class meets on TechConnect Zoom from 9:00am to 11:00am MTWR and assignments are completed on Canvas.							
7878	ABE 344B	MATH FOR LIVING II	0.0	05:00p-07:00p	MTWR TBA	CNVSZOOM FULLONLN	Castillo,J
Note: This online class meets on TechConnect Zoom from 5:00pm to 7:00pm MTWR and assignments are completed on Canvas.							
7866	ABE 346A	ALGEBRA I	0.0	09:00a-11:00a	MTWR TBA	CNVSZOOM FULLONLN	Santucci,A
Note: This online class meets on TechConnect Zoom from 9:00am to 11:00am MTWR and assignments are completed on Canvas.							
7882	ABE 346A	ALGEBRA I	0.0	05:00p-07:00p	MTWR TBA	CNVSZOOM FULLONLN	Castillo,J
Note: This online class meets on TechConnect Zoom from 5:00pm to 7:00pm MTWR and assignments are completed on Canvas.							
7868	ABE 346B	ALGEBRA II	0.0	09:00a-11:00a	MTWR TBA	CNVSZOOM FULLONLN	Santucci,A
Note: This online class meets on TechConnect Zoom from 9:00am to 11:00am MTWR and assignments are completed on Canvas.							
7884	ABE 346B	ALGEBRA II	0.0	05:00p-07:00p	MTWR TBA	CNVSZOOM FULLONLN	Castillo,J
Note: This online class meets on TechConnect Zoom from 5:00pm to 7:00pm MTWR and assignments are completed on Canvas.							

Agriculture/Environmental Horticulture

AGEH 001 is a general course in Environmental Horticulture with emphasis on nursery operations, landscaping, and turfgrass management.

Synchronous online classes - Students must access these fully online classes at www.collegeofthedesert.edu/ on or before June 9th, to begin the course.

0112	AGEH 001	HORTICULTURE	3.0	54 TOTAL HRS	TBA	FULLONLN	Place,J
Note: 8 week class: 06/09 - 07/31							
0114	AGEH 001	HORTICULTURE	3.0	54 TOTAL HRS	TBA	FULLONLN	Place,J
Note: 8 week class: 06/09 - 07/31							

Student Support Services
available in Summer

Welcome Center in Palm
Desert Campus

Monday - Thursday
7:00 a.m. - 5:30 p.m.
enrollmentservices@collegeofthedesert.edu/
(760) 346-8041

Counseling Office

Monday - Thursday
8:00 a.m. - 5:30 p.m.
www.collegeofthedesert.edu/students/counseling/default.php

Admissions & Records

Monday - Thursday
8:00 a.m. - 5:30 p.m.
Enrolls@collegeofthedesert.edu
(760) 773-2516
<https://www.collegeofthedesert.edu/students/admissions/default.php>

Noncredit Office

Monday - Thursday
8:00 a.m. - 5:30 p.m.
abepd@collegeofthedesert.edu
(760) 776-7348

Financial Aid

Monday - Thursday
8:00 a.m. - 5:30 p.m.
Email:
FAO@Collegeofthedesert.edu
Website: <http://www.collegeofthedesert.edu/students/fa/>
(760) 773-2532

Office of Student Life

Monday - Thursday
8:00 a.m. - 5:00 p.m.

DSPS (760) 773-2534

Monday - Thursday
8:00 a.m. - 5:00 p.m.
dspinfo@collegeofthedesert.edu

International Education

Monday - Thursday
8:00 a.m. - 6:00 p.m.
cmccabe@collegeofthedesert.edu

EOPS/CARE (760) 773-2539

Monday - Thursday
8:30 a.m. - 5:00 p.m.
eops@collegeofthedesert.edu

Foster Youth Services

Monday - Thursday
8:00 a.m. - 4:30 p.m.
irrivera@collegeofthedesert.edu

Dreamer Resource Center

Monday - Wednesday
8:00 a.m. - 5:00 p.m.
Thursday 8:00 a.m.-1:30 p.m.
dreamers@collegeofthedesert.edu

12 AGR - ANTH

BOOKSTORE
(760) 773-2564

CollegeOfTheDesertShop.com

The College of the Desert Bookstore, located on the first floor of the Cravens Student Services Center, contains all needed course materials, whether required or optional. Both new and used textbooks are available for purchase, and there are also many textbooks available for rent and in digital format.

The Bookstore also carries a wide variety of school supplies (imprinted and non-imprinted), in addition to software, electronics, and Apple Products. BarCharts and other reference materials are also available to assist students in their academic endeavors.

In addition, College of the Desert clothing and gift items are available, as well as a variety of snacks, drinks, and sundries.

Summer Bookstore hours are Monday - Thursday 9:00 a.m. - 3:00 p.m. and Closed on Fridays.

For more information, call 760-773-2564, or visit our website at collegeofthedesertshop.com

The bookstore website can also be accessed from the college website. Near the top right of the main page, click on the "Student Services" tab, and from there click on "bookstore."

Evening Classes appear in BOLD print throughout this schedule.

SECT	COURSE	TITLE	U	TIME	DAYS	BLDG/RM	INSTRUCTOR
------	--------	-------	---	------	------	---------	------------

AGEH 095A, a work experience course of supervised employment is designed to assist students in developing transferable employability skills, career awareness, learning industry culture, competencies and norms, and developing professional networks that support career mobility. To enroll, students must have a job or internship placement in a part-time or full-time capacity and related to Environmental Horticulture Turf grass. Students must work 54 hours per unit enrolled. For hour/unit conversion and course details, visit the Work Experience webpage: www.collegeofthedesert.edu/workexperience. This work experience course of supervised employment meets four times during the semester (2 on-campus coaching sessions and 2 job-site visits). Required Application Form, syllabus, and course related information will be available via Canvas by the first day of each session. For additional enrollment questions, contact the Work Experience office (760) 862-1344.

0810	AGEH 095A	AGEH/TURFGRASS WK EX 1.0			TBA	AD5	Vaca,E
------	-----------	--------------------------	--	--	-----	-----	--------

Note: 8 week class: 06/09 - 07/31

Administration of Justice is now Criminal Justice (see page 20)

Agriculture/Plant Science

AGPS 005 offers an opportunity to learn the basic structure and function of plants, their place in the world of human activity and the methods used to manipulate the botanical world to human advantage.

Prerequisite: ENG 061 IGETC: 5B
Asynchronous online classes - Students must access these fully online classes at www.collegeofthedesert.edu/ on or before June 9th, to begin the course.

0185	AGPS 005	PLANT SCIENCE	3.0	54 TOTAL HRS	TBA	FULLONLN	Vaca,E
							Note: 8 week class: 06/09 - 07/31
0189	AGPS 005	PLANT SCIENCE	3.0	54 TOTAL HRS	TBA	FULLONLN	Vaca,E
							Note: 8 week class: 06/09 - 07/31

Air Conditioning/HVAC

ACR 077 covers the methods for conservation of energy in HVACR applications. A lab uniform is required for this course. Advisory: ACR 060

0159	ACR 077	ENERGY CONSERVATION	3.0	08:00a-10:30a	MW	AS107	Alvarez,J
				10:30a-12:15p	MW	AS108	Betancourt,R
0166	ACR 077	ENERGY CONSERVATION	3.0	05:00p-08:00p	TR	AS108	Betancourt,R
				08:00p-09:50p	TR	AS108	Rodriguez,A

Note: 8 week class: 06/09 - 07/30
Note: 8 week class: 06/10 - 07/31
Note: No class meetings June 19 and July 3

ACR 078 covers industry practices for safe and efficient handling of common refrigerants.

0153	ACR 078	REFRIGERANT MGMT	3.0	05:00p-07:30p	MW	AS107	Brown,G
				07:30p-09:15p	MW	AS108	Arbuckle,C
0165	ACR 078	REFRIGERANT MGMT	3.0	08:00a-11:00a	TR	AS107	Brown,G
				11:00a-12:50p	TR	AS108	Arbuckle,C

Note: 8 week class: 06/09 - 07/30
Note: 8 week class: 06/10 - 07/31
Note: No class meetings June 19 and July 3

American Sign Language

ASL 001 students acquire basic ASL vocabulary and grammar, surveying American Deaf history and culture at an accelerated pace. IGETC: 6A

Asynchronous online classes - Students must access these fully online classes at www.collegeofthedesert.edu/ on or before June 9th, to begin the course.

0358	ASL 001	ELEMENTARY ASL I	5.0	90 TOTAL HRS	TBA	FULLONLN	O'Grady,T
							Note: 8 week class: 06/09 - 07/31
0302	ASL 001	ELEMENTARY ASL I	5.0	90 TOTAL HRS	TBA	FULLONLN	O'Grady,T
							Note: 8 week class: 06/09 - 07/31

Anthropology

ANTH 002 is a topical introduction to the cross-cultural study of human societies. IGETC: 4A

0347	ANTH 002	CULTURAL ANTHRO	3.0	54 TOTAL HRS	TBA	FULLONLN	Slade,M
							Note: 8 week class: 06/09 - 07/31

Note: Students must access this fully online class at www.collegeofthedesert.edu/ on or before June 9th, to begin the course.

SECT	COURSE	TITLE	U	TIME	DAYS	BLDG/RM	INSTRUCTOR
------	--------	-------	---	------	------	---------	------------

Applications & Information Systems

AI5 005 covers computer survival skills.

0172	AI5 005	OFFICE TECHNOLOGIES	3.0	90 TOTAL HRS	TBA	FULLONLN	Weston,A
------	---------	---------------------	-----	--------------	-----	----------	----------

Note: 8 week class: 06/09 - 07/31
 Note: Students must access this fully online class at www.collegeofthedesert.edu/ on or before June 9th, to begin the course.

AI5 012 covers office support skills. Advisory: AI5 005

0186	AI5 012	OFFICE SUPPORT SKILLS	3.0	54 TOTAL HRS	TBA	FULLONLN	Richards,M
------	---------	-----------------------	-----	--------------	-----	----------	------------

Note: 8 week class: 06/09 - 07/31
 Note: Students must access this fully online class at www.collegeofthedesert.edu/ on or before June 9th, to begin the course.

AI5 073 covers word processing software, concepts, procedures, and skills. Advisory: AI5 005

0183	AI5 073	WORD PROCESSING	3.0	90 TOTAL HRS	TBA	FULLONLN	Richards,M
------	---------	-----------------	-----	--------------	-----	----------	------------

Note: 8 week class: 06/09 - 07/31
 Note: Students must access this fully online class at www.collegeofthedesert.edu/ on or before June 9th, to begin the course.

Architecture

ARCH 014 is an introductory course in the history of architecture as taken from the point of Western ideals and examines architecture from the beginning of time to Classical Greece and Rome. Advisory: RDG 061

0162	ARCH 014	HISTORY OF ARCH I	3.0	54 TOTAL HRS	TBA	FULLONLN	Delahanty,S
------	----------	-------------------	-----	--------------	-----	----------	-------------

Note: 6 week class: 06/09 - 07/17
 Note: Students must access this fully online class at www.collegeofthedesert.edu/ on or before June 9th, to begin the course.

ARCH 150 facilitates student access to digital design drawing and modeling, tools, skills and concepts actively used in concurrent design studio. Assignments support concurrent design studio. Discussion with an emphasis on introductory digital design drawing.

0150	ARCH 150	FOUNDATION DIGITAL DESIGN	3.0	08:00a-01:10p	MTWR	AS105	Rivera,M
------	----------	---------------------------	-----	---------------	------	-------	----------

Note: 8 week class: 06/09 - 07/31
 Note: No class meetings June 19 and July 3

Art

ART 001A is an introduction to the fundamentals of drawing and composition which enable students to communicate images as creative statements. Various drawing materials, techniques and compositional structure are explored.

0702	ART 001A	DRAW & COMP, BEG	3.0	09:00a-11:50a	MTWR	ART102	Rodriguez,L
------	----------	------------------	-----	---------------	------	--------	-------------

Note: 8 week class: 06/09 - 07/31
 Note: No class meetings June 19 and July 3

ART 001B is an intermediate drawing course with an emphasis on color and mixed media material used in content based and compositional problems. Prerequisite: ART-001A

0744	ART 001B	DRAW & COMP, INT	3.0	09:00a-11:50a	MTWR	ART102	Rodriguez,L
------	----------	------------------	-----	---------------	------	--------	-------------

Note: 8 week class: 06/09 - 07/31
 Note: No class meetings June 19 and July 3

ART 003A is an introduction to the fundamentals of two dimensional design in which students gain experience in organizing their thoughts to communicate visual images as creative statements. Visual problem solving involves basic elements and principles of design using various papers, acrylic paint and mixed media applications.

0745	ART 003A	BASIC DESIGN & COLOR	3.0	12:30p-03:20p	MTWR	ART104	Rodriguez,L
------	----------	----------------------	-----	---------------	------	--------	-------------

Note: 8 week class: 06/09 - 07/31
 Note: No class meetings June 19 and July 3

Asynchronous online classes - Students must access these fully online classes at www.collegeofthedesert.edu/ on or before June 9th, to begin the course.

0696	ART 003A	BASIC DESIGN & COLOR	3.0	90 TOTAL HRS	TBA	FULLONLN	Maddigan,E
0708	ART 003A	BASIC DESIGN & COLOR	3.0	90 TOTAL HRS	TBA	FULLONLN	Maddigan,E

Note: 8 week class: 06/09 - 07/31

Tutoring and Academic Skills Center (TASC)

The Tutoring and Academic Skills Center Center is here to help you succeed in your classes this spring! TASC provides academic support, independent study spaces, tutoring, and academic skills workshops for all actively enrolled COD students.

Looking for a tutor? Free, drop-in peer tutoring is available, with no appointment needed! Supported subjects include biology, chemistry, math, nursing, physics, statistics, writing, and many more. Visit our Language Lab to find resources for American Sign Language (ASL), English as a Second Language (ESL/ESLN), Spanish, and Japanese.

College of the Desert students also have FREE access to online tutoring services with NetTutor. NetTutor offers online and after-hours access to tutor support in a wide range of subjects. Students can live chat with a tutor, submit subject questions, or drop off a paper for review.

To learn more about TASC tutoring options, including subjects, schedules, hours and locations, please visit the TASC Canvas course or our website:

www.collegeofthedesert.edu/asc

Or, call us at (760) 776-7241.

Summer hours:
 Monday - Thursday
 8:00 a.m. - 6:00 p.m.
 subject to change without notice

14 ART - AUTO

Summer classes are being held in person, synchronously via Canvas, or asynchronously. Synchronous meetings occur at the same time and day as designated in this class schedule. Be sure to check the start and end date, and drop deadlines that apply to each class you select.

Self Service

College of the Desert has transitioned to a new way of registering and making changes to your class schedule.

Self Service is available for Summer and Fall registration.

Check out the information on page 7 of this class schedule. Watch the COD website for details.

In person and synchronous online Evening Classes appear in BOLD print throughout this schedule.

SECT	COURSE	TITLE	U	TIME	DAYS	BLDG/RM	INSTRUCTOR
ART 007 explores the history, cultural importance, process and contemporary concepts of ceramics. Advisory: ENG 001A							
0715	ART 007	CERAMICS	3.0	09:00a-11:50a	MTWR	ART105	Smith,A
Note: 8 week class: 06/09 - 07/31 Note: No class meetings June 19 and July 3							
ART 007B expands intermediate level student knowledge and expertise in the technologies of the ceramic art form. Prerequisite: ART 007							
0762	ART 007B	CERAMICS, INT	3.0	09:00a-11:50a	MTWR	ART105	Smith,A
Note: 8 week class: 06/09 - 07/31 Note: No class meetings June 19 and July 3							
ART 034 is an overview course open to all students wanting to know more about the different areas of Digital Art and Media. Introduction to fundamental concepts, practices and theories of digital art. Topics include: integration of traditional design, color, and compositional principles with contemporary digital tools. Demonstrations of digital image capture, image manipulation, illustration, layout, animation, 3D, and emerging technologies will also be given.							
0757	ART 034	INTRO TO DIGITAL ART	3.0	90 TOTAL HRS	TBA	FULLONLN	Zang,Z
Note: 8 week class: 06/09 - 07/31 Note: Students must access this fully online class at www.collegeofthedesert.edu/ on or before June 9th, to begin the course.							

Art History

ARTH 010 is a general introduction to art across time and diverse cultures. Advisory: ENG 001A IGETC: 3A

0136	ARTH 010	UNDERSTANDING ART	3.0	54 TOTAL HRS	TBA	FULLONLN	Martin,D
Note: 6 week class: 06/09 - 07/17 Note: Students must access this fully online class at www.collegeofthedesert.edu/ on or before June 9th, to begin the course. Note: Section 0136 is a DEMAND CLASS and may open for enrollment when other sections have filled.							

Astronomy

A 001 is an introductory survey of planetary, stellar and galactic astronomy designed for students not majoring in science. Advisory: ENG 061 & MATH 049 IGETC: 5A
Asynchronous online classes - Students must access these fully online classes at www.collegeofthedesert.edu/ on or before June 9th, to begin the course.

0348	A 001	DESCRIP ASTRONOMY	3.0	54 TOTAL HRS	TBA	FULLONLN	EIShafie,A
Note: 8 week class: 06/09 - 07/31							
0355	A 001	DESCRIP ASTRONOMY	3.0	54 TOTAL HRS	TBA	FULLONLN	Asaro,M
Note: 8 week class: 06/09 - 07/31							
0367	A 001	DESCRIP ASTRONOMY	3.0	54 TOTAL HRS	TBA	FULLONLN	Asaro,M
Note: 8 week class: 06/09 - 07/31 Note: Section 0367 is a DEMAND CLASS and may open for enrollment when other sections have filled.							
A 003 is an introduction to the current solar system. A comparative study will be made of the planets and their satellites, dwarf planets, asteroids, and interplanetary debris.							
Advisory: ENG 061 & MATH 049 IGETC: 5A, 5C							
0379	A 003	PLANET ASTRO	4.0	108 TOTAL HRS	TBA	FULLONLN	Elsenousy,A
Note: 8 week class: 06/09 - 07/31 Note: Students must access this fully online class at www.collegeofthedesert.edu/ on or before June 9th, to begin the course.							

Automotive Technology

AUTO 010 provides an overview of automotive theory and service procedures including lecture/discussion and hands on experience understanding and servicing fundamental automotive components and systems.

0197	AUTO 010	INTRO AUTO TECH	3.0	06:00p-08:50p	MTWR	DM11A	Reylek,S
Note: 8 week class: 06/09 - 07/31 Note: No class meetings June 19 and July 3							
AUTO 011B provides lecture/discussion and hands-on experience understanding, servicing, troubleshooting, diagnosing and repairing fundamental automotive electrical circuit and system malfunctions. A \$20.00 test fee for the appropriate Automotive Service Excellent (ASE) Student Exam is required. A uniform is required for this course. Prerequisite: AUTO 010 or concurrent enrollment							
0192	AUTO 011B	AUTO ELEC	4.0	08:00a-11:30a 12:00p-03:35p	WR	DM11A DM11A	Redman,D
Note: 8 week class: 06/11 - 07/31 Note: A testing fee of \$20.00 is required. Note: No class meetings June 19 and July 3							

SECT	COURSE	TITLE	U	TIME	DAYS	BLDG/RM	INSTRUCTOR
------	--------	-------	---	------	------	---------	------------

AUTO - BIO 15

AUTO 012A provides lecture/discussion and hands-on experience understanding, servicing, troubleshooting, diagnosing and repairing automotive steering and suspension systems. A \$20.00 test fee for the appropriate Automotive Service Excellent (ASE) Student Exam is required. A uniform is required for this course. Prerequisite: AUTO 010 or concurrent enrollment

0199	AUTO 012A	AUTO SUSP & STEERING	4.0	08:00a-11:20a 12:00p-03:20p	FS FS	DM11A DM11A	Shrum,D
------	-----------	----------------------	-----	--------------------------------	----------	----------------	---------

Note: 8 week class: 06/13 - 08/02
 Note: A testing fee of \$20.00 is required.
 Note: No class meeting July 4

AUTO 018 provides lecture/discussion and hands-on experience understanding, servicing, troubleshooting, diagnosing and repairing automotive heating and air conditioning systems. A testing fee is required. A \$20.00 test fee for the appropriate Automotive Service Excellent (ASE) Student Exam is required. A uniform is required for this course.

0193	AUTO 018	AUTO HVAC	4.0	08:00a-11:05a 12:00p-03:10p	MT MT	DM11A DM11A	Anderson,D
------	----------	-----------	-----	--------------------------------	----------	----------------	------------

Note: 8 week class: 06/09 - 07/29
 Note: A testing fee of \$20.00 is required.

AUTO 095A, a work experience course of supervised employment is designed to assist students in developing transferable employability skills, career awareness, learning industry culture, competencies and norms, and developing professional networks that support career mobility. To enroll, students must have a job or internship placement in a part-time or full-time capacity and related to Automotive Technology. Students must work 54 hours per unit enrolled. For hour/unit conversion and course details, visit the Work Experience webpage: www.collegeofthedesert.edu/workexperience. This work experience course of supervised employment meets four times during the semester (2 on-campus coaching sessions and 2 job-site visits). Required Application Form, syllabus, and course related information will be available via Canvas by the first day of each session. For additional enrollment questions, contact the Work Experience office (760) 862-1344.

0820	AUTO 095A	AUTO TECH WK EXP	1.0		TBA	AD5	Anderson,D
------	-----------	------------------	-----	--	-----	-----	------------

Note: 8 week class: 06/09 - 07/31

Biology

BI 004 is an introduction to biology for non-science majors covering the foundations of biology with a laboratory component accompanying this course. Advisory: ENG 061 IGETC: 5B*, 5C*

0663	BI 004	ELEMENTS OF BIOLOGY	4.0	54 TOTAL HRS	TBA	HYBRID	Cruz,E
------	--------	---------------------	-----	--------------	-----	--------	--------

Note: 8 week class: 06/09 - 07/31
 Note: This is a hybrid online class that meets on Tuesday and Thursday at the Palm Desert campus for all lab hours. All remaining required hours will be asynchronous online in addition to homework assignments.
 Note: No class meetings June 19 and July 3

0661	BI 004	ELEMENTS OF BIOLOGY	4.0	54 TOTAL HRS	TBA	HYBRID	Cruz,E
------	--------	---------------------	-----	--------------	-----	--------	--------

Note: 8 week class: 06/09 - 07/31
 Note: This is a hybrid online class that meets on Tuesday and Thursday at the Palm Desert campus for all lab hours. All remaining required hours will be asynchronous online in addition to homework assignments.
 Note: No class meetings June 19 and July 3

BI 007 is a course for science majors covering mammals and related topics. Advisory: BI-004 and ENG-001A IGETC: 5B

0647	BI 007	BIOLOGY OF MAMMALS	3.0	54 TOTAL HRS	TBA	FULLONLN	Rosteck,R
------	--------	--------------------	-----	--------------	-----	----------	-----------

Note: 8 week class: 06/09 - 07/31
 Note: Students must access this fully online class at www.collegeofthedesert.edu/ on or before June 9th, to begin the course.

BI 011 provides an introduction and understanding of the biology of viruses to both science and non-science major students, specifically emphasizing those viruses implicated in human diseases. Advisory: ENG 061 IGETC: 5B

0623	BI 011	BIOLOGY OF VIRUSES	3.0	54 TOTAL HRS	TBA	FULLONLN	Paquette,H
------	--------	--------------------	-----	--------------	-----	----------	------------

Note: 8 week class: 06/09 - 07/31
 Note: Students must access this fully online class at www.collegeofthedesert.edu/ on or before June 9th, to begin the course.

0619	BI 011	BIOLOGY OF VIRUSES	3.0	54 TOTAL HRS	TBA	FULLONLN	Tracey,S
------	--------	--------------------	-----	--------------	-----	----------	----------

Note: 8 week class: 06/09 - 07/31
 Note: Students must access this fully online class at www.collegeofthedesert.edu/ on or before June 9th, to begin the course.
 Note: Section 0619 is a DEMAND CLASS and may open for enrollment when other sections have filled.

Biology students

It is important to attend the first class meeting of each course in which you are enrolled no matter if it is designated as a lecture or a lab. Students not attending the first class meeting may be replaced by other students.

CALL 911
in an Emergency
or the
Department of
Public Safety

(760) 341-2111
or
Ext 2111

24 Hour Service
located in
South Annex 16



Early Childhood Education

Students should be advised that both CDE-101 and CDE-102 are required courses that must be completed prior to working with children in a program licensed by the State of California.

Students not attending the first class meeting may be replaced by other students.

**>>Check <<
the start-date
end-date &
drop deadlines
that apply to each
class you select**

SECT	COURSE	TITLE	U	TIME	DAYS	BLDG/RM	INSTRUCTOR
------	--------	-------	---	------	------	---------	------------

BI 013 is the first of a two course sequence that offers an in depth study of the human body. This course covers anatomical terminology, cells and tissues, the integumentary system, the skeletal system, articulations, the muscular system, the nervous system and special senses.
Prerequisite: MATH 054 Advisory: ENG 061 IGEC: 5B, 5C

►0632 BI 013 ANAT & PHYS I 4.0 09:00a-10:30a MTWR NDI0B303 Tesch,A
Note: 8 week class: 06/09 - 07/31 10:45a-12:15p MTWR NDI0B229
 Note: This OFF-CAMPUS CLASS meets at the Indio Campus, 45524 Oasis Street, Indio. Students at off-campus sites should allow sufficient travel time to arrive on time and remain for the duration of the class. Non-Participation and excessive absences may be grounds for being dropped from a course.
 Note: No class meetings June 19 and July 3

►0672 BI 013 ANAT & PHYS I 4.0 02:00p-03:30p MTWR NDI0B303 Tesch,A
Note: 8 week class: 06/09 - 07/31 03:45p-05:15p MTWR NDI0B229
 Note: This OFF-CAMPUS CLASS meets at the Indio Campus, 45524 Oasis Street, Indio. Students at off-campus sites should allow sufficient travel time to arrive on time and remain for the duration of the class. Non-Participation and excessive absences may be grounds for being dropped from a course.
 Note: No class meetings June 19 and July 3

Business/Management

BUMA 010 covers the formation, structure, objectives, and ethics of contemporary business enterprises.
Asynchronous online classes - Students must access these fully online classes at www.collegeofthedesert.edu/ on or before June 9th, to begin the course.

0152 BUMA 010 INTRO BUSINESS 3.0 54 TOTAL HRS TBA FULLONLN Allan-Bentley,B
Note: 8 week class: 06/09 - 07/31

0176 BUMA 010 INTRO BUSINESS 3.0 54 TOTAL HRS TBA FULLONLN Allan-Bentley,B
Note: 8 week class: 06/09 - 07/31

BUMA 095A, a work experience course of supervised employment is designed to assists students in developing transferable employability skills, career awareness, learning industry culture, competencies and norms, and developing professional networks that support career mobility. To enroll, students must have a job or internship placement in a part-time or full-time capacity and related to Business Management. Students must work 54 hours per unit enrolled. For hour/unit conversion and course details, visit the Work Experience webpage: www.collegeofthedesert.edu/workexperience. This work experience course of supervised employment meets four times during the semester (2 on-campus coaching sessions and 2 job-site visits). Required Application Form, syllabus, and course related information will be available via Canvas by the first day of each session.
 For additional enrollment questions, contact the Work Experience office (760) 862-1344.

0848 BUMA 095A BUS MGMT WORK EXPER 1.0 TBA AD5 Cooper,D
Note: 8 week class: 06/09 - 07/31

Chemistry

CH 007 covers the basic principles of inorganic, organic and biochemistry. Previously offered as CH 004.
Prerequisite: MATH 054 Advisory: ENG 061

0612 CH 007FUNDAMENTALS OF CHEMISTRY 5.0 08:00a-10:10a MTWR MSTC153 Alou Hicks,M
Note: 8 week class: 06/09 - 07/31 10:20a-11:50a MTWR MSTC205
 Note: No class meetings June 19 and July 3

Child Development & Education

CDE 101 examines the major physical, psychosocial, and cognitive/language developmental milestones for children, both typical and atypical, from conception through adolescence. Advisory: ENG 001A

0721 CDE 101 CHILD GROWTH&DEVLPMNT 3.0 10:00a-12:10p MTWR ECE101 STAFF
Note: 6 week class: 06/09 - 07/17
 Note: No class meetings June 19 and July 3

Asynchronous online classes - Students must access these fully online classes at www.collegeofthedesert.edu/ on or before June 9th, to begin the course.

0730 CDE 101 CHILD GROWTH&DEVLPMNT 3.0 54 TOTAL HRS TBA FULLONLN Huffman,J
Note: 6 week class: 06/09 - 07/17

0739 CDE 101CHILD GROWTH&DEVLPMNT 3.0 54 TOTAL HRS TBA FULLONLN Avalos,M
Note: 8 week class: 06/09 - 07/31

0754 CDE 101CHILD GROWTH&DEVLPMNT 3.0 54 TOTAL HRS TBA FULLONLN STAFF
Note: 8 week class: 06/09 - 07/31

SECT	COURSE	TITLE	U	TIME	DAYS	BLDG/RM	INSTRUCTOR
------	--------	-------	---	------	------	---------	------------

CDE - COMM 17

CDE 102 introduces the processes of socialization focusing on the interrelationship of family, school, peers, and community. Examines the influence of multiple societal contexts. Explores the role of collaboration between family, community and schools in supporting children's development, birth through adolescence. Required for teachers of all early childhood education programs as a part of the 12 units for the Child Development Permit and licensing requirements for the State of California. Advisory: CDE 101

0735	CDE 102 CHILD, FAMILY & COMMUNITY 3.0	54 TOTAL HRS	TBA	FULLONLN	Avalos,M
------	---------------------------------------	--------------	-----	----------	----------

Note: 8 week class: 06/09 - 07/31
Note: Students must access this fully online class at www.collegeofthedesert.edu/ on or before June 9th, to begin the course.

CDE 103 examines the historical context and theoretical perspectives of developmentally appropriate practice and early care and education. Examines the role of the early childhood educator, identification of best practices for environmental design, curriculum, and teaching strategies. Explores teacher child relationships, professional ethics, career pathways, and professional standards. Advisory: ENG 001A

0710	CDE 103 PRINCIPLES & PRACTICES 3.0	54 TOTAL HRS	TBA	FULLONLN	Greene,D
------	------------------------------------	--------------	-----	----------	----------

Note: 8 week class: 06/09 - 07/31
Note: Students must access this fully online class at www.collegeofthedesert.edu/ on or before June 9th, to begin the course.

CDE 104 presents an overview of knowledge and skills related to providing appropriate curriculum and environments for young children through developmentally, culturally and linguistically appropriate practices. Prerequisite: CDE 101 & CDE 102, or concurrent enrollment

0727	CDE 104 INTRO TO CURRICULUM 3.0	54 TOTAL HRS	TBA	FULLONLN	Huffman,J
------	---------------------------------	--------------	-----	----------	-----------

Note: 8 week class: 06/09 - 07/31
Note: Students must access this fully online class at www.collegeofthedesert.edu/ on or before June 9th, to begin the course.

CDE 204 explores the application of child development theory to facilitate learning among young children, including: promoting self esteem, creativity, self discipline, development of physical and cognitive skills and literacy, and planning appropriate curriculum along with professional development of the teacher. Prerequisite: CDE 101 & CDE 102 & CDE 103 & CDE 104 & CDE 203 (formerly ECE 001, ECE 010, ECE 012, ECE 040 & ECE 046B)

▶0771	CDE 204 PRACTICUM 4.0	144 TOTAL HRS	TBA	HYFLEX	Avalos,M
-------	-----------------------	---------------	-----	--------	----------

Note: 8 week class: 06/09 - 07/31
Note: Choose how you attend class: (1) in-class physically Monday at 5:00pm-8:45pm at the Child Development Center, 45742 Oasis Street, room NDIO 132, Indio, (2) live streaming class at the same days and times via Zoom, or (3) watching Zoom recordings on your own. You have the flexibility to attend any way your schedule permits. Additional work is completed and submitted online via Canvas. HyFlex courses help you complete your education while allowing you to adapt it to your life. Students must access Canvas at www.collegeofthedesert.edu/ on or before June 9th, to begin the course.
Note: Students will complete student teaching practicum hours (108 hours) with a Mentor Teacher at sites in the Coachella Valley or with a Child Development Specialist at the COD McCarthy Family Child Development and Training Center.
Note: Students are required to have a valid TB skin test prior to working with children and can obtain it through the college by emailing the professor, maavalos@collegeofthedesert.edu Additional immunizations/vaccinations MMR, Tdap, COVID) will be required before starting lab hours.

Student Education Plans (SEP)

Did you know that the Student Success Act of 2012 (SB 1456) requires students with 15 degree applicable units or three semesters of attendance (whichever comes first), to have an SEP in order to receive priority registration.

In compliance with this law, students that meet those conditions and do not have an SEP will have to register much later than other students during Open Enrollment.

If you need more information about the SEP process, contact the Counseling Center at 760 773-2521.

Communication Studies

COMM 001 students learn to develop an effective style of public communication, including informative, expository, persuasive, extemporaneous, and impromptu forms of speaking.

Advisory: ENG 001A IGETC: 1C
Asynchronous online classes - Students must access these fully online classes at www.collegeofthedesert.edu/ on or before June 9th, to begin the course.

0204	COMM 001 PUBLIC SPEAKING	3.0	54 TOTAL HRS	TBA	FULLONLN	Reed,E
0206	COMM 001 PUBLIC SPEAKING	3.0	54 TOTAL HRS	TBA	FULLONLN	Christman,C
0210	COMM 001 PUBLIC SPEAKING	3.0	54 TOTAL HRS	TBA	FULLONLN	Christman,C
0212	COMM 001 PUBLIC SPEAKING	3.0	54 TOTAL HRS	TBA	FULLONLN	Reed,E
0214	COMM 001 PUBLIC SPEAKING	3.0	54 TOTAL HRS	TBA	FULLONLN	Reed,E
0216	COMM 001 PUBLIC SPEAKING	3.0	54 TOTAL HRS	TBA	FULLONLN	Shaw,W

Summer classes are being held in person, synchronously via Canvas, or asynchronously. Synchronous meetings occur at the same time and day as designated in this class schedule. Be sure to check the start and end date, and drop deadlines that apply to each class you select.

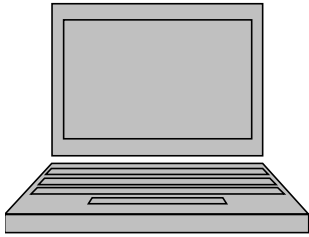

Interested in a
Distance Education
class?

Go to the
Student Services/Online
Classes page at:
collegeofthedesert.edu

All online students must:

1. Complete the standard admission and registration process.

2. Access the online class (or classes) by logging in to MyCOD on or before the start date of the class, to begin the course.

3. Have their own computer and Internet access. The college does **not** provide computers or Internet access for students in online classes.

If you have additional questions about our online program, please visit the College of the Desert home page. Click on the Student Services tab for "Online Classes".

SECT	COURSE	TITLE	U	TIME	DAYS	BLDG/RM	INSTRUCTOR
0218	COMM 001	PUBLIC SPEAKING Note: 6 week class: 06/09 - 07/17	3.0	54 TOTAL HRS	TBA	FULLONLN	Shaw,W
0232	COMM 001	PUBLIC SPEAKING Note: 6 week class: 06/09 - 07/17	3.0	54 TOTAL HRS	TBA	FULLONLN	Christman,C
0238	COMM 001	PUBLIC SPEAKING Note: 6 week class: 06/09 - 07/17	3.0	54 TOTAL HRS	TBA	FULLONLN	Shaw,W
0256	COMM 001	PUBLIC SPEAKING Note: 6 week class: 06/09 - 07/17	3.0	54 TOTAL HRS	TBA	FULLONLN	Rodgers,T
0258	COMM 001	PUBLIC SPEAKING Note: 6 week class: 06/09 - 07/17	3.0	54 TOTAL HRS	TBA	FULLONLN	Shaw,W
0262	COMM 001	PUBLIC SPEAKING Note: 6 week class: 06/09 - 07/17	3.0	54 TOTAL HRS	TBA	FULLONLN	Reed,E
0264	COMM 001	PUBLIC SPEAKING Note: 6 week class: 06/09 - 07/17	3.0	54 TOTAL HRS	TBA	FULLONLN	Alatorre,G
0266	COMM 001	PUBLIC SPEAKING Note: 6 week class: 06/09 - 07/17	3.0	54 TOTAL HRS	TBA	FULLONLN	Christman,C

Computer Information Systems

CIS 010 examines Information technology concepts. Advisory: CIS-005

Asynchronous online classes - Students must access these fully online classes at www.collegeofthedesert.edu/ on or before June 9th, to begin the course.

0167	CIS 010	COMPUTER LITERACY Note: 8 week class: 06/09 - 07/31	4.0	108 TOTAL HRS	TBA	FULLONLN	Marhuenda-Donate,F
0178	CIS 010	COMPUTER LITERACY Note: 8 week class: 06/09 - 07/31	4.0	108 TOTAL HRS	TBA	FULLONLN	Marhuenda-Donate,F

CIS 040 is an introduction to the computer hardware and software skills needed to help meet the growing demand for entry-level ICT professionals.

0188	CIS 040	IT ESSENTIALS Note: 8 week class: 06/09 - 07/31	4.0	108 TOTAL HRS	TBA	FULLONLN	Flores,M
------	---------	-----------------------------------------------------------	-----	---------------	-----	----------	----------

Note: Students must access this fully online class at www.collegeofthedesert.edu/ on or before June 9th, to begin the course.

CIS 053 explains the purpose of a variety of networking concepts and implements them appropriately; it determines and explains the appropriate cabling, device and storage technologies for your infrastructure; use the best practices to manage the network, determine policies and ensure business continuity; summarizes physical security and common attacks while securing the wired and wireless network; explains the network troubleshooting methodology and appropriate tools to support connectivity and performance. Successful completion of this course prepares the student to take the CompTIA Network+ N10-008 certification exam.

0184	CIS 053	COMPTIA NETWORK+ Note: 8 week class: 06/09 - 07/31	3.0	90 TOTAL HRS	TBA	FULLONLN	Jacobs,P
------	---------	--------------------------------------------------------------	-----	--------------	-----	----------	----------

Note: Students must access this fully online class at www.collegeofthedesert.edu/ on or before June 9th, to begin the course.

CIS 060 is an introduction to the fundamental principles and topics of Information Technology Security and Risk Management at the organizational level. It establishes the core knowledge required of any cyber security role and provides a springboard to intermediate-level cybersecurity jobs. Information and System Security incorporates best practices in hands-on troubleshooting, ensuring candidates have practical security problem-solving skills required to assess the security posture of an enterprise environment and recommend and implement appropriate security solutions. Monitor and secure hybrid environments, including cloud, mobile, and IoT. Operate with an awareness of applicable laws and policies, including principles of governance, risk, and compliance Identify, analyze, and respond to security events and incidents.

Note: This course requires a strong background in networking fundamentals.

0140	CIS 060	SYSTEMS SECURITY Note: 8 week class: 06/09 - 07/31	3.0	90 TOTAL HRS	TBA	FULLONLN	Flores,M
------	---------	--------------------------------------------------------------	-----	--------------	-----	----------	----------

Note: Students must access this fully online class at www.collegeofthedesert.edu/ on or before June 9th, to begin the course.

CIS 087 provides an introduction to programming and business applications using Python. The course focuses on developing the fundamental concepts and models of application development including the basic concepts of program design, debugging, data structures, structured and object-oriented programming, problem solving, programming logic, and fundamental design techniques.

0137	CIS 087	INTRO TO PYTHON Note: 8 week class: 06/09 - 07/31	3.0	90 TOTAL HRS	TBA	FULLONLN	Jacobs,P
------	---------	-------------------------------------------------------------	-----	--------------	-----	----------	----------

Note: Students must access this fully online class at www.collegeofthedesert.edu/ on or before June 9th, to begin the course.

Computer Science

CS 007A is an introduction to computer programming using the C++ language for students with no programming experience. Prerequisite: MATH 005

Asynchronous online classes - Students must access these fully online classes at www.collegeofthedesert.edu/ on or before June 9th, to begin the course.

0255	CS 007A	COMPUTER SCIENCE I	4.0	108 TOTAL HRS	TBA	FULLONLN	Sultana,S
		Note: 8 week class: 06/09 - 07/31					
0265	CS 007A	COMPUTER SCIENCE I	4.0	108 TOTAL HRS	TBA	FULLONLN	Kelbley,R
		Note: 8 week class: 06/09 - 07/31					

Counseling

COUN 102 provides students with a concrete plan for understanding and succeeding in transferring to a four-year college or university. Students may choose the Pass/No Pass grading option.

0142	COUN 102	STRAT/COLL TRANSFER	1.0	18 TOTAL HRS	TBA	FULLONLN	Cooper,S
		Note: 3 week class: 06/09 - 06/27					
		Note: Students must access this fully online class at www.collegeofthedesert.edu/ on or before June 9th, to begin the course.					

COUN 300 provides an introduction to College of the Desert for all incoming college students. Through this course, students will gain an understanding of our college structure, academic programs offered, student planning, financial aid, college expectations and support services. Students receive a Pass/No Pass grade mark.

9302	COUN 300	STUD DEV EDGE	0.0	09:00a-10:50a	MW	SOC15	STAFF
		Note: 3 week class: 06/09 - 06/25					
9310	COUN 300	STUD DEV EDGE	0.0	11:00a-12:50p	MW	COM203	STAFF
		Note: 3 week class: 06/09 - 06/25					
9314	COUN 300	STUD DEV EDGE	0.0	01:30p-03:20p	MW	COM203	STAFF
		Note: 3 week class: 06/09 - 06/25					
9304	COUN 300	STUD DEV EDGE	0.0	09:00a-11:10a	TR	COM203	STAFF
		Note: 3 week class: 06/10 - 06/26					
		Note: No class meeting June 19th					
9348	COUN 300	STUD DEV EDGE	0.0	09:00a-10:50a	MW	SOC15	STAFF
		Note: 3 week class: 06/30 - 07/16					
9354	COUN 300	STUD DEV EDGE	0.0	09:00a-11:10a	TR	COM203	STAFF
		Note: 3 week class: 07/01 - 07/17					
		Note: No class meeting July 3.					
▶9368	COUN 300	STUD DEV EDGE	0.0	09:00a-11:10a	TR	CDHS41	STAFF
		Note: 3 week class: 07/01 - 07/17					
		Note: This OFF-CAMPUS CLASS meets at the Wenzlaff Center, 11625 West Drive in Desert Hot Springs.					
		Note: No class meeting July 3.					
9356	COUN 300	STUD DEV EDGE	0.0	11:30a-01:40p	TR	COM203	STAFF
		Note: 3 week class: 07/01 - 07/17					
		Note: No class meeting July 3					
9601	COUN 300	STUD DEV EDGE	0.0	09:00a-10:50a	MW	SOC15	STAFF
		Note: 3 week class: 07/21 - 08/06					
9605	COUN 300	STUD DEV EDGE	0.0	11:00a-12:50p	MW	COM201	STAFF
		Note: 3 week class: 07/21 - 08/06					

East Valley sites (NDIO) (MECC) - Students at off-campus sites should allow sufficient travel time to arrive on time and remain for the duration of the class. Non-Participation and excessive absences may be grounds for being dropped from a course.

▶9322	COUN 300	STUD DEV EDGE	0.0	09:00a-10:50a	MW	NDIOB328	STAFF
		Note: 3 week class: 06/09 - 06/25					
▶9326	COUN 300	STUD DEV EDGE	0.0	12:00p-01:50p	MW	NDIOB302	STAFF
		Note: 3 week class: 06/09 - 06/25					
▶9324	COUN 300	STUD DEV EDGE	0.0	10:00a-12:10p	TR	NDIOB302	STAFF
		Note: 3 week class: 06/10 - 06/26					
		Note: No class meeting June 19th					
▶9330	COUN 300	STUD DEV EDGE	0.0	05:00p-06:50p	MW	NDIOB302	STAFF
		Note: 3 week class: 06/09 - 06/25					
▶9364	COUN 300	STUD DEV EDGE	0.0	09:00a-10:50a	MW	NDIOB328	STAFF
		Note: 3 week class: 06/30 - 07/16					
▶9607	COUN 300	STUD DEV EDGE	0.0	11:00a-12:50p	TR	MECCB6	STAFF
		Note: 3 week class: 07/22 - 08/07					
		Note: This OFF-CAMPUS CLASS meets at the Mecca Campus.					



The pLEDGE program provides 2025 high school graduates (or equivalent) from the Coachella Valley with two full years of tuition and fees at College of the Desert!

Participating students will complete at least one EDGE non-credit course to prepare for college and college-level coursework or a credit summer course to be eligible for pLEDGE.

EDGE non-credit courses: English EDGE (ENG-300), Math/Statistics EDGE (MATH-300 or SOC-300), or Student Development EDGE (COUN-300).

Students must also have a completed Financial Aid file, commit to full time enrollment, maintain good academic standing and participate in career preparation and community service. For more information, please contact the pLEDGE office at (760) 636-7970 or edge@collegeofthedesert.edu

**>>Check <<
the start-date
end-date &
drop deadlines
that apply to each
class you select**

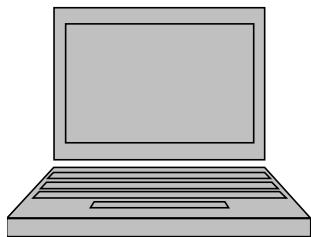

Interested in a
**Distance Education
class?**

Go to the
Student Services/Online
Classes page at:
collegeofthedesert.edu

All online students must:

1. Complete the standard admission and registration process.

2. Access the online class (or classes) by logging in to MyCOD on or before the start date of the class, to begin the course.

3. Have their own computer and Internet access. The college does **not** provide computers or Internet access for students in online classes.

If you have additional questions about our online program, please visit the College of the Desert home page. Click on the Student Services tab for "Online Classes".

SECT	COURSE	TITLE	U	TIME	DAYS	BLDG/RM	INSTRUCTOR
Asynchronous online classes - Students must access these fully online classes at www.collegeofthedesert.edu/ on or before the start date of the class, to begin the course.							
9334	COUN 300	STUD DEV EDGE	0.0	12 TOTAL HRS	TBA	FULLONLN	Huntzinger,J
Note: 3 week class: 06/09 - 06/26							
9336	COUN 300	STUD DEV EDGE	0.0	12 TOTAL HRS	TBA	FULLONLN	Huntzinger,J
Note: 3 week class: 06/09 - 06/26							
9338	COUN 300	STUD DEV EDGE	0.0	12 TOTAL HRS	TBA	FULLONLN	STAFF
Note: 3 week class: 06/09 - 06/26							
9340	COUN 300	STUD DEV EDGE	0.0	12 TOTAL HRS	TBA	FULLONLN	STAFF
Note: 3 week class: 06/09 - 06/26							
9372	COUN 300	STUD DEV EDGE	0.0	12 TOTAL HRS	TBA	FULLONLN	Huntzinger,J
Note: 3 week class: 06/30 - 07/17							
9374	COUN 300	STUD DEV EDGE	0.0	12 TOTAL HRS	TBA	FULLONLN	Huntzinger,J
Note: 3 week class: 06/30 - 07/17							
9376	COUN 300	STUD DEV EDGE	0.0	12 TOTAL HRS	TBA	FULLONLN	STAFF
Note: 3 week class: 06/30 - 07/17							
9627	COUN 300	STUD DEV EDGE	0.0	12 TOTAL HRS	TBA	FULLONLN	STAFF
Note: 3 week class: 07/21 - 08/07							
9631	COUN 300	STUD DEV EDGE	0.0	12 TOTAL HRS	TBA	FULLONLN	STAFF
Note: 3 week class: 07/21 - 08/07							
9633	COUN 300	STUD DEV EDGE	0.0	12 TOTAL HRS	TBA	FULLONLN	STAFF
Note: 3 week class: 07/21 - 08/07							
9621	COUN 300	STUD DEV EDGE	0.0	12 TOTAL HRS	TBA	FULLONLN	Basye,H
Note: 3 week class: 07/21 - 08/07							
9623	COUN 300	STUD DEV EDGE	0.0	12 TOTAL HRS	TBA	FULLONLN	Basye,H
Note: 3 week class: 07/21 - 08/07							
9635	COUN 300	STUD DEV EDGE	0.0	12 TOTAL HRS	TBA	FULLONLN	STAFF
Note: 2 week class: 07/28 - 08/08							

Criminal Justice

CJ 001 introduces students to the characteristics of the criminal justice system in the United States.

Advisory: ENG 061

IGETC: 4J

0748 CJ 001 INTRO TO CRIM JUSTI 3.0 54 TOTAL HRS TBA FULLONLN Miller,L

Note: 6 week class: 06/09 - 07/17

Note: Student must access this fully online class at www.collegeofthedesert.edu/ on or before June 9th, to begin the course.

CJ 024 students learn to write criminal justice reports that meet statistical, legal and prosecution requirements of the criminal justice system. Prerequisite: AJ 001 or CJ 001 or concurrent enrollment

0783 CJ 024 REPORT WRITING 3.0 54 TOTAL HRS TBA FULLONLN Miller,L

Note: 6 week class: 06/09 - 07/17

Note: Students must access this fully online class at www.collegeofthedesert.edu/ on or before June 9th, to begin the course.

CJ 026 is a study of the fundamental components and historical evolution of intelligence.

Prerequisite: AJ 001 or CJ 001 or concurrent enrollment Advisory: ENG 061

0716 CJ 026 HOMELAND SEC & INTELLIGEN 3.0 54 TOTAL HRS TBA FULLONLN Miller,L

Note: 6 week class: 06/09 - 07/17

Note: Student must access this fully online class at www.collegeofthedesert.edu/ on or before June 9th, to begin the course.

CJ 030 reviews in depth, criminals and institutional personnel involved in corrections at all levels.

Advisory: AJ 001 or CJ 001

0742 CJ 030 INTRO TO CORRECTIONS 3.0 54 TOTAL HRS TBA FULLONLN Lingle,N

Note: 6 week class: 06/09 - 07/17

Note: Student must access this fully online class at www.collegeofthedesert.edu/ on or before June 9th, to begin the course.

CJ 095A, a work experience course of supervised employment is designed to assist students in developing transferable employability skills, career awareness, learning industry culture, competencies and norms, and developing professional networks that support career mobility. To enroll, students must have a job or internship placement in a part-time or full-time capacity and related to Criminal Justice. Students must work 54 hours per unit enrolled. For hour/unit conversion and course details, visit the Work Experience webpage: www.collegeofthedesert.edu/workexperience. This work experience course of supervised employment meets four times during the semester (2 on-campus coaching sessions and 2 job-site visits). Required Application Form, syllabus, and course related information will be available via Canvas by the first day of each session.

For additional enrollment questions, contact the Work Experience office (760) 862-1344.

SECT	COURSE	TITLE	U	TIME	DAYS	BLDG/RM	INSTRUCTOR
0828	CJ 095A	CRIMINAL JUSTICE WK EXP 1.0			TBA	AD5	Farrell,P

Note: 8 week class: 06/09 - 07/31

Culinary Arts

CART 012 is a study of food choices, nutrition, protein structure, carbohydrates, the role of lipids and water, nutritious menu planning, and preparing nutritious foods.

0351	CART 012	CULINARY NUTRITION	3.0	54 TOTAL HRS	TBA	FULLONLN	Struwe,K
------	----------	--------------------	-----	--------------	-----	----------	----------

Note: 6 week class: 06/09 - 07/17

Note: Students must access this fully online class at www.collegeofthedesert.edu/ on or before June 9th, to begin the course.

CART 013 is a study of culinary measurements and crucial calculation concepts used in the restaurant and foodservice industry.

0357	CART 013	CULINARY MEASUREMENTS	3.0	54 TOTAL HRS	TBA	FULLONLN	Struwe,K
------	----------	-----------------------	-----	--------------	-----	----------	----------

Note: 6 week class: 06/09 - 07/17

Note: Students must access this fully online class at www.collegeofthedesert.edu/ on or before June 9th, to begin the course.

CART 060 covers the principles of hygiene and sanitation and the control and prevention of food borne illnesses in food service operations. No credit for CART 060 if student has successfully completed CART 001

Asynchronous online classes - Students must access these fully online classes at www.collegeofthedesert.edu/ on or before June 9th, to begin the course.

0343	CART 060	SANITATION AND SAFETY	2.0	36 TOTAL HRS	TBA	FULLONLN	Struwe,K
------	----------	-----------------------	-----	--------------	-----	----------	----------

Note: 6 week class: 06/09 - 07/17

.0371	CART 060	SANITATION AND SAFETY	2.0	36 TOTAL HRS	TBA	FULLONLN	Struwe,K
-------	----------	-----------------------	-----	--------------	-----	----------	----------

Note: 6 week class: 06/09 - 07/17

Digital Design & Production

DDP 100 is an overview course open to all students wanting to know more about the different areas of Digital Art and Media. Introduction to fundamental concepts, practices and theories of digital art. Topics include: integration of traditional design, color, and compositional principles with contemporary digital tools. Demonstrations of digital image capture, image manipulation, illustration, layout, animation, 3D, and emerging technologies will also be given.

0867	DDP 100	INTRO TO DIGITAL ART	3.0	90 TOTAL HRS	TBA	FULLONLN	Zang,Z
------	---------	----------------------	-----	--------------	-----	----------	--------

Note: 8 week class: 06/09 - 07/31

Note: Students must access this fully online class at www.collegeofthedesert.edu/ on or before June 9th, to begin the course.

DDP 101 is an introduction to digital imaging using the industry standard raster graphics editor (Adobe Photoshop). Students will learn to digitize, manipulate, and enhance digital images for graphic reproduction and use on the web. Includes retouching, color adjustment and color correction techniques. A good working knowledge of either Windows or Apple operating systems is recommended. (Formerly: DDP 001A)

0838	DDP 101	DIGITAL IMAGING	3.0	90 TOTAL HRS	TBA	FULLONLN	Kay,M
------	---------	-----------------	-----	--------------	-----	----------	-------

Note: 8 week class: 06/09 - 07/31

Note: Students must access this fully online class at www.collegeofthedesert.edu/ on or before June 9th, to begin the course.

DDP 102 is an introduction to vector-based software for graphic design (Adobe Illustrator). Students will create vector-based artwork, manipulate type and learn how to create dynamic content and illustrations for print and online delivery using an industry standard application (Adobe Illustrator). This course also explores fundamental design concepts and finding creative solutions using multiplicity of tools. A good working knowledge of either Windows or Apple operating systems and software is recommended. (Formerly: DDP 001B)

0809	DDP 102	DIGITAL ILLUSTRATION	3.0	90 TOTAL HRS	TBA	FULLONLN	Abril,M
------	---------	----------------------	-----	--------------	-----	----------	---------

Note: 8 week class: 06/09 - 07/31

Note: Students must access this fully online class at www.collegeofthedesert.edu/ on or before June 9th, to begin the course.



REGISTER TODAY

The DDP program is where art & design meets technology. We focus on teaching design thinking processes while you develop new digital skills that prepare you for a digital design career and/or transfer to a university.

NEW COURSES

DDP 133-0219
Nature Photography
16 weeks • 1.5 units
HYBRID

DDP 136-0389
Intro to Drone Imaging
16 weeks • 3 units
HYBRID • Th 6pm-8pm Zoom

DDP 161-0379
Intro to Game Design
16 weeks • 3 units
FULLY ONLINE

DDP 201-0387
Content for Accessibility
8 weeks • 3 units
FULLY ONLINE

DDP 202-0381
Assitive Technology
8 weeks • 3 units
FULLY ONLINE

ZERO TEXTBOOK COSTS



For more information contact
Professor Mari Abril at
mabril@collegeofthedesert.edu

DISABLED STUDENTS
PROGRAMS & SERVICES
(DSPS) 760 773-2534

DSPS at College of the Desert is committed to providing students with documented disabilities equal access to a community college education. Through the utilization of specialized instructional programs and disability related support services, DSPS encourages and fosters independence and assists students in attaining their educational and vocational goals.

DSPS course offerings will vary each semester. DSPS instructional support trainings are offered virtually and in person through the High Tech Center. The High Tech Center provides students access to adaptive hardware and software to support their academic needs.

WorkAbility III is a jointly funded program between the State Department of Rehabilitation and California Community Colleges to assist students/clients with disabilities in job placement.

Adapted Kinesiology classes are offered during some terms for students with disabilities. Adapted courses can include: Tennis, Badminton, Golf, Yoga, Physical Activity (weight training and fitness), and Fitness Aquatics.

Evening Classes
appear in BOLD print
throughout this
schedule.

SECT	COURSE	TITLE	U	TIME	DAYS	BLDG/RM	INSTRUCTOR	
<p><i>DDP 103 is an introduction to publication layout software (Adobe InDesign) through creative projects such as brochures and multi-page publications for print and electronic publishing. A good working knowledge of Windows or Apple operating software is recommended. (Formerly: DDP 002)</i></p>								
0817	DDP 103	PUBLICATION DESIGN PROD 3.0	90	TOTAL HRS	TBA	FULLONLN	Soltes,R	
<p>Note: 8 week class: 06/09 - 07/31 Note: Students must access this fully online class at www.collegeofthedesert.edu/ on or before June 9th, to begin the course.</p>								
<p><i>DDP 110 covers basic graphic design principles and techniques using current industry software. Students learn about graphic design terminology, history, career options, concepts, the design process, project research, generating ideas, elements and principles. Advisory: ART 003A and DDP 102</i></p>								
0815	DDP 110	GRAPHIC DESIGN	3.0	90	TOTAL HRS	TBA	FULLONLN	Abril,M
<p>Note: 8 week class: 06/09 - 07/31 Note: Students must access this fully online class at www.collegeofthedesert.edu/ on or before June 9th, to begin the course.</p>								
<p><i>DDP 120 students learn the basic concepts and skills of non-linear editing using video editing software (Adobe Premiere Pro).</i></p>								
0830	DDP 120	VIDEO POST PRODUCTION	3.0	90	TOTAL HRS	TBA	FULLONLN	Seichter,K
<p>Note: 8 week class: 06/09 - 07/31 Note: Students must access this fully online class at www.collegeofthedesert.edu/ on or before June 9th, to begin the course.</p>								
<p><i>DDP 131 covers basic digital photography techniques and the use of digital cameras. A digital camera with manually adjustable f-stops and shutter speeds and a corresponding camera manual is required.</i></p>								
0813	DDP 131	DIGITAL PHOTOGRAPHY	3.0	90	TOTAL HRS	TBA	FULLONLN	Klein,M
<p>Note: 8 week class: 06/09 - 07/31 Note: Students must access this fully online class at www.collegeofthedesert.edu/ on or before June 9th, to begin the course. Note: A digital camera of at least 5 or 6 megapixels is required.</p>								
<p><i>DDP 195 students learn how to set up their creative business, market their portfolio, acquire clients and set fees and much more. Whether you plan to run a graphic design company or work as a freelancer, understanding the nuts and bolts of running a creative business is essential.</i></p>								
0812	DDP 195	CREATIVE BUSINESS	3.0	90	TOTAL HRS	TBA	FULLONLN	Abril,M
<p>Note: 8 week class: 06/09 - 07/31 Note: Students must access this fully online class at www.collegeofthedesert.edu/ on or before June 9th, to begin the course.</p>								
<p><i>DDP 200 is an introduction to the law, policies, history, and foundations related to accessibility for persons with disabilities. Students will investigate the history, legal issues, and compliance of government laws 504, 508, ADA, and WCAG guidelines.</i></p>								
0824	DDP 200	ACCESSIBILITY COMPLIANCE	3.0	90	TOTAL HRS	TBA	FULLONLN	Cleveland,T
<p>Note: 8 week class: 06/09 - 07/31 Note: Students must access this fully online class at www.collegeofthedesert.edu/ on or before June 9th, to begin the course.</p>								
<p><i>DDP 202 is designed for people who want to learn or improve their skills with assistive learning technologies (ALT).</i></p>								
0826	DDP 202	ASSISTIVE TECH	3.0	90	TOTAL HRS	TBA	FULLONLN	STAFF
<p>Note: 8 week class: 06/09 - 07/31 Note: Students must access this fully online class at www.collegeofthedesert.edu/ on or before June 9th, to begin the course.</p>								
<p><i>DDP 095A, a work experience course of supervised employment is designed to assist students in developing transferable employability skills, career awareness, learning industry culture, competencies and norms, and developing professional networks that support career mobility. To enroll, students must have a job or internship placement in a part-time or full-time capacity and related to Digital Design and Production. Students must work 54 hours per unit enrolled. For hour/unit conversion and course details, visit the Work Experience webpage: www.collegeofthedesert.edu/workexperience. This work experience course of supervised employment meets four times during the semester (2 on-campus coaching sessions and 2 job-site visits). Required Application Form, syllabus, and course related information will be available via Canvas by the first day of each session.</i></p>								
0899	DDP 095A	DGTAL DSIGN/PROD WK EX 1.0				TBA	AD5	Abril,M
<p>Note: 8 week class: 06/09 - 07/31 For additional enrollment questions, contact the Work Experience office (760) 862-1344.</p>								

Disabled Students Programs & Services

DSPS 315 is designed to support new college students with disabilities master the skills required to be a successful college student. Some of the topics include basic college technology skills, navigating the college systems, self-advocacy, and resources for success.

Students receive a Pass/No Pass grade mark.

▶8834	DSPS 315	DSPS TRANSITION	0.0	09:00a-10:15a	MW	NDIOB302	Cambron,P
	Note: 8 week class: 06/09 - 07/30			18 TOTAL HRS	TBA	HYBRID	

Note: This is a hybrid online class that meets in person on Mondays and Wednesdays OFF-CAMPUS at the Indio Campus, 45524 Oasis Street. All remaining required hours will be asynchronous online in addition to homework assignments.

8836	DSPS 315	DSPS TRANSITION	0.0	09:00a-11:50a	TR	CSSC118	Navarro,J
	Note: 8 week class: 06/10 - 07/31						

Note: No class meetings June 19 and July 3

Drafting/CAD

DRA 011 covers the basic principles of 3-dimensional CAD modeling using SketchUp and Revit software.

Advisory: DRA 001 & CIS 010

0630	DRA 011	INTRO SKETCHUP/REVIT	3.0	02:00p-05:50p	TWR	AS105	Rivera,M
	Note: 8 week class: 06/10 - 07/31						

Note: No class meetings June 19 and July 3

Economics

ECON 001 is an introductory economics course focusing on aggregate economic analysis. Topics include economic growth, inflation, unemployment, macroeconomic equilibrium, monetary and fiscal policy, and international economics. Prerequisite: MATH 054 IGETC: 4B

0134	ECON 001	PRIN/MACROECONOMICS	3.0	54 TOTAL HRS	TBA	FULLONLN	Hamilton,M
	Note: 8 week class: 06/09 - 07/31						

Note: Students must access this fully online class at www.collegeofthedesert.edu/ on or before June 9th, to begin the course.

ECON 002 is an introductory economics course focusing on choices of individual economic decision-makers. Topics include scarcity, market equilibrium, elasticity, cost theory, market structures, and market failure. Prerequisite: MATH 054 IGETC: 4B

0156	ECON 002	PRIN/MICROECONOMICS	3.0	54 TOTAL HRS	TBA	FULLONLN	Hamilton,M
	Note: 8 week class: 06/09 - 07/31						

Note: Students must access this fully online class at www.collegeofthedesert.edu/ on or before June 9th, to begin the course.

Emergency Medical Responder

EMR 080, the Emergency Medical Responder course, prepares the EMR student to provide emergency prehospital assessment and care for patients of all ages with a variety of medical conditions and traumatic injuries. This course meets Title 22 regulations and National EMS Educational Standards. A \$12.50 fee is required for this course to cover the American Heart Association (AHA) Basic Life Support (BLS) certificate. Check the program website for additional information. Student must be 18 years of age by the last day of the course to sit for the NREMT national registry exam.

0182	EMR 080	EMR	3.0	04:00p-06:05p	MW	PSA18	Wilson,C
	Note: 8 week class: 06/09 - 07/31			04:00p-07:30p	TR	PSA18	Hughes,R Kang,S McEachen,R

Note: Students must attend a mandatory orientation on Thursday, May 29th, at 9:00am in room PSA 18. Students must provide uniforms and equipment. RSVP to attend the orientation by emailing chwilson@collegeofthedesert.edu. This course meets and exceeds California Title 22 requirements for Public Safety First Aid (PSFA). Students who complete the course will be eligible to take the National Registry Emergency Medical Responder examination. For further information, please refer to the College of the Desert website:

www.collegeofthedesert.edu/student/Academics/Prgrams/Publicsafetyacademy

Note: No class meetings June 19 and July 3

EMT 084 prepares students for National Registry of Emergency Medical Technicians (NREMT) EMT-Basic Written Examination. This course meets Title 22 Regulations, and Curriculum standards set forth by the local EMS Authority, State EMS Authority, and NREMT. Check the program website for additional information. Prerequisite: EMR 080, or EMR 080A and EMR 080B with a passing grade of B. Advisory: ENG 061, EMR 081, HS 062 Limitation on enrollment: Students must be eighteen (18) years of age on the first day of class. Students must have an American Heart Association BLS certification current through the end of the course. Students will need proof of a negative TB test or chest X-ray and will need to provide proof of titer. Have a current American Heart Association BLS Healthcare Provider certification valid until the last day of the semester.

College of the Desert Library

College of the Desert Library
Information Desk
(760) 773-2563
Reference Librarians
(760) 773-2560

Summer Hours
Monday – Thursday
8:00 a.m. - 6:00 p.m.
Friday Closed
Closed weekends, holidays
and when classes are not in
session.

Library Services and Resources

- 24/7 Ask a Librarian! Reference Chat
- Check out the Virtual Library & Student Resource Guide
- Electronic databases, eBooks
- Reference services and help for students doing research
- MLA and APA citation help
- Canvas Support
- Canvas and Zoom tutorials
- Collection supports the academic curriculum
- Online academic journals eBooks

Emergency Medical Responder

An Emergency Medical Responder (EMR) is an emergency responder trained to provide emergency medical care to the critically ill and injured. Depending on where they work, EMRs may be solely responsible for the treatment and transportation of their patients.



Student Computer Literacy and Access

One of the institutional outcomes for all COD students is technological literacy. As such, any class may be web enhanced and might require access to online sites such as Canvas, MyMathLab, MyLab, or the textbook publisher's website for assignments, testing, homework, etc. Internet-ready computers are available in a variety of locations, including the Tutoring and Academic Skills Center (TASC) and Library.

SECT	COURSE	TITLE	U	TIME	DAYS	BLDG/RM	INSTRUCTOR
0154	EMT 084	EMERGENCY MED TECH I	9.0	09:00a-01:05p	MW	PSA18	Wilson,C
		Note: 8 week class: 06/09 - 07/31		66 TOTAL HRS	TBA	HYBRID	Wilson,C
				09:00a-02:25p	TR	PSA18	Hughes,R Kang,S McEachen,R

Note: Students must attend a mandatory orientation on Thursday, May 29th, at 9:00 am in room PSA 18. Students must provide uniforms and equipment. RSVP to attend the orientation by emailing chwilson@collegeofthedesert.edu. This is an accelerated course with some lecture hours and all lab hours meeting face to face on campus, with the remaining lecture hours online. Students must access this hybrid online class via Canvas during the scheduled days/times.

Note: Students must email chwilson@collegeofthedesert.edu for the orientation packet prior to the start of the course. Students must be 18 year of age by the start date of this program, have a current American Heart Association Health Provider Certificate and have a social security number. Students must provide uniforms, background, proof of vaccinations and equipment. Attendance is mandatory; students not attending the first day of class will be dropped. This course meets and exceeds California Title 22 requirements for Emergency Medical Technician (EMT). Students who complete the course will receive an EMT certificate and be eligible to take the National Registry Emergency Medical Technician examination. For further information, please refer to the College of the Desert website: www.collegeofthedesert.edu/student/Academics/Prgrams/PublicSafetyAcademy.

Note: No class meetings June 19, July 3

English

ENG 001A focuses on the elements of academic writing, including genre, audience, purpose, and argumentation. Prerequisite: ENG 061 or ESL 071 IGETC: 1A
 Asynchronous online classes - Students must access these fully online classes at www.collegeofthedesert.edu/ on or before June 9th, to begin the course.

0121	ENG 001A	ENGLISH COMPOSITION	4.0	72 TOTAL HRS	TBA	FULLONLN	Camacho,K
		Note: 8 week class: 06/09 - 07/31					
0122	ENG 001A	ENGLISH COMPOSITION	4.0	72 TOTAL HRS	TBA	FULLONLN	Camacho,K
		Note: 8 week class: 06/09 - 07/31					
0135	ENG 001A	ENGLISH COMPOSITION	4.0	72 TOTAL HRS	TBA	FULLONLN	Wild,C
		Note: 8 week class: 06/09 - 07/31					
0144	ENG 001A	ENGLISH COMPOSITION	4.0	72 TOTAL HRS	TBA	FULLONLN	Nolan,R
		Note: 8 week class: 06/09 - 07/31					
0146	ENG 001A	ENGLISH COMPOSITION	4.0	72 TOTAL HRS	TBA	FULLONLN	Wild,C
		Note: 8 week class: 06/09 - 07/31					
0158	ENG 001A	ENGLISH COMPOSITION	4.0	72 TOTAL HRS	TBA	FULLONLN	Wild,C
		Note: 8 week class: 06/09 - 07/31					
0160	ENG 001A	ENGLISH COMPOSITION	4.0	72 TOTAL HRS	TBA	FULLONLN	Sanchez,H
		Note: 8 week class: 06/09 - 07/31					
0174	ENG 001A	ENGLISH COMPOSITION	4.0	72 TOTAL HRS	TBA	FULLONLN	Nolan,R
		Note: 8 week class: 06/09 - 07/31					
0194	ENG 001A	ENGLISH COMPOSITION	4.0	72 TOTAL HRS	TBA	FULLONLN	Camacho,K
		Note: 8 week class: 06/09 - 07/31					

ENG 002 emphasizes textual analysis and critical thinking skills through the study of literature. Prerequisite: ENG 001A IGETC: 1B, 3B
 Asynchronous online classes - Students must access these fully online classes at www.collegeofthedesert.edu/ on or before June 9th, to begin the course.

0228	ENG 002	ARG. WRIT. & CRIT. THKNG.	4.0	72 TOTAL HRS	TBA	FULLONLN	Sanchez,H
		Note: 8 week class: 06/09 - 07/31					
0230	ENG 002	ARG. WRIT. & CRIT. THKNG.	4.0	72 TOTAL HRS	TBA	FULLONLN	Sanchez,H
		Note: 8 week class: 06/09 - 07/31					
0234	ENG 002	ARG. WRIT. & CRIT. THKNG.	4.0	72 TOTAL HRS	TBA	FULLONLN	Gaydos,R
		Note: 8 week class: 06/09 - 07/31					
0279	ENG 002	ARG. WRIT. & CRIT. THKNG.	4.0	72 TOTAL HRS	TBA	FULLONLN	Gaydos,R
		Note: 8 week class: 06/09 - 07/31					
0298	ENG 002	ARG. WRIT. & CRIT. THKNG.	4.0	72 TOTAL HRS	TBA	FULLONLN	Gaydos,R
		Note: 8 week class: 06/09 - 07/31					

ENG 014 is a study of selected histories, comedies, tragedies, and poetry of William Shakespeare. Prerequisite: ENG-001A IGETC: 3B

0208	ENG 014	SHAKESPEARE.	3.0	54 TOTAL HRS	TBA	FULLONLN	Spencer,A
		Note: 8 week class: 06/09 - 07/31					
		Note: Students must access this fully online class at www.collegeofthedesert.edu/ on or before June 9th, to begin the course.					

ENG 300 prepares incoming college students for the rigors of college-level reading and writing, and college-level English courses specifically. Students will learn and/or review the academic norms that lead to academic success and some foundational essay-writing concepts. Students receive a Pass/No Pass grade mark,

9301 ENG 300 ENGLISH EDGE 0.0 09:00a-10:50a MW COM205 Whatford,J
Note: 3 week class: 06/09 - 06/26 12 TOTAL HRS TBA HYBRID

Note: This is a hybrid class with in person meetings on the Palm Desert campus on Mondays and Wednesdays. All required remaining hours will be online in addition to homework assignments.

9303 ENG 300 ENGLISH EDGE 0.0 09:00a-10:50a TR COM205 Whatford,J
Note: 3 week class: 06/09 - 06/26 12 TOTAL HRS TBA HYBRID

Note: This is a hybrid class with in person meetings on the Palm Desert campus on Tuesdays and Thursdays. All required remaining hours will be online in addition to homework assignments.
 Note: No class meeting June 19

9309 ENG 300 ENGLISH EDGE 0.0 11:00a-12:50p TR COM205 Hernandez,M
Note: 3 week class: 06/09 - 06/26 12 TOTAL HRS TBA HYBRID

Note: This is a hybrid class with in person meetings on the Palm Desert campus on Tuesdays and Thursdays. All required remaining hours will be online in addition to homework assignments.
 Note: No class meeting June 19

9343 ENG 300 ENGLISH EDGE 0.0 09:00a-10:50a TR COM205 Whatford,J
Note: 3 week class: 06/30 - 07/17 12 TOTAL HRS TBA HYBRID

Note: This is a hybrid class with in person meetings on the Palm Desert campus on Tuesdays and Thursdays. All required remaining hours will be online in addition to homework assignments.
 Note: No class meeting July 3

9341 ENG 300 ENGLISH EDGE 0.0 11:00a-12:50p TR COM205 McKowan,C
Note: 3 week class: 06/30 - 07/17 12 TOTAL HRS TBA HYBRID

Note: This is a hybrid class with in person meetings on the Palm Desert campus on Tuesdays and Thursdays. All required remaining hours will be online in addition to homework assignments.
 Note: No class meeting July 3

9501 ENG 300 ENGLISH EDGE 0.0 09:00a-10:50a TR COM206 Hernandez,M
Note: 3 week class: 07/21 - 08/07 12 TOTAL HRS TBA HYBRID

Note: This is a hybrid class with in person meetings on the Palm Desert campus on Tuesdays and Thursdays. All required remaining hours will be online in addition to homework assignments.

9511 ENG 300 ENGLISH EDGE 0.0 09:00a-10:50a TR COM205 Higgs,C
Note: 3 week class: 07/21 - 08/07 12 TOTAL HRS TBA HYBRID

Note: This is a hybrid class with in person meetings on the Palm Desert campus on Tuesdays and Thursdays. All required remaining hours will be online in addition to homework assignments.

9513 ENG 300 ENGLISH EDGE 0.0 11:00a-12:50p TR COM205 Mata,C
Note: 3 week class: 07/21 - 08/07 12 TOTAL HRS TBA HYBRID

Note: This is a hybrid class with in person meetings on the Palm Desert campus on Tuesdays and Thursdays. All required remaining hours will be online in addition to homework assignments.

East Valley site (NDIO) - Students at off-campus sites should allow sufficient travel time to arrive on time and remain for the duration of the class. Non-Participation and excessive absences may be grounds for being dropped from a course.

▶9321 ENG 300 ENGLISH EDGE 0.0 09:00a-10:50a TR NDI0B226 Spence,C
Note: 3 week class: 06/09 - 06/26 12 TOTAL HRS TBA HYBRID

Note: This is a hybrid class with in person meetings on Tuesdays and Thursdays. All required remaining hours will be online in addition to homework assignments.
 Note: No class meeting June 19

▶9329 ENG 300 ENGLISH EDGE 0.0 05:00p-06:50p TR NDI0B226 Hernandez,M
Note: 3 week class: 06/09 - 06/26 12 TOTAL HRS TBA HYBRID

Note: This is a hybrid class with in person meetings on Tuesdays and Thursdays. All required remaining hours will be online in addition to homework assignments.
 Note: No class meeting June 19

▶9345 ENG 300 ENGLISH EDGE 0.0 09:00a-10:50a MW NDI0B226 Rivera,J
Note: 3 week class: 06/30 - 07/17 12 TOTAL HRS TBA HYBRID

Note: This is a hybrid class with in person meetings on Mondays and Wednesdays. All required remaining hours will be online in addition to homework assignments.

▶9561 ENG 300 ENGLISH EDGE 0.0 09:00a-10:50a MW NDI0B226 Rivera,J
Note: 3 week class: 07/21 - 08/07 12 TOTAL HRS TBA HYBRID

Note: This is a hybrid class with in person meetings on Mondays and Wednesdays. All required remaining hours will be online in addition to homework assignments.

▶9563 ENG 300 ENGLISH EDGE 0.0 11:00a-12:50p MW NDI0B226 McKowan,C
Note: 3 week class: 07/21 - 08/07 12 TOTAL HRS TBA HYBRID

Note: This is a hybrid class with in person meetings on Mondays and Wednesdays. All required remaining hours will be online in addition to homework assignments.



The pEDGE program provides 2025 high school graduates (or equivalent) from the Coachella Valley with two full years of tuition and fees at College of the Desert!

Participating students will complete at least one EDGE non-credit course to prepare for college and college-level coursework or a credit summer course to be eligible for pEDGE.

EDGE non-credit courses: English EDGE (ENG-300), Math/Statistics EDGE (MATH-300 or SOC-300), or Student Development EDGE (COUN-300).

Students must also have a completed Financial Aid file, commit to full time enrollment, maintain good academic standing and participate in career preparation and community service. For more information, please contact the pEDGE office at (760) 636-7970 or edge@collegeofthedesert.edu

26 ENGL - ESLN

Adult Basic Education (ABE) and English As A Second Language (ESLN) Registration

Registration for new/continuing ABE students will begin on 4/15/2025.

English As A Second Language (ESLN) Registration:

Registration for new and continuing students will begin on 04/15/2025.

Please visit the College of the Desert Admissions webpage and click on the Adult Basic Education Registration link or the English As A Second Language link for details.

English As A Second Language Non-Credit (ESLN)

All registered ESLN students have access to the Language Lab, which provides a variety of invaluable resources to supplement, reinforce, practice and further develop the language skills taught in the classroom.

The Language Lab is part of the Tutoring & Academic Skills Center
Phone: (760) 773-2557
for Summer hours.

SECT	COURSE	TITLE	U	TIME	DAYS	BLDG/RM	INSTRUCTOR
Asynchronous online classes - Students must access these fully online classes at www.collegeofthedesert.edu/ on or before the start date of the class, to begin the course.							
9331	ENG 300	ENGLISH EDGE	0.0	24 TOTAL HRS	TBA	FULLONLN	Gaydos,R
		Note: 3 week class: 06/09 - 06/26					
9333	ENG 300	ENGLISH EDGE	0.0	24 TOTAL HRS	TBA	FULLONLN	Gaydos,R
		Note: 3 week class: 06/09 - 06/26					
9335	ENG 300	ENGLISH EDGE	0.0	24 TOTAL HRS	TBA	FULLONLN	Camacho,K
		Note: 3 week class: 06/09 - 06/26					
9337	ENG 300	ENGLISH EDGE	0.0	24 TOTAL HRS	TBA	FULLONLN	Wild,C
		Note: 3 week class: 06/09 - 06/26					
9355	ENG 300	ENGLISH EDGE	0.0	24 TOTAL HRS	TBA	FULLONLN	Wild,C
		Note: 3 week class: 06/30 - 07/17					
9357	ENG 300	ENGLISH EDGE	0.0	24 TOTAL HRS	TBA	FULLONLN	Camacho,K
		Note: 3 week class: 06/30 - 07/17					
9359	ENG 300	ENGLISH EDGE	0.0	24 TOTAL HRS	TBA	FULLONLN	Camacho,K
		Note: 3 week class: 06/30 - 07/17					
9521	ENG 300	ENGLISH EDGE	0.0	24 TOTAL HRS	TBA	FULLONLN	Gaydos,R
		Note: 3 week class: 07/21 - 08/07					
9525	ENG 300	ENGLISH EDGE	0.0	24 TOTAL HRS	TBA	FULLONLN	Gaydos,R
		Note: 3 week class: 07/21 - 08/07					
9527	ENG 300	ENGLISH EDGE	0.0	24 TOTAL HRS	TBA	FULLONLN	Wild,C
		Note: 3 week class: 07/21 - 08/07					
9531	ENG 300	ENGLISH EDGE	0.0	24 TOTAL HRS	TBA	FULLONLN	Camacho,K
		Note: 3 week class: 07/21 - 08/07					
9535	ENG 300	ENGLISH EDGE	0.0	24 TOTAL HRS	TBA	FULLONLN	Spence,C
		Note: 3 week class: 07/21 - 08/07					
9537	ENG 300	ENGLISH EDGE	0.0	24 TOTAL HRS	TBA	FULLONLN	Spence,C
		Note: 3 week class: 07/21 - 08/07					
9539	ENG 300	ENGLISH EDGE	0.0	24 TOTAL HRS	TBA	FULLONLN	Gaydos,R
		Note: 2 week class: 07/28 - 08/07					
Note: Section 9539 is a DEMAND CLASS and may open for enrollment when other sections have filled.							

English As A Second Language - Noncredit

Note: ESLN classes are 8 weeks starting June 9th and ending July 31st. Some classes are taught on TechConnect Zoom with assignments completed on Canvas, other sections meet in person. Students receive a Pass/No Pass grade mark.

ESLN 387A is the foundations-level vocabulary and beginning conversation practice using learned vocabulary on everyday life topics.

7936 ESLN 387A ESL - CONVERSATION BEG 0.0 09:00a-10:50a MTWR COM211 Davenport,L
7988 ESLN 387A ESL - CONVERSATION BEG 0.0 09:00a-10:50a MTWR CNVSZOOM Cruz Santoyo,M

Note: This online class meets on TechConnect Zoom from 9:00am to 10:50am MTWR and assignments are completed on Canvas.

7952 ESLN 387A ESL - CONVERSATION BEG 0.0 06:00p-07:50p MTWR CNVSZOOM Cruz Santoyo,M
Note: This online class meets on TechConnect Zoom from 6:00pm to 7:50pm MTWR and assignments are completed on Canvas.

► **7948 ESLN 387A ESL - CONVERSATION BEG 0.0 06:00p-07:50p MTWR NDI0B227 Camacho,A**
Note: This OFF-CAMPUS CLASS meets at the Indio Campus, 45524 Oasis Street.

ESLN 388A is the low beginning conversation practice using learned vocabulary on everyday life topics.

Prerequisite: ESLN 387A, or appropriate ESLN Placement Test, or Instructor recommendation

7934 ESLN 388A ESL - CONVERSATION I 0.0 09:00a-10:50a MTWR COM212 Mitchell,R
7754 ESLN 388A ESL - CONVERSATION I 0.0 09:00a-10:50a MTWR CNVSZOOM Camacho,A

Note: This online class meets on TechConnect Zoom from 9:00am to 10:50am MTWR and assignments are completed on Canvas.

7938 ESLN 388A ESL - CONVERSATION I 0.0 06:00p-07:50p MTWR CNVSZOOM Davenport,L
Note: This online class meets on TechConnect Zoom from 6:00pm to 7:50pm MTWR and assignments are completed on Canvas.

► **7954 ESLN 388A ESL - CONVERSATION I 0.0 06:00p-07:50p MTWR NDI0B225 Church,M**
Note: This OFF-CAMPUS CLASS meets at the Indio Campus, 45524 Oasis Street.

ESLN 388B is the high beginning conversation practice using learned vocabulary on everyday life topics.

Prerequisite: ESLN 388A, or appropriate ESLN Placement Test score, or Instructor recommendation

7914 ESLN 388B ESL - CONVERSATION II 0.0 09:00a-10:50a MTWR COM111 Holster,M
7716 ESLN 388B ESL - CONVERSATION II 0.0 09:00a-10:50a MTWR CNVSZOOM Barahona,E

Note: This online class meets on TechConnect Zoom from 9:00am to 10:50am MTWR and assignments are completed on Canvas.

SECT	COURSE	TITLE	U	TIME	DAYS	BLDG/RM	INSTRUCTOR
------	--------	-------	---	------	------	---------	------------

ESLN - ETHN 27

7768	ESLN 388B ESL - CONVERSATION II	0.0	06:00p-07:50p	MTWR	CNVSZOOM	Bota Trachtenberg,N	
Note: This online class meets on TechConnect Zoom from 6:00pm to 7:50pm MTWR and assignments are completed on Canvas.							
▶7984	ESLN 388B ESL - CONVERSATION II	0.0	06:00p-07:50p	MTWR	NDIOB230		Holster,M
Note: This OFF-CAMPUS CLASS meets at the Indio Campus, 45524 Oasis Street.							

ESLN 388C is the low intermediate conversation practice using learned vocabulary on everyday life topics.

Prerequisite: ESLN 388B, or appropriate ESLN Placement Test score, or Instructor recommendation

7912	ESLN 388C ESL - CONVERSATION III	0.0	09:00a-10:50a	MTWR	COM109		Gonzalez,S
7714	ESLN 388C ESL - CONVERSATION III	0.0	09:00a-10:50a	MTWR	CNVSZOOM		Gichev,I
Note: This online class meets on TechConnect Zoom from 9:00am to 10:50am MTWR and assignments are completed on Canvas.							

7718	ESLN 388C ESL - CONVERSATION III	0.0	06:00p-07:50p	MTWR	CNVSZOOM		Sifter,M
Note: This online class meets on TechConnect Zoom from 6:00pm to 7:50pm MTWR and assignments are completed on Canvas.							

▶7992	ESLN 388C ESL - CONVERSATION III	0.0	06:00p-07:50p	MTWR	NDIOB228		Lua,A
Note: This OFF-CAMPUS CLASS meets at the Indio Campus, 45524 Oasis Street.							

ESLN 388D is the high intermediate conversation practice using learned vocabulary in a variety of situations.

Prerequisite: ESLN 388C, or appropriate ESLN Placement Test score, or Instructor recommendation

7738	ESLN 388D ESL - CONVERSATION IV	0.0	09:00a-10:50a	MTWR	COM112		Hummer,K
7758	ESLN 388D ESL - CONVERSATION IV	0.0	09:00a-10:50a	MTWR	CNVSZOOM		Mayo,J
Note: This online class meets on TechConnect Zoom from 9:00am to 10:50am MTWR and assignments are completed on Canvas.							

7776	ESLN 388D ESL - CONVERSATION IV	0.0	06:00p-07:50p	MTWR	CNVSZOOM		Munjal,M
Note: This online class meets on TechConnect Zoom from 6:00pm to 7:50pm MTWR and assignments are completed on Canvas.							

▶7782	ESLN 388D ESL - CONVERSATION IV	0.0	06:00p-07:50p	MTWR	NDIOB329		Hummer,K
Note: This OFF-CAMPUS CLASS meets at the Indio Campus, 45524 Oasis Street.							

ESLN 389A is a noncredit course for ESL students focusing on computer terminology, basic computer technology, and developing language skills using a computer. *Prerequisite:* ESLN 310C, or appropriate ESLN Placement Test, or Instructor recommendation

7734	ESLN 389A ESL - INTRO COMPUTER	0.0	11:00a-12:50p	MTWR	COM106		Dodough,C
------	--------------------------------	-----	---------------	------	--------	--	-----------

ESLN 390A is a noncredit high-beginning course focusing on Standard American English pronunciation, word stress and intonation, and vocabulary building. *Prerequisite:* ESLN 310A, or appropriate ESLN Placement Test, or Instructor recommendation.

7904	ESLN 390A ESL-PRONOUNCE/VOCAB	0.0	11:00a-12:20p	MTWR	COM109		Holster,M
7923	ESLN 390A ESL-PRONOUNCE/VOCAB	0.0	11:00a-12:20p	MTWR	COM211		Church,M
7982	ESLN 390A ESL-PRONOUNCE/VOCAB	0.0	11:00a-12:20p	MTWR	CNVSZOOM		Item,S
Note: This online class meets on TechConnect Zoom from 11:00am to 12:20pm MTWR and assignments are completed on Canvas.							

ESLN 390B is a noncredit high intermediate course focusing on Standard American English pronunciation, word stress and intonation, and vocabulary building. Students receive a Pass/No Pass grade mark. *Prerequisite:* ESLN 310C, or ESLN 390A, or appropriate ESLN Placement Test, or Instructor recommendation

7986	ESLN 390B ESL-PRONOUNCE/VOCAB	0.0	11:00a-12:20p	MTWR	CNVSZOOM		Mayo,J
Note: This online class meets on TechConnect Zoom from 11:00am to 12:20pm MTWR and assignments are completed on Canvas.							

Ethnic Studies

ETHN 001 is an introductory course for a comparative and interdisciplinary examination of the experiences of Black, Native American and People of Color in the United States from the colonial era to today.

Advisory: ENG 001A

Asynchronous online classes - Students must access these fully online classes at

www.collegeofthedesert.edu/ on or before June 9th, to begin the course.

0641	ETHN 001 INTRO TO ETHNIC STUDIES	3.0	54 TOTAL HRS	TBA	FULLONLN		Kone,M
Note: 6 week class: 06/09 - 07/17							
0643	ETHN 001 INTRO TO ETHNIC STUDIES	3.0	54 TOTAL HRS	TBA	FULLONLN		Kone,M
Note: 6 week class: 06/09 - 07/17							
0648	ETHN 001 INTRO TO ETHNIC STUDIES	3.0	54 TOTAL HRS	TBA	FULLONLN		Kone,M
Note: 6 week class: 06/09 - 07/17							
0656	ETHN 001 INTRO TO ETHNIC STUDIES	3.0	54 TOTAL HRS	TBA	FULLONLN		Kone,M
Note: 6 week class: 06/09 - 07/17							

PUBLIC SAFETY 760 341-2111 or EXT 2111

24 Hour Service located in South Annex 16 (south west corner of the COD campus, near the McCallum Theater).

Public Safety officers are on duty 24 hours a day, 7 days a week. If you need assistance or wish to report a crime, please call the Public Safety number. On campus call 2111, off campus or on a cell phone, call (760) 341-2111. The office is located in the South Annex, room 16. If the office is locked, you may contact the on duty Public Safety Officer via phone or by using the call box next to the office door. If you press the call button, it will call the on duty officer via their cell phone.

If an emergency exists that is severe or life threatening, call (911), then the Public Safety Department. If you have questions about the Public Safety Department, stop in the office and your questions can be answered.

Summer classes are being held in person, synchronously via Canvas, or asynchronously. Synchronous meetings occur at the same time and day as designated in this class schedule. Be sure to check the start and end date, and drop deadlines that apply to each class you select.

Ethnic Studies

Ethnic Studies is the interdisciplinary study of race and racism utilizing intersectional, comparative, relational, and transnational approaches that focus on the histories, experiences, cultures, and struggles of historically minoritized ethno-racial groups in the United States.

The field focuses primarily on Indigenous/Native American studies, Black/African American studies, Latinx/Chicanx studies, and Asian American/Pacific Islander studies, while also engaging in analysis of other racialized ethnic groups in the U.S.

Ethnic Studies also investigates how race and ethnicity intersect with class, gender, ability, and sexuality in order to help students develop a critical understanding of the complex and intersecting historical struggles and movements for social transformation, resistance, and liberation in the U.S. and beyond.

>>Check <<
the start-date
end-date &
drop deadlines
that apply to each
class you select

SECT	COURSE	TITLE	U	TIME	DAYS	BLDG/RM	INSTRUCTOR
0631	ETHN 001	INTRO TO ETHNIC STUDIES	3.0	54 TOTAL HRS	TBA	FULLONLN	McClinton,M
		Note: 8 week class: 06/09 - 07/31					
0639	ETHN 001	INTRO TO ETHNIC STUDIES	3.0	54 TOTAL HRS	TBA	FULLONLN	McClinton,M
		Note: 8 week class: 06/09 - 07/31					
<p>ETHN 002 explores the interdisciplinary and comparative field of Chicanx and Latinx studies and the Chicanx/Latinx experience with emphasis on the cultural and historical development, and the socioeconomic and political status of their contemporary communities in the United States. Advisory: ENG 001A & ETHN 001 Asynchronous online classes - Students must access these fully online classes at www.collegeofthedesert.edu/ on or before June 9th, to begin the course.</p>							
0819	ETHN 002	INTRO TO CHIC/LAT STUDIES	3.0	54 TOTAL HRS	TBA	FULLONLN	Ramirez,A
		Note: 6 week class: 06/09 - 07/17					
0823	ETHN 002	INTRO TO CHIC/LAT STUDIES	3.0	54 TOTAL HRS	TBA	FULLONLN	Ramirez,A
		Note: 6 week class: 06/09 - 07/17					
0827	ETHN 002	INTRO TO CHIC/LAT STUDIES	3.0	54 TOTAL HRS	TBA	FULLONLN	Ramirez,A
		Note: 6 week class: 06/09 - 07/17					
0829	ETHN 002	INTRO TO CHIC/LAT STUDIES	3.0	54 TOTAL HRS	TBA	FULLONLN	Ramirez,A
		Note: 6 week class: 06/09 - 07/17					
<p>ETHN 003 is a survey course introducing the methods, theories, conceptual frameworks, and key debates in Black studies. The identity and meaning of Blackness in relation to class, gender, and sexuality and essential role of African people in development of capitalism, liberalism, and democracy will be covered. Advisory ENG 001A & ETHN 001.</p>							
0649	ETHN 003	INTRO TO BLACK STUDIES	3.0	54 TOTAL HRS	TBA	FULLONLN	McClinton,M
		Note: 8 week class: 06/09 - 07/31 Note: Students must access this fully online class at www.collegeofthedesert.edu/ on or before June 9th, to begin the course.					
<p>ETHN 004 is an introduction to the interdisciplinary field of Native American Studies. It is designed to acquaint students with the most significant social, political, religious, and artistic aspects of various Native American peoples of North America within a transnational context, focusing on the twentieth century to the present. Advisory: ENG 001A & ETHN 001 Asynchronous online classes - Students must access these fully online classes at www.collegeofthedesert.edu/ on or before June 9th, to begin the course.</p>							
0664	ETHN 004	NATIVE AMERICAN STUDIES	3.0	54 TOTAL HRS	TBA	FULLONLN	Montoya,D
		Note: 8 week class: 06/09 - 07/31					
0667	ETHN 004	NATIVE AMERICAN STUDIES	3.0	54 TOTAL HRS	TBA	FULLONLN	Montoya,D
		Note: 8 week class: 06/09 - 07/31					
0674	ETHN 004	NATIVE AMERICAN STUDIES	3.0	54 TOTAL HRS	TBA	FULLONLN	Montoya,D
		Note: 8 week class: 06/09 - 07/31					
0832	ETHN 004	NATIVE AMERICAN STUDIES	3.0	54 TOTAL HRS	TBA	FULLONLN	Montoya,D
		Note: 8 week class: 06/09 - 07/31					
<p>ETHN 005 is an interdisciplinary field of study that explores historical and contemporary Asian American political, social, economic issues, and cultural practices and experiences in the United States. This course examines the foundations of and contemporary approaches to Asian Americans, with emphasis placed on the processes of colonialism, migration and exclusion; issues of citizenship; racial and ethnic identity formation; practices of resistance; work and labor relations; acculturation, family and community formation; transnational networks; and, representations of Asian Americans. The represented groups and communities include Chinese, Japanese, Koreans, Filipinos, South Asians, and Southeast Asians. Advisory: ENG 001A & ETHN 001. Asynchronous online classes - Students must access these fully online classes at www.collegeofthedesert.edu/ on or before June 9th, to begin the course.</p>							
0677	ETHN 005	INTRO TO ASIAN AM STUDIES	3.0	54 TOTAL HRS	TBA	FULLONLN	Tanaka,T
		Note: 8 week class: 06/09 - 07/31					
0682	ETHN 005	INTRO TO ASIAN AM STUDIES	3.0	54 TOTAL HRS	TBA	FULLONLN	Tanaka,T
		Note: 8 week class: 06/09 - 07/31					
0695	ETHN 005	INTRO TO ASIAN AM STUDIES	3.0	54 TOTAL HRS	TBA	FULLONLN	Tanaka,T
		Note: 6 week class: 06/09 - 07/17					

Film

FILM 001 explores the powerful impact film has on us, and the techniques filmmakers use to make us respond. IGETC: 3A

Asynchronous online classes - Students must access these fully online classes at www.collegeofthedesert.edu/ on or before June 9th, to begin the course.

0635	FILM 001	INTRO TO FILM	3.0	54 TOTAL HRS	TBA	FULLONLN	Gladych,M
Note: 8 week class: 06/09 - 07/31							
0692	FILM 001	INTRO TO FILM	3.0	54 TOTAL HRS	TBA	FULLONLN	Gladych,M
Note: 8 week class: 06/09 - 07/31							
0673	FILM 001	INTRO TO FILM	3.0	54 TOTAL HRS	TBA	FULLONLN	STAFF
Note: 6 week class: 06/09 - 07/17							
Note: Section 0673 is a DEMAND CLASS and may open for enrollment when other sections have filled.							

Finance

BUFI 013 is designed to make students familiar with a wide range of investment instruments including stocks, bonds, mutual funds and real estate. Students may choose the Pass/No Pass grading option.

0191	BUFI 013	INVTMNT OPPRTUNTIES	3.0	90 TOTAL HRS	TBA	FULLONLN	Romero,J
Note: 6 week class: 06/09 - 07/17							
Note: Students must access this fully online class at www.collegeofthedesert.edu/ on or before June 9th, to begin the course.							

Fire Technology

FIRE 001 provides: an overview to fire protection and emergency services; career opportunities in fire protection and related fields; culture and history of emergency services. This course meets the Fire and Emergency Service Higher Education (FESHE) model curriculum for an Associates Degree as recognized by the National Fire Academy. Advisory: ENG 001A

0651	FIRE 001	PRINC EMRGNCY SERVC	3.0	54 TOTAL HRS	TBA	FULLONLN	Ventura,A
Note: 8 week class: 06/09 - 07/31							
Note: Students must access this fully online class at www.collegeofthedesert.edu/ on or before June 9th, to begin the course.							

California State Fire Marshal

CSFM 084A provides the skills and knowledge needed for the entry level professional instructor to perform his or her duties safely, effectively, and competently. The curriculum is based on the 2012 edition of NFPA 1041 (Standard for Fire Service Instructor Professional Qualifications). At the end of this course, candidates for Instructor I certification will be able to teach and deliver instruction from a prepared lesson plan utilizing instructional aids and evaluation instruments. The Instructor I will also be able to adapt a lesson plan and complete the reporting requirements to the local jurisdiction. Upon successful completion of the course, a CSFM diploma fee of \$140 is required for this course to cover the California State Fire Training Certificate of Completion. Students receive a Pass/No Pass grade mark.

0681	CSFM 084A	INSTRUCTOR 1	2.0	08:00a-11:50a	MTWRF	CNVSZOOM	Brakebill,J
Note: 1 week class: 07/14 - 07/18							
Note: This a synchronous online class. Students must access this fully online class via Canvas during the scheduled days/times.							

Geography

GEOG 001 examines the major features of the natural environment including land, water, air and life forms. IGETC: 5A

Asynchronous online classes - Students must access these fully online classes at www.collegeofthedesert.edu/ on or before June 9th, to begin the course.

0614	GEOG 001	PHYSICAL GEOGRAPHY	3.0	54 TOTAL HRS	TBA	FULLONLN	deGrassi,A
Note: 6 week class: 06/09 - 07/17							
0618	GEOG 001	PHYSICAL GEOGRAPHY	3.0	54 TOTAL HRS	TBA	FULLONLN	deGrassi,A
Note: 6 week class: 06/09 - 07/17							

Geology

G 001, Physical Geology, serves as an introduction to the field for majors and those looking to fulfill their general education requirement. Subject matter for this course includes Earth materials and processes such as minerals, rocks, plate tectonics, earthquakes, and volcanoes.

Advisory: ENG 001A & MATH 054 IGETC: 5A, 5C

0657	G 001	PHYSICAL GEOLOGY	4.0	10:00a-02:15p	MW	LA9B	Burns,R
Note: 6 week class: 06/09 - 07/17							
Note: No class meetings June 19 and July 3							

Watch for the new
Common Course
Numbering
in
Fall 2025

California Community Colleges, including College of the Desert, are adopting a system that assigns the same course number to comparable courses across all California Community Colleges to streamline transfer for students.

Starting Fall 2025, several Common Course Numbering (CCN) courses will be offered for general education. These courses will have a new course code, number and subject:

- COMM 001 will become **COMM C1000**
- ENG 001A will become **ENGL C1000**
- ENG 001X will become **ENGL C1000E**
- ENG 003 will become **ENGL C1001**
- MATH 014 will become **STAT C1000**
- PS 001 will become **POLS C1000**
- PSY 001 will become **PSYC 1000**

General Nutrition

HS-013

General Nutrition is a study of the chemical composition of foods and how the body utilizes those foods. How does good nutrition and diet relate to physical and mental health? These are just some of the topics covered. Students learn valuable consumer information, including how to read food labels and use the USDA Food Guide. Students will explore personal lifestyle habits and evaluate how closely they meet the newest Dietary Guidelines for Americans.

General Nutrition is a class you can't live healthy without taking.

Offered in person and asynchronously online.

CRIMINAL BACKGROUND CHECK REQUIREMENT

College of the Desert Health Sciences courses with patient care contact in a JCAHO accredited facility require criminal background checks of enrolled students. This is a national standard for health care facilities designed to protect the health and safety of its patient population. The student shall be responsible for paying a criminal background check fee at registration. A Social Security number is required.

SECT	COURSE	TITLE	U	TIME	DAYS	BLDG/RM	INSTRUCTOR
------	--------	-------	---	------	------	---------	------------

Health Sciences

HS 013 is a study of the chemical composition of foods and their utilization by the body. Practical problems of nutrition and relationship of adequate diet to fitness, energy balance, disease risk, and lifespan.

Advisory: ENG 061

0324 HS 013 GENERAL NUTRITION 3.0 06:00p-09:05p MW N6 Avina,R
Note: 8 week class: 06/09 - 07/30

Asynchronous online classes - Students must access these fully online classes at www.collegeofthedesert.edu/ on or before June 9th, to begin the course.

0306 HS 013 GENERAL NUTRITION 3.0 54 TOTAL HRS TBA FULLONLN Casas,A

Note: 8 week class: 06/09 - 07/31

0312 HS 013 GENERAL NUTRITION 3.0 54 TOTAL HRS TBA FULLONLN Casas,A

Note: 8 week class: 06/09 - 07/31

0314 HS 013 GENERAL NUTRITION 3.0 54 TOTAL HRS TBA FULLONLN Kelsey,M

Note: 8 week class: 06/09 - 07/31

0316 HS 013 GENERAL NUTRITION 3.0 54 TOTAL HRS TBA FULLONLN Kelsey,M

Note: 8 week class: 06/09 - 07/31

0318 HS 013 GENERAL NUTRITION 3.0 54 TOTAL HRS TBA FULLONLN Casas,A

Note: 8 week class: 06/09 - 07/31

HS 061 introduces medical terminology as used by all health service personnel, including medical doctors, dentists, nurses, respiratory therapists, physical therapists, EMTs, medical secretaries and doctors' office assistants. Advisory: ENG 061

0322 HS 061 MEDICAL TERMINOLOGY 3.0 09:00a-12:30p TR N6 Spurgin,K

Note: 8 week class: 06/10 - 07/31

Note: No class meetings June 19 and July 3

HS 062 provides a basic knowledge and overview of body structures and its functions, correlated with discussion of the major diseases affecting each of the major systems. Advisory: HS 061 & ENG 061

0328 HS 062 YOUR LIVING BODY 3.0 05:00p-08:30p WR N4 STAFF

Note: 8 week class: 06/11 - 07/31

Note: No class meetings June 19 and July 3

HS 065 is an introductory level course providing an overview of underlying disease processes in health care settings, and their associated drug therapies to reach therapeutic goals. Advisory: BI 004

Asynchronous online classes - Students must access these fully online classes at www.collegeofthedesert.edu/ on or before June 9th, to begin the course.

0304 HS 065 BASIC PHARMACOLOGY 3.0 54 TOTAL HRS TBA FULLONLN Wong,C

Note: 8 week class: 06/09 - 07/31

0396 HS 065 BASIC PHARMACOLOGY 3.0 54 TOTAL HRS TBA FULLONLN Wong,C

Note: 8 week class: 06/09 - 07/31

HS 067 is designed for those interested in health care professions. It covers the general principles of drug administration with a review of arithmetic and the calculation of math dosages.

Advisory: MATH 060 & ENG 061

0338 HS 067 INTRO MED/DOSAGE CALC 1.0 01:00p-03:05p T N6 Spurgin,K

Note: 8 week class: 06/10 - 07/29

0345 HS 067 INTRO MED/DOSAGE CALC 1.0 04:00p-06:05p T N6 Spurgin,K

Note: 8 week class: 06/10 - 07/29

0362 HS 067 INTRO MED/DOSAGE CALC 1.0 01:00p-03:50p R N6 Spurgin,K

Note: 8 week class: 06/12 - 07/31

Note: No class meetings June 19 and July 3

HS 080 teaches students the basics of interpretation of cardiac heart rhythms and performing a 12 lead ECG. It is appropriate for students who are interested in applying for jobs in hospitals or doctors offices, as well as for students interested in careers in health care.

0366 HS 080 ECG INTERPRETATION 3.0 03:00p-06:30p TR N8 Castillo,M

Note: 8 week class: 06/10 - 07/31

Note: No class meetings June 19 and July 3

HS 300 guides the enrolled student to develop competence and confidence in the performance of nursing skills, through repetition and with instructor support, at times convenient to the learner. Students receive a Pass grade with a minimum of 1 hour spent in the laboratory and a maximum of 54 hours. Limitation on Enrollment: Acceptance and enrollment in a nursing or health science program (HHA, CNA, LVN, RN)

0300 HS 300 NURSING SKILLS LAB 0.0 54 TOTAL HRS TBA BNC39 STAFF

Note: 8 week class: 06/09 - 07/31

History

HIST 003 is an overview of major ancient world civilizations and religions in a comparative context.

Advisory: ENG 001A IGETC: 3B, 4F

[Asynchronous online classes - Students must access these fully online classes at www.collegeofthedesert.edu/ on or before June 9th, to begin the course.](http://www.collegeofthedesert.edu/)

0636	HIST 003	HISTORY/WORLD CIV I	3.0	54 TOTAL HRS	TBA	FULLONLN	Benavides,E
------	----------	---------------------	-----	--------------	-----	----------	-------------

Note: 6 week class: 06/09 - 07/17

0694	HIST 003	HISTORY/WORLD CIV I	3.0	54 TOTAL HRS	TBA	FULLONLN	Benavides,E
------	----------	---------------------	-----	--------------	-----	----------	-------------

Note: 6 week class: 06/09 - 07/17

HIST 017 is a survey of the political and social development of the United States from the discovery of America through the Reconstruction Period. Advisory: ENG 001A IGETC: 3B, 4F

0620	HIST 017	U.S.HISTORY	3.0	10:00a-12:10p	MTWR	SOC8	Hanes,W
------	----------	-------------	-----	---------------	------	------	---------

Note: 6 week class: 06/09 - 07/17

Note: No class meetings June 19 and July 3

[Asynchronous online classes - Students must access these fully online classes at www.collegeofthedesert.edu/ on or before June 9th, to begin the course.](http://www.collegeofthedesert.edu/)

0668	HIST 017	U.S.HISTORY	3.0	54 TOTAL HRS	TBA	FULLONLN	Benavides,E
------	----------	-------------	-----	--------------	-----	----------	-------------

Note: 6 week class: 06/09 - 07/17

0698	HIST 017	U.S.HISTORY	3.0	54 TOTAL HRS	TBA	FULLONLN	Benavides,E
------	----------	-------------	-----	--------------	-----	----------	-------------

Note: 6 week class: 06/09 - 07/17

HIST 018 is a survey of the political and social development of the United States from the Reconstruction Period to the present. Advisory: ENG 001A IGETC: 3B, 4F

Advisory: ENG 001A IGETC: 3B, 4F

[Asynchronous online classes - Students must access these fully online classes at www.collegeofthedesert.edu/ on or before June 9th, to begin the course.](http://www.collegeofthedesert.edu/)

0736	HIST 018	U.S.HISTORY	3.0	54 TOTAL HRS	TBA	FULLONLN	Simpson,R
------	----------	-------------	-----	--------------	-----	----------	-----------

Note: 6 week class: 06/09 - 07/17

0678	HIST 018	U.S.HISTORY	3.0	54 TOTAL HRS	TBA	FULLONLN	Collins,O
------	----------	-------------	-----	--------------	-----	----------	-----------

Note: 6 week class: 06/09 - 07/17

0786	HIST 018	U.S.HISTORY	3.0	54 TOTAL HRS	TBA	FULLONLN	Collins,O
------	----------	-------------	-----	--------------	-----	----------	-----------

Note: 6 week class: 06/09 - 07/17

HIST 021 covers the political, social, and economic development of California from early Spanish settlements to the present. Advisory: ENG 001A IGETC: 3B, 4F

Advisory: ENG 001A IGETC: 3B, 4F

[Asynchronous online classes - Students must access these fully online classes at www.collegeofthedesert.edu/ on or before June 9th, to begin the course.](http://www.collegeofthedesert.edu/)

0724	HIST 021	CALIFORNIA HISTORY	3.0	54 TOTAL HRS	TBA	FULLONLN	Collins,O
------	----------	--------------------	-----	--------------	-----	----------	-----------

Note: 6 week class: 06/09 - 07/17

0729	HIST 021	CALIFORNIA HISTORY	3.0	54 TOTAL HRS	TBA	FULLONLN	Collins,O
------	----------	--------------------	-----	--------------	-----	----------	-----------

Note: 6 week class: 06/09 - 07/17

Hotel & Restaurant

BUHM 031 is designed to teach you about the customer service work environment, methods for successful customer relations, and career advancement tactics.

0147	BUHM 031	CUSTOMER SERVICE MGMT	3.0	54 TOTAL HRS	TBA	FULLONLN	Bender,Y
------	----------	-----------------------	-----	--------------	-----	----------	----------

Note: 8 week class: 06/09 - 07/31

Note: Students must access this fully online class at www.collegeofthedesert.edu/ on or before June 9th, to begin the course.

BUHM 050 provides a basic understanding of the hospitality industry including lodging, food service, institutional, and resort operations.

0169	BUHM 050	INTRO/HOSPITALTY IND	3.0	54 TOTAL HRS	TBA	FULLONLN	Bender,Y
------	----------	----------------------	-----	--------------	-----	----------	----------

Note: 8 week class: 06/09 - 07/31

Note: Students must access this fully online class at www.collegeofthedesert.edu/ on or before June 9th, to begin the course.

BUHM 051 examines management of Food and Beverage Operations.

0179	BUHM 051	INTRO TO FOOD & BEV MGMT	3.0	54 TOTAL HRS	TBA	FULLONLN	Bender,Y
------	----------	--------------------------	-----	--------------	-----	----------	----------

Note: 8 week class: 06/09 - 07/31

Note: Students must access this fully online class at www.collegeofthedesert.edu/ on or before June 9th, to begin the course.

Student Computer Literacy and Access

One of the institutional outcomes for all COD students is technological literacy. As such, any class may be web enhanced and might require access to online sites such as Canvas, MyMathLab, MyLab, or the textbook publisher's website for assignments, testing, homework, etc. Internet-ready computers are available in a variety of locations, including the Tutoring and Academic Skills Center (TASC) and Library.

Department of Public Safety 760 341-2111 or EXT 2111

Public Safety officers are on duty 24 hours a day, 7 days a week. If you need assistance or wish to report a crime, please call the Public Safety number. On campus call 2111, off campus or on a cell phone, call 760 341-2111. The office is located in the South Annex, room 16. If the office is locked, you may contact the on duty Public Safety Officer via phone or by using the call box next to the office door. If you press the call button, it will call the on duty officer via their cell phone.

If an emergency exists that is severe or life threatening, call (911), then the Department of Public Safety. If you have questions about the Department, stop in the office and your questions can be answered.



Kinesiology

Kinesiology is the scientific study of human movement, including anatomy and physiology, exercise science, pedagogy, pre-physical therapy, health and fitness.

Students not attending the first class meeting may be replaced by other students.

SECT	COURSE	TITLE	U	TIME	DAYS	BLDG/RM	INSTRUCTOR
<p>BUHM 095A, a work experience course of supervised employment is designed to assist students in developing transferable employability skills, career awareness, learning industry culture, competencies and norms, and developing professional networks that support career mobility. To enroll, students must have a job or internship placement in a part-time or full-time capacity and related to Hotel and Restaurant Management. Students must work 54 hours per unit enrolled. For hour/unit conversion and course details, visit the Work Experience webpage: www.collegeofthedesert.edu/workexperience. This work experience course of supervised employment meets four times during the semester (2 on-campus coaching sessions and 2 job-site visits). Required Application Form, syllabus, and course related information will be available via Canvas by the first day of each session. For additional enrollment questions, contact the Work Experience office (760) 862-1344.</p>							
0833	BUHM 095A	HOTL/REST MGMT WK EX 1.0			TBA	AD5	Cooper,D
<p>Note: 8 week class: 06/09 - 07/31</p>							

Kinesiology

<p>KINE 001 includes the application of knowledge and development of basic skills in First Aid and Basic Life Support. Advisory: ENG 061</p>							
0474	KINE 001	FIRST AID AND SAFETY	3.0	08:00a-09:30a	TR	KINE103	Calderon,K
				36 TOTAL HRS	TBA	HYBRID	
<p>Note: 6 week class: 06/09 - 07/17</p> <p>Note: This class meets on the Palm Desert campus Tuesday and Thursday at 8:00am - 9:30am in room KINE 103. Remaining hours of this hybrid class are online in addition to homework assignments.</p> <p>Note: No class meetings June 19 and July 3</p>							
<p>KINE 008 is an introduction to the interdisciplinary approach to the study of human movement. An overview of the importance of the sub-disciplines in Kinesiology will be discussed along with career opportunities in the areas of teaching, coaching, allied health and fitness professions. Advisory: ENG 061</p> <p><u>Asynchronous online classes - Students must access these fully online classes at www.collegeofthedesert.edu/ on or before June 9th, to begin the course.</u></p>							
0226	KINE 008	INTRO TO KINESIOLOGY	3.0	54 TOTAL HRS	TBA	FULLONLN	STAFF
<p>Note: 6 week class: 06/09 - 07/17</p>							
0263	KINE 008	INTRO TO KINESIOLOGY	3.0	54 TOTAL HRS	TBA	FULLONLN	STAFF
<p>Note: 6 week class: 06/09 - 07/17</p> <p>Note: Section 0263 is a DEMAND CLASS and may open for enrollment when other sections have filled.</p>							
<p>KINE 010 is a survey course that focuses on the exploration of major topics involved with the maintenance of optimum health for the individual and society. Advisory: ENG 061</p> <p><u>Asynchronous online classes - Students must access these fully online classes at www.collegeofthedesert.edu/ on or before June 9th, to begin the course.</u></p>							
0242	KINE 010	PERS&COMM HEALTH	3.0	54 TOTAL HRS	TBA	FULLONLN	Ansley,W
<p>Note: 6 week class: 06/09 - 07/17</p>							
0244	KINE 010	PERS&COMM HEALTH	3.0	54 TOTAL HRS	TBA	FULLONLN	STAFF
<p>Note: 6 week class: 06/09 - 07/17</p> <p>Note: Section 0244 is a DEMAND CLASS and may open for enrollment when other sections have filled.</p>							
0286	KINE 010	PERS&COMM HEALTH	3.0	54 TOTAL HRS	TBA	FULLONLN	STAFF
<p>Note: 6 week class: 06/09 - 07/17</p> <p>Note: Section 0286 is a DEMAND CLASS and may open for enrollment when other sections have filled.</p>							
<p>KINE 094 emphasizes personal fitness, muscular endurance, strength, flexibility and cardiorespiratory conditioning levels.</p>							
0482	KINE 094	PERSONAL FITNESS	1.0	54 TOTAL HRS	TBA	FULLONLN	Parry,R
<p>Note: 6 week class: 06/09 - 07/17</p> <p>Note: Students must access this fully online class at www.collegeofthedesert.edu/ on or before June 9th, to begin the course.</p>							
<p>KINE 098A is the first of four levels of classes relating to Yoga. This course is an introduction to fundamental yoga postures and principles for personal health and wellness.</p> <p><u>Asynchronous online classes - Students must access these fully online classes at www.collegeofthedesert.edu/ on or before June 9th, to begin the course.</u></p>							
0472	KINE 098A	FUNDAMENTALS OF YOGA	1.0	54 TOTAL HRS	TBA	FULLONLN	Ansley,W
<p>Note: 6 week class: 06/09 - 07/17</p>							
0484	KINE 098A	FUNDAMENTALS OF YOGA	1.0	54 TOTAL HRS	TBA	FULLONLN	Ansley,W
<p>Note: 6 week class: 06/09 - 07/17</p>							

KINE 098B is the second of four levels of classes relating to yoga. The course presents beginning yoga postures and principles to improve personal health and wellness. Advisory: KINE 098A or equivalent of Fundamentals of Yoga

Asynchronous online classes - Students must access these fully online classes at www.collegeofthedesert.edu/ on or before June 9th, to begin the course.

0468	KINE 098B	BEGINNING YOGA	1.0	54 TOTAL HRS	TBA	FULLONLN	Ansley,W
------	-----------	----------------	-----	--------------	-----	----------	----------

Note: 6 week class: 06/09 - 07/17

0476	KINE 098B	BEGINNING YOGA	1.0	54 TOTAL HRS	TBA	FULLONLN	Ansley,W
------	-----------	----------------	-----	--------------	-----	----------	----------

Note: 6 week class: 06/09 - 07/17

KINE 098C is the third of four levels of classes relating to yoga. This course presents intermediate yoga postures and principles to improve personal health, flexibility, balance, and strength.

Advisory: KINE 098B or equivalent of Beginning Yoga

0464	KINE 098C	INTERMEDIATE YOGA	1.0	54 TOTAL HRS	TBA	FULLONLN	Ansley,W
------	-----------	-------------------	-----	--------------	-----	----------	----------

Note: 6 week class: 06/09 - 07/17

0478	KINE 098C	INTERMEDIATE YOGA	1.0	54 TOTAL HRS	TBA	FULLONLN	Ansley,W
------	-----------	-------------------	-----	--------------	-----	----------	----------

Note: 6 week class: 06/09 - 07/17

KINE 095A, a work experience course of supervised employment is designed to assist students in developing transferable employability skills, career awareness, learning industry culture, competencies and norms, and developing professional networks that support career mobility. To enroll, students must have a job or internship placement in a part-time or full-time capacity and related to Kinesiology. Students must work 54 hours per unit enrolled. For hour/unit conversion and course details, visit the Work Experience webpage: www.collegeofthedesert.edu/workexperience. This work experience course of supervised employment meets four times during the semester (2 on-campus coaching sessions and 2 job-site visits). Required Application Form, syllabus, and course related information will be available via Canvas by the first day of each session.

For additional enrollment questions, contact the Work Experience office (760) 862-1344.

0471	KINE 095A	KINESIOLOGY WORK EXPER	1.0		TBA	AD5	Ansley,W
------	-----------	------------------------	-----	--	-----	-----	----------

Note: 8 week class: 06/09 - 07/31

Varsity Sports, Off-Season

VSO 014C is intended for off season conditioning and skill development for intercollegiate men's basketball student-athletes during the summer semester. Limitation on Enrollment: Successful tryout

0796	VSO 014C	BASKETBALL MEN	1.0	58 TOTAL HRS	TBA	GYMMAIN	Romero,R
------	----------	----------------	-----	--------------	-----	---------	----------

Note: 9 week class: 06/09 - 08/08

VSO 015C is intended for off season conditioning and skill development for intercollegiate women's basketball student-athletes during the summer semester. Limitation on Enrollment: Successful tryout

0798	VSO 015C	BASKETBALL WOMEN	1.0	58 TOTAL HRS	TBA	GYMMAIN	Nguyen,H
------	----------	------------------	-----	--------------	-----	---------	----------

Note: 9 week class: 06/09 - 08/08

VSO 033B is intended for off season conditioning and skill development for intercollegiate football student-athletes during the summer semester. Limitation on Enrollment: Successful tryout

0714	VSO 033B	FOOTBALL	1.0	58 TOTAL HRS	TBA	FLDFLD	Steptoe,J
------	----------	----------	-----	--------------	-----	--------	-----------

Note: 5 week class: 07/07 - 08/08

VSO 042 is intended for off season conditioning and skill development for men's and women's intercollegiate golf student-athletes during the summer semester. Limitation on Enrollment: Successful tryout

0780	VSO 042	GOLF	1.0	58 TOTAL HRS	TBA	GOLFRNGE	Bown,T
------	---------	------	-----	--------------	-----	----------	--------

Note: 5 week class: 07/07 - 08/08

Note: Intended for students interested in trying out for the Women's Golf team.

VSO 053B is intended for off season conditioning and skill development for men's intercollegiate soccer student-athletes during the summer semester. Limitation on Enrollment: Successful tryout

0725	VSO 053B	SOCCER MEN	1.0	58 TOTAL HRS	TBA	FLDFLD	STAFF
------	----------	------------	-----	--------------	-----	--------	-------

Note: 9 week class: 06/09 - 08/08

VSO 054B is intended for off season conditioning and skill development for women's intercollegiate soccer student-athletes during the summer semester. Limitation on Enrollment: Successful tryout

0768	VSO 054B	SOCCER WOMEN	1.0	58 TOTAL HRS	TBA	FLDFLD	STAFF
------	----------	--------------	-----	--------------	-----	--------	-------

Note: 9 week class: 06/09 - 08/08



**>>Check <<
the start-date
end-date &
drop deadlines
that apply to each
class you select**

Student Education Plans (SEP)

Did you know that the Student Success Act of 2012 (SB 1456) requires students with 15 degree applicable units or three semesters of attendance (whichever comes first), to have an SEP in order to receive priority registration.

In compliance with this law, students that meet those conditions and do not have an SEP will have to register much later than other students during Open Enrollment.

If you need more information about the SEP process, contact the Counseling Center at (760) 773-2521.

Planning to Transfer?
www.assist.org

Your official source for California articulation and student transfer information.

SECT	COURSE	TITLE	U	TIME	DAYS	BLDG/RM	INSTRUCTOR
VSO 057B physically prepares softball student-athletes for the competitive athletic season. Limitation on Enrollment: Successful tryout							
0772	VSO 057B	SOFTBALL	1.0	58 TOTAL HRS	TBA	FLDFLD	Finan,K
Note: 8 week class: 06/09 - 08/01 Intended for off season conditioning and skill development for intercollegiate softball student-athletes during the summer semester. Limitation on Enrollment: Successful tryout							
VSO 074B is intended for off season conditioning and skill development for intercollegiate volleyball student-athletes during the summer semester. Limitation on Enrollment: Successful tryout							
0790	VSO 074B	VOLLEYBALL	1.0	58 TOTAL HRS	TBA	GYMMAIN	Rothe,D
Note: 9 week class: 06/09 - 08/08							

Mass Communication

MC 001 introduces students to the contributions and influences of mass media in popular culture.
 Advisory: ENG 061 IGETC: 4G
Asynchronous online classes - Students must access these fully online classes at www.collegeofthedesert.edu/ on or before June 9th, to begin the course.

0728	MC 001	INTRO TO MASS MEDIA	3.0	54 TOTAL HRS	TBA	FULLONLN	Jackson,L
Note: 3 week class: 06/09 - 06/27							
0722	MC 001	INTRO TO MASS MEDIA	3.0	54 TOTAL HRS	TBA	FULLONLN	Jackson,L
Note: 6 week class: 06/09 - 07/17							
0749	MC 001	INTRO TO MASS MEDIA	3.0	54 TOTAL HRS	TBA	FULLONLN	Jackson,L
Note: 8 week class: 06/09 - 07/31 Note: Section 0749 is a DEMAND CLASS and may open for enrollment when other sections have filled.							

Mathematics

MATH 001A is the first course, Differential Calculus, in the traditional 3 semester Calculus sequence.
 Prerequisite: MATH 012 Advisory: ENG 001A IGETC: 2A

0359	MATH 001A	CALCULUS	4.0	09:00a-12:20p	MTWR	MSTC150	Kleinfelter,D
Note: 8 week class: 06/09 - 07/31 Note: No class meetings June 19 and July 3							
MATH 001B is the second semester of Calculus. It covers methods and applications of integration and infinite series. Prerequisite: MATH-001A IGETC: 2A							
0341	MATH 001B	CALCULUS II	4.0	11:00a-02:20p	MTWR	NDIOB206	Podlesny,B
Note: 8 week class: 06/09 - 07/31 Note: This OFF-CAMPUS CLASS meets at the Indio Campus, 45524 Oasis Street, Indio Note: No class meetings June 19 and July 3							
MATH 005 is the first of a two semester sequence preparing students for Calculus. In this course, students will study functions with an emphasis on the trigonometric functions along with topics in analytic geometry. Prerequisite: MATH 049 or qualifying placement, Advisory: ENG 001A and Advisory Corequisite: MATH 355A							
0349	MATH 005	TRIGONOMETRY	5.0	08:00a-10:50a	MTWR	NDIOB206	Podlesny,B
Note: 8 week class: 06/09 - 07/31 Note: This OFF-CAMPUS CLASS meets at the Indio Campus, 45524 Oasis Street, Indio. Note: No class meetings June 19 and July 3							
0377	MATH 005	TRIGONOMETRY	5.0	01:00p-03:50p	MTWR	MSTC152	Lege,G
Note: 8 week class: 06/09 - 07/31 Note: No class meetings June 19 and July 3							
0383	MATH 005	TRIGONOMETRY	5.0	90 TOTAL HRS	TBA	FULLONLN	Le,T
Note: 8 week class: 06/09 - 07/31 Note: Students must access this fully online class at www.collegeofthedesert.edu/ on or before June 9th, to begin the course.							
MATH 010 is a function oriented course including the concept of a function and function notation. Prerequisite: MATH 049 or qualifying placement, Advisory Prerequisite: ENG 001A and Advisory Corequisite: MATH 351 IGETC: 2A							
0331	MATH 010	COLLEGE ALGEBRA	4.0	09:00a-12:20p	MTWR	MSTC151	Garcia,V
Note: 8 week class: 06/09 - 07/31 Note: No class meetings June 19 and July 3							
0339	MATH 010	COLLEGE ALGEBRA	4.0	02:00p-05:20p	MTWR	NDIOB328	Palafox,D
Note: 8 week class: 06/09 - 07/31 Note: This OFF-CAMPUS CLASS meets at the Indio Campus, 45524 Oasis Street, Indio. Note: No class meetings June 19 and July 3							

SECT	COURSE	TITLE	U	TIME	DAYS	BLDG/RM	INSTRUCTOR
------	--------	-------	---	------	------	---------	------------



The pEDGE program provides 2025 high school graduates (or equivalent) from the Coachella Valley with two full years of tuition and fees at College of the Desert!

Participating students will complete at least one EDGE non-credit course to prepare for college and college-level coursework or a credit summer course to be eligible for pEDGE. EDGE non-credit courses: English EDGE (ENG-300), Math/Statistics EDGE (MATH-300 or SOC-300), or Student Development EDGE (COUN-300).

Students must also have a completed Financial Aid file, commit to full time enrollment, maintain good academic standing and participate in career preparation and community service. For more information, please contact the pEDGE office at (760) 636-7970 or edge@collegeofthedesert.edu

Asynchronous online classes - Students must access these fully online classes at www.collegeofthedesert.edu/ on or before June 9th, to begin the course.

0313 MATH 010 COLLEGE ALGEBRA 4.0 108 TOTAL HRS TBA FULLONLN Jordan,L
Note: 8 week class: 06/09 - 07/31

0384 MATH 010 COLLEGE ALGEBRA 4.0 108 TOTAL HRS TBA FULLONLN Jordan,L
Note: 8 week class: 06/09 - 07/31

0353 MATH 010 COLLEGE ALGEBRA 4.0 108 TOTAL HRS TBA FULLONLN Miller,L
Note: 8 week class: 06/09 - 07/31
 Note: Section 0353 is a DEMAND CLASS and may open for enrollment when other sections have filled.

MATH 012 is the second in a two semester sequence preparing students for Calculus. In this course, students will extend the concept of a function to polynomial, rational, exponential and logarithmic functions as well as studying analytic trigonometry. Prerequisite: MATH 005 or qualifying placement, Advisory Corequisite: MATH 355B IGETC: 2A*

0364 MATH 012 PRE-CALCULUS 5.0 09:00a-11:50a MTWR MSTC152 Lege,G
Note: 8 week class: 06/09 - 07/31
 Note: No class meetings June 19 and July 3

▶0315 MATH 012 PRE-CALCULUS 5.0 01:00p-03:50p MTWR NDI0B225 McJilton,M
Note: 8 week class: 06/09 - 07/31
 Note: This OFF-CAMPUS CLASS meets at the Indio Campus, 45524 Oasis Street, Indio.
 Note: No class meetings June 19 and July 3
 Note: Section 0315 is a DEMAND CLASS and may open for enrollment when other sections have filled.

▶0319 MATH 012 PRE-CALCULUS 5.0 05:15p-08:05p MTWR NDI0B206 McJilton,M
Note: 8 week class: 06/09 - 07/31
 Note: This OFF-CAMPUS CLASS meets at the Indio Campus, 45524 Oasis Street, Indio.
 Note: No class meetings June 19 and July 3

0311 MATH 012 PRE-CALCULUS 5.0 90 TOTAL HRS TBA FULLONLN Mortada,J
Note: 8 week class: 06/09 - 07/31
 Note: Students must access this fully online class at www.collegeofthedesert.edu/ on or before June 9th, to begin the course.

MATH 014 is an introduction to descriptive and inferential statistics using measures of central tendency and dispersion of samples, probability, confidence intervals, and hypothesis testing to draw inferences about one or more populations. Prerequisite: MATH 045 or MATH 049 or qualifying placement, Advisory: ENG 001A and Advisory Corequisite: MATH 310; IGETC: 2A*

0394 MATH 014 STATISTICAL METHODS 4.0 01:00p-04:20p MTWR MSTC150 Garcia,V
Note: 8 week class: 06/09 - 07/31

▶0352 MATH 014 STATISTICAL METHODS 4.0 62 TOTAL HRS TBA HYBRID Palafox,D
Note: 8 week class: 06/09 - 07/31
 05:50p-08:55p TR NDI0B328
 Note: Students must access the lecture portion of this hybrid class at www.collegeofthedesert.edu/ on or before June 9th, to begin the course. All lecture hours will be asynchronous online in addition to homework assignments. All lab hours will be face to face OFF-CAMPUS at the Indio Campus, 45524 Oasis Street on Tuesdays and Thursdays.
 Note: No class meetings June 19 and July 3

Asynchronous online classes - Students must access these fully online classes at www.collegeofthedesert.edu/ on or before June 9th, to begin the course.

0378 MATH 014 STATISTICAL METHODS 4.0 108 TOTAL HRS TBA FULLONLN Kleinfelter,D
Note: 8 week class: 06/09 - 07/31

0385 MATH 014 STATISTICAL METHODS 4.0 108 TOTAL HRS TBA FULLONLN Miller,L
Note: 8 week class: 06/09 - 07/31
 Note: Section 0385 is a DEMAND CLASS and may open for enrollment when other sections have filled.

MATH 300 combines a review of mathematical concepts and skills, an introduction to mathematics course offerings at College of the Desert, and guidance in the transition from high school to college mathematics. Students receive a Pass/No Pass grade mark

9452 MATH 300 MATH EDGE 0.0 09:00a-12:05p MTWR SOC12 STAFF
Note: 3 week class: 06/09 - 06/26
 Note: No class meeting June 19

▶9458 MATH 300 MATH EDGE 0.0 12:00p-03:05p MTWR NDI0B226 STAFF
Note: 3 week class: 06/09 - 06/26
 Note: This OFF-CAMPUS CLASS meets at the Indio Campus, 45524 Oasis Street, Indio.
 Note: No class meeting June 19

9448 MATH 300 MATH EDGE 0.0 12:00p-03:05p MTWR SOC12 STAFF
Note: 3 week class: 06/30 - 07/17
 Note: No class meeting July 3

36 MATH - NATR

Physical Therapist Assistant program Summer 2025

Applications for the cohort starting in the Summer of 2026 will be opening during the Fall 2025 semester, please check program website for up to date information.

To learn more and apply, visit the program website: <https://www.collegeofthedesert.edu/.../physic.../default.php>.

For questions about the application process or the program, contact Dr. Matthew Wilson, Program Director at mawilson@collegeofthedesert.edu

Accreditation status as of 3/7/25:
(For current accreditation status please visit the program website).

The Physical Therapist Assistant Program at College of the Desert is accredited by the Commission on Accreditation in Physical Therapy Education (CAPTE), 3030 Potomac Ave., Suite 100, Alexandria, Virginia 22305-3085; telephone: 703-706-3245; email: accreditation@apta.org; website: <http://www.capteonline.org>.

If needing to contact the program/institution directly, please call 760-773-2578 or email PTAAdmissions@collegeofthedesert.edu.

SECT	COURSE	TITLE	U	TIME	DAYS	BLDG/RM	INSTRUCTOR
▶9472	MATH 300	MATH EDGE	0.0	12:00p-03:05p	MTWR	NDIOB226	STAFF
		Note: 3 week class: 06/30 - 07/17					
		Note: This OFF-CAMPUS CLASS meets at the Indio Campus, 45524 Oasis Street, Indio.					
		Note: No class meeting July 3					
9486	MATH 300	MATH EDGE	0.0	09:00a-11:50a	MTWR	SOC12	STAFF
		Note: 3 week class: 07/21 - 08/07					
9420	MATH 300	MATH EDGE	0.0	12:00p-02:50p	MTWR	SOC12	STAFF
		Note: 3 week class: 07/21 - 08/07					
9440	MATH 300	MATH EDGE	0.0	03:00p-05:50p	MTWR	SOC12	STAFF
		Note: 3 week class: 07/21 - 08/07					
		<u>Asynchronous online classes - Students must access these fully online classes at www.collegeofthedesert.edu/ on or before the start date of the class, to begin the course.</u>					
9454	MATH 300	MATH EDGE	0.0	36 TOTAL HRS	TBA	FULLONLN	STAFF
		Note: 3 week class: 06/09 - 06/26					
9462	MATH 300	MATH EDGE	0.0	36 TOTAL HRS	TBA	FULLONLN	STAFF
		Note: 3 week class: 06/09 - 06/26					
9464	MATH 300	MATH EDGE	0.0	36 TOTAL HRS	TBA	FULLONLN	STAFF
		Note: 3 week class: 06/09 - 06/26					
9474	MATH 300	MATH EDGE	0.0	36 TOTAL HRS	TBA	FULLONLN	STAFF
		Note: 3 week class: 06/30 - 07/17					
9476	MATH 300	MATH EDGE	0.0	36 TOTAL HRS	TBA	FULLONLN	STAFF
		Note: 3 week class: 06/30 - 07/17					
9478	MATH 300	MATH EDGE	0.0	36 TOTAL HRS	TBA	FULLONLN	STAFF
		Note: 3 week class: 06/30 - 07/17					
9492	MATH 300	MATH EDGE	0.0	36 TOTAL HRS	TBA	FULLONLN	STAFF
		Note: 3 week class: 07/21 - 08/07					
9496	MATH 300	MATH EDGE	0.0	36 TOTAL HRS	TBA	FULLONLN	STAFF
		Note: 3 week class: 07/21 - 08/07					

Music

MUS 005 is a survey of rock music.

0534 MUS 005 HISTORY/ROCK N ROLL 3.0 54 TOTAL HRS TBA IGETC: 3A FULLONLN Carey,J

Note: 8 week class: 06/09 - 07/31

Note: Students must access this fully online class at www.collegeofthedesert.edu/ on or before June 9th, to begin the course.

MUS 010 is a survey of art music in western civilization.

0522 MUS 010 INTRO TO MUSIC 3.0 54 TOTAL HRS TBA IGETC: 3A FULLONLN Carey,J

Note: 8 week class: 06/09 - 07/31

Note: Students must access this fully online class at www.collegeofthedesert.edu/ on or before June 9th, to begin the course.

MUS 012 is a basic course in music theory designed to develop an understanding of notation, rhythm, pitch, keys, scales, intervals, triads and music terminology. IGETC: 3A

Asynchronous online classes - Students must access these fully online classes at www.collegeofthedesert.edu/ on or before June 9th, to begin the course.

0524 MUS 012 FUNDAMENTALS/MUSIC 3.0 54 TOTAL HRS TBA FULLONLN Fesmire,A

Note: 8 week class: 06/09 - 07/31

0654 MUS 012 FUNDAMENTALS/MUSIC 3.0 54 TOTAL HRS TBA FULLONLN Fesmire,A

Note: 8 week class: 06/09 - 07/31

Natural Resources

NR 001 is an environmental science course examining the impacts of humans on this planet. Topics covered include ecology, water, pollution, atmospheric change, energy and population.

Advisory: NR 001L;

0198 NR 001 CONSV NATRL RESRS 3.0 54 TOTAL HRS TBA IGETC: 5B FULLONLN Morgan,E

Note: 8 week class: 06/09 - 07/31

Note: Students must access this fully online class at www.collegeofthedesert.edu/ on or before June 9th, to begin the course.

Philosophy

PHIL 006 examines Philosophy's contribution to knowledge and culture. Advisory: ENG 061 IGETC: 3B

0720 PHIL 006 INTRO TO PHILOSOPHY 3.0 06:00p-09:30p TR CNVSZOOM Smith,M
Note: 8 week class: 06/10 - 07/31
 Note: This is a synchronous online class. Students must access this class via Canvas during the scheduled days/times.
 Note: No class meetings June 19 and July 3

PHIL 013, Death - The Final Frontier Advisory: ENG 061 IGETC: 3B

0718 PHIL 013 PERSP ON DEATH/DYING 3.0 54 TOTAL HRS TBA FULLONLN Garcia,R
Note: 8 week class: 06/09 - 07/31
 Note: Students must access this fully online class at www.collegeofthedesert.edu/ on or before June 9th, to begin the course.

Physical Therapist Assistant

PTA 001 is an overview course designed to give the Physical Therapy Assistant (PTA) student an understanding of the profession of physical therapy. Prerequisite: ENG 001A Limitation on enrollment: Admission to the Physical Therapist Assistant (PTA) Program.

0381 PTA 001 INTRO TO PHYS THER 2.5 11:00a-01:15p MW N4 Hlavin,D
Note: 5 week class: 05/28 - 06/25 02:30p-04:45p MW N4

PTA 002 introduces common diseases and illnesses that involve the skilled intervention of the Physical Therapist Assistant. Prerequisite: BI 014 Advisory: ENG 001A Limitation on enrollment: Admission to the Physical Therapist Assistant (PTA) Program

0386 PTA 002 PATH PHYS 2.5 11:00a-01:05p MW N4 Spurgin,K
Note: 5 week class: 06/30 - 07/30 02:30p-04:35p MW N4

PTA 003 introduces principles and procedures for physical therapy interventions commonly utilized in the inpatient setting. Advisory: ENG 001A Limitation on enrollment: Admission to the Physical Therapist Assistant (PTA) Program

0391 PTA 003 THERA PROCED I 3.0 08:30a-11:20a TR BNC39 Kurunathan,S
Note: 6 week class: 07/08 - 08/14 01:00p-05:15p TR BNC39 Tse,YI

PTA 005 focuses on understanding assessment of biomechanics through goniometric and muscle testing. Prerequisite: KINE 008 Advisory: ENG 001A Limitation on enrollment: Admission to the Physical Therapist Assistant (PTA) Program

0387 PTA 005 KINE LAB 1.0 12:00p-05:10p TR S.AN13 Bishop,E
Note: 6 week class: 05/27 - 07/01 Hlavin,D
 Note: No class meeting June 19

PTA 009 covers kinesiology of the cervical, thoracic and lumbar spines and upper and lower extremities. Includes assessment techniques and activities of daily living (ADL's). Prerequisite: KINE 008 Advisory: ENG 001A Limitation on enrollment: Admission to the Physical Therapist Assistant (PTA) Program

0389 PTA 009 FUNC ANT + KINE 3.0 08:15a-10:30a MTWR N4 Hlavin,D
Note: 6 week class: 05/27 - 07/02
 Note: No class meeting June 19

Political Science

PS 001 is an introduction to the principles, organization and politics of the National Government of the United States, including the study of State and local government. Advisory: ENG 001A IGETC: 4H
Asynchronous online classes - Students must access these fully online classes at www.collegeofthedesert.edu/ on or before June 9th, to begin the course.

0634 PS 001 INTRO TO GOVERNMENT 3.0 54 TOTAL HRS TBA FULLONLN Walker,E
Note: 6 week class: 06/09 - 07/17
 0642 PS 001 INTRO TO GOVERNMENT 3.0 54 TOTAL HRS TBA FULLONLN Walker,E
Note: 6 week class: 06/09 - 07/17
 0662 PS 001 INTRO TO GOVERNMENT 3.0 54 TOTAL HRS TBA FULLONLN Walker,E
Note: 6 week class: 06/09 - 07/17
 0603 PS 001 INTRO TO GOVERNMENT 3.0 54 TOTAL HRS TBA FULLONLN Clerc,A
Note: 8 week class: 06/09 - 07/31
 0608 PS 001 INTRO TO GOVERNMENT 3.0 54 TOTAL HRS TBA FULLONLN Fuchs,S
Note: 8 week class: 06/09 - 07/31
 0615 PS 001 INTRO TO GOVERNMENT 3.0 54 TOTAL HRS TBA FULLONLN Fuchs,S
Note: 8 week class: 06/09 - 07/31
 0628 PS 001 INTRO TO GOVERNMENT 3.0 54 TOTAL HRS TBA FULLONLN Clerc,A
Note: 8 week class: 06/09 - 07/31

Political Science PS 001 - Introduction to Government

This course is an introduction to the principles, organization and politics of the National Government of the U.S., including the study of State and local government. In considering government at the State level, specific emphasis is given to the government of the State of California. Throughout the course, current issues in American and State politics are stressed.

**Advisory: ENG 001A
IGETC: 4H**

**Introduction to Race
Ethnicity**

SOC 014

This course focuses on intergroup race and ethnic relations with a social-historical emphasis. As such, the course covers the origins, implications, and current consequences of race, ethnicity, prejudice, discrimination, assimilation, and pluralism from the perspective of specific social and historical contexts.

Advisory: ENG 061
IGETC: 4C, 4J

Section 0713 is offered asynchronously this Summer.

**Student Education
Plans (SEP)**

Did you know that the Student Success Act of 2012 (SB 1456) requires students with 15 degree applicable units or three semesters of attendance (whichever comes first), to have an SEP in order to receive priority registration.

In compliance with this law, students that meet those conditions and do not have an SEP will have to register much later than other students during Open Enrollment.

If you need more information about the SEP process, contact the Counseling Center at (760) 773-2521.

SECT	COURSE	TITLE	U	TIME	DAYS	BLDG/RM	INSTRUCTOR
------	--------	-------	---	------	------	---------	------------

Psychology

PSY 001 is an introduction to psychology and defines the principles and theories governing the scientific study of affect, behavior and cognition, which include developmental psychology, states of consciousness, psychotropic agents, learning, memory, motivation, social psychology, and psychological disorders. Advisory: ENG 061 IGETC: 4I

0666 PSY 001 GEN PSYCHOLOGY 3.0 07:30a-09:40a MTWR CNVSZOOM Dolan,K
Note: 6 week class: 06/09 - 07/17

Note: This is a synchronous online class. Students must access this class via Canvas during the scheduled days/times.

Asynchronous online classes - Students must access these fully online classes at www.collegeofthedesert.edu/ on or before June 9th, to begin the course.

0658 PSY 001 GEN PSYCHOLOGY 3.0 54 TOTAL HRS TBA FULLONLN Brooks,W
Note: 6 week class: 06/09 - 07/17

0604 PSY 001 GEN PSYCHOLOGY 3.0 54 TOTAL HRS TBA FULLONLN Lotto,J
Note: 8 week class: 06/09 - 07/31

0606 PSY 001 GEN PSYCHOLOGY 3.0 54 TOTAL HRS TBA FULLONLN Alvarez,E
Note: 8 week class: 06/09 - 07/31

0613 PSY 001 GEN PSYCHOLOGY 3.0 54 TOTAL HRS TBA FULLONLN Dolan,K
Note: 8 week class: 06/09 - 07/31

0676 PSY 001 GEN PSYCHOLOGY 3.0 54 TOTAL HRS TBA FULLONLN Alvarez,E
Note: 8 week class: 06/09 - 07/31

PSY 003 is a life span course that focuses on the behavioral patterns found at each level of normal human development, including the interrelationships of psychological, sociological, cognitive, and physical development from birth to senescence. Advisory: PSY 001 & ENG 061 IGETC: 4I

Asynchronous online classes - Students must access these fully online classes at www.collegeofthedesert.edu/ on or before June 9th, to begin the course.

0684 PSY 003 DEVLPMNTL PSYCHOLOGY 3.0 54 TOTAL HRS TBA FULLONLN Emerson,L
Note: 8 week class: 06/09 - 07/31

0688 PSY 003 DEVLPMNTL PSYCHOLOGY 3.0 54 TOTAL HRS TBA FULLONLN Emerson,L
Note: 8 week class: 06/09 - 07/31

0760 PSY 003 DEVLPMNTL PSYCHOLOGY 3.0 54 TOTAL HRS TBA FULLONLN Emerson,L
Note: 8 week class: 06/09 - 07/31

PSY 012 is an introductory course focusing on the development and practice of human sexuality through exploration of the physiological, psychological, social, cognitive and personal dimensions of human behavior. Advisory: ENG-001A IGETC: 4G

0704 PSY 012 HUMAN SEXUALITY 3.0 02:00p-05:30p TR CNVSZOOM Alvarez,E
Note: 8 week class: 06/10 - 07/31

Note: This is a synchronous online class. Students must access this fully online class via Canvas during the scheduled days/times.

Note: No class meetings June 19 and July 3

PSY 025 is an introduction to the research methodology utilized in the social sciences and will include a survey of contemporary approaches for study designs and research techniques.

Prerequisite: PSY 001 & SOC 003 or MATH 014 Advisory: ENG 001A

0758 PSY 025 RESEARCH METHODS 3.0 54 TOTAL HRS TBA FULLONLN Cornell,R
Note: 8 week class: 06/09 - 07/31

Note: Students must access this fully online class at www.collegeofthedesert.edu/ on or before June 9th, to begin the course.

PSY 027 covers the involvement of the neurological and endocrine system in psychology processes including emotion, behavior, cognition, personality, motivation, and psychopathology. Prerequisite: PSY-001 or concurrent enrollment Advisory: ENG-001A IGETC: 4I

0689 PSY 027 BIOLOGICAL PSYCHOLOGY 3.0 12:00p-03:30p TR CNVSZOOM Abdul-Majid,0
Note: 8 week class: 06/10 - 07/31

Note: This is a synchronous online class. Students must access this fully online class via Canvas during the scheduled days/times.

Note: No class meetings June 19 and July 3

Sociology

SOC 001 is a survey of the characteristics of social life, the processes of social interaction, and the tools of sociological investigation. Advisory: ENG 061 IGETC: 4J

0705	SOC 001	INTRO SOCIOLOGY	3.0	01:00p-04:05p	MW	SOC9	STAFF
------	---------	-----------------	-----	---------------	----	------	-------

Note: 8 week class: 06/09 - 07/30
 Note: Section 0705 is a DEMAND CLASS and may open for enrollment when other sections have filled.

Asynchronous online classes - Students must access these fully online classes at www.collegeofthedesert.edu/ on or before June 9th, to begin the course.

0703	SOC 001	INTRO SOCIOLOGY	3.0	54 TOTAL HRS	TBA	FULLONLN	Aleman,A
0726	SOC 001	INTRO SOCIOLOGY	3.0	54 TOTAL HRS	TBA	FULLONLN	Aleman,A
0782	SOC 001	INTRO SOCIOLOGY	3.0	54 TOTAL HRS	TBA	FULLONLN	Aleman,A

Note: 6 week class: 06/09 - 07/17
Note: 6 week class: 06/09 - 07/17
Note: 6 week class: 06/09 - 07/17

SOC 003 is a study of the fundamental concepts and techniques of statistical analysis that are encountered in all areas of Social Science. Prerequisite: MATH 049 or MATH 045 & ENG 061 IGETC: 2A*

Asynchronous online classes - Students must access these fully online classes at www.collegeofthedesert.edu/ on or before June 9th, to begin the course.

0626	SOC 003	FUND OF STATISTICS	3.0	54 TOTAL HRS	TBA	FULLONLN	Daut,V
0638	SOC 003	FUND OF STATISTICS	3.0	54 TOTAL HRS	TBA	FULLONLN	Daut,V
0706	SOC 003	FUND OF STATISTICS	3.0	54 TOTAL HRS	TBA	FULLONLN	Cathcart,J
0707	SOC 003	FUND OF STATISTICS	3.0	54 TOTAL HRS	TBA	FULLONLN	McKenzie,L
0712	SOC 003	FUND OF STATISTICS	3.0	54 TOTAL HRS	TBA	FULLONLN	Daut,V
0723	SOC 003	FUND OF STATISTICS	3.0	54 TOTAL HRS	TBA	FULLONLN	McKenzie,L
0764	SOC 003	FUND OF STATISTICS	3.0	54 TOTAL HRS	TBA	FULLONLN	McKail,M

Note: 6 week class: 06/09 - 07/17
Note: 6 week class: 06/09 - 07/17
Note: 6 week class: 06/09 - 07/17
Note: 6 week class: 06/09 - 07/17
Note: 6 week class: 06/09 - 07/17
Note: 6 week class: 06/09 - 07/17
Note: 6 week class: 06/09 - 07/17

SOC 004 is an introduction to the process of thinking, logic, and reasoning from a sociological perspective.

The goal is to develop the critical understanding and effective analysis of arguments, personal problems, and social issues. Prerequisite: ENG 001A & MATH 054 IGETC: 1B

Asynchronous online classes - Students must access these fully online classes at www.collegeofthedesert.edu/ on or before June 9th, to begin the course.

0740	SOC 004	SOC/CRIT THINKING	3.0	54 TOTAL HRS	TBA	FULLONLN	Black,A
0752	SOC 004	SOC/CRIT THINKING	3.0	54 TOTAL HRS	TBA	FULLONLN	Black,A
0756	SOC 004	SOC/CRIT THINKING	3.0	54 TOTAL HRS	TBA	FULLONLN	Black,A

Note: 6 week class: 06/09 - 07/17
Note: 6 week class: 06/09 - 07/17
Note: 6 week class: 06/09 - 07/17

SOC 014 focuses on intergroup race and ethnic relations with a social-historical emphasis. As such, the course covers the origins, implications, and current consequences of race, ethnicity, prejudice, discrimination, assimilation, and pluralism from the perspective of specific social and historical contexts.

Advisory: ENG 061 IGETC: 4C, 4J

0713	SOC 014	INTRO RACE ETHNICITY	3.0	54 TOTAL HRS	TBA	FULLONLN	Cathcart,J
------	---------	----------------------	-----	--------------	-----	----------	------------

Note: 6 week class: 06/09 - 07/17
 Note: Students must access this fully online class at www.collegeofthedesert.edu/ on or before June 9th, to begin the course.

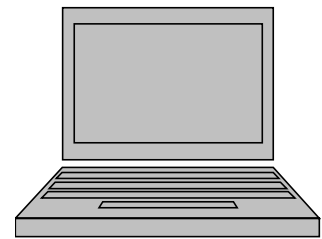

Interested in a
Distance Education
class?

Go to the
 Student Services/Online
 Classes page at:
collegeofthedesert.edu

All online students must:

1. Complete the standard admission and registration process.
2. Access the online class (or classes) by logging in to MyCOD on or before the start date of the class, to begin the course.
3. Have their own computer and Internet access. The college does **not** provide computers or Internet access for students in online classes.

If you have additional questions about our online program, please visit the College of the Desert home page. Click on the Student Services tab for "Online Classes".

40 SOC - SPAN

What Spanish Courses to Take

The following information will help you select the Spanish course you need to take according to your proficiency level.

Spanish as a Foreign Language Track

A student can take Spanish as a Foreign Language if he/she is a native speaker of English or another foreign language. If a student has never taken Spanish, he/she must be enrolled in SPAN 001-Elementary Spanish I (5 units). If a student has taken 1, 2, or more years of Spanish in high school or another institution, he/she may take the Spanish placement exam to determine his/her proficiency level. He/she may be placed in SPAN 002-Elementary Spanish II (5 units).

Spanish Placement Test

Note: To ensure the correct placement in a Spanish course, students can self-enroll in the Spanish Placement Test on CANVAS on June 9, 5:00pm.-7:00pm, June 11, 10:00am-12:00pm.

Use this link:
<https://collegeofthedesert.instructure.com/enroll/8FBEHD>

In person and synchronous online Evening Classes appear in BOLD print throughout this schedule.

SECT	COURSE	TITLE	U	TIME	DAYS	BLDG/RM	INSTRUCTOR
SOC 300 prepares incoming college students for college-level statistics. Students will learn and/or review statistical calculations, analysis, and interpretation. The foundational statistical concepts learned in this course will help lead to academic success in statistics courses. Students receive a Pass/No Pass grade mark.							
Asynchronous online classes - Students must access these fully online classes at www.collegeofthedesert.edu/ on or before the start date of the class, to begin the course.							
9415	SOC 300	STATISTICS EDGE	0.0	15 TOTAL HRS	TBA	FULLONLN	McKenzie,L
Note: 3 week class: 06/09 - 06/26							
9417	SOC 300	STATISTICS EDGE	0.0	15 TOTAL HRS	TBA	FULLONLN	Aleman,A
Note: 3 week class: 06/09 - 06/26							
9419	SOC 300	STATISTICS EDGE	0.0	15 TOTAL HRS	TBA	FULLONLN	Cathcart,J
Note: 3 week class: 06/09 - 06/26							
9421	SOC 300	STATISTICS EDGE	0.0	15 TOTAL HRS	TBA	FULLONLN	Daut,V
Note: 3 week class: 06/09 - 06/26							
9463	SOC 300	STATISTICS EDGE	0.0	15 TOTAL HRS	TBA	FULLONLN	Daut,V
Note: 3 week class: 06/30 - 07/17							
9465	SOC 300	STATISTICS EDGE	0.0	15 TOTAL HRS	TBA	FULLONLN	McKenzie,L
Note: 3 week class: 06/30 - 07/17							
9467	SOC 300	STATISTICS EDGE	0.0	15 TOTAL HRS	TBA	FULLONLN	Aleman,A
Note: 3 week class: 06/30 - 07/17							
9469	SOC 300	STATISTICS EDGE	0.0	15 TOTAL HRS	TBA	FULLONLN	Cathcart,J
Note: 3 week class: 06/30 - 07/17							
9571	SOC 300	STATISTICS EDGE	0.0	15 TOTAL HRS	TBA	FULLONLN	Daut,V
Note: 3 week class: 07/21 - 08/07							
9573	SOC 300	STATISTICS EDGE	0.0	15 TOTAL HRS	TBA	FULLONLN	Aleman,A
Note: 3 week class: 07/21 - 08/07							
9575	SOC 300	STATISTICS EDGE	0.0	15 TOTAL HRS	TBA	FULLONLN	Cathcart,J
Note: 3 week class: 07/21 - 08/07							
9577	SOC 300	STATISTICS EDGE	0.0	15 TOTAL HRS	TBA	FULLONLN	McKenzie,L
Note: 3 week class: 07/21 - 08/07							

Spanish

SPAN 001 covers the fundamentals of Spanish with emphasis on the four skills: speaking, understanding, reading, writing. IGETC: 6A

Asynchronous online classes - Students must access these fully online classes at www.collegeofthedesert.edu/ on or before June 9th, to begin the course.

0344	SPAN 001	ELEM SPANISH I 5.0	90 TOTAL HRS		TBA	FULLONLN	Torres-Mendez,M
Note: 6 week class: 06/09 - 07/17							
0361	SPAN 001	ELEM SPANISH I 5.0	90 TOTAL HRS		TBA	FULLONLN	Torres-Mendez,M
Note: 6 week class: 06/09 - 07/17							
0373	SPAN 001	ELEM SPANISH I 5.0	90 TOTAL HRS		TBA	FULLONLN	Torres-Mendez,M
Note: 6 week class: 06/09 - 07/17							
Note: Section 0373 is a DEMAND CLASS and may open for enrollment when other sections have filled.							

SPAN 002 covers the fundamentals of Spanish with an emphasis on the four skills: speaking, understanding, reading, writing. Prerequisite: SPAN-001 or two years high school Spanish IGETC: 3B, 6A

Asynchronous online classes - Students must access these fully online classes at www.collegeofthedesert.edu/ on or before June 9th, to begin the course.

0327	SPAN 002	ELEM SPANISH II 5.0	90 TOTAL HRS		TBA	FULLONLN	Vazquez,S
Note: 6 week class: 06/09 - 07/17							
0372	SPAN 002	ELEM SPANISH II 5.0	90 TOTAL HRS		TBA	FULLONLN	Vazquez,S
Note: 6 week class: 06/09 - 07/17							

SECT	COURSE	TITLE	U	TIME	DAYS	BLDG/RM	INSTRUCTOR
------	--------	-------	---	------	------	---------	------------

Vocational Nursing

VN 030 builds on previous concepts with the focus of care on the pediatric client. Students will also learn skill and theory to transition from student to novice nurse.

0732	VN 030	VOC NURSING III	5.0	09:00a-01:50p	WR	N8	Hernandez,M
------	--------	-----------------	-----	---------------	----	----	-------------

Note: 10 week class: 06/04 - 08/07
 Note: No class meetings June 19 and July 3

VN 030L is a co-requisite of VN 030. Students meet the needs for the hospitalized child and clients experiencing labor, delivery, and postpartum in the clinical setting.

0734	VN 030L	VOC NURSING III LAB	4.0	06:45a-01:50p	MTF	VARIOUS	Hernandez,M STAFF
------	---------	---------------------	-----	---------------	-----	---------	----------------------

Note: 10 week class: 06/02 - 08/08

0738	VN 030L	VOC NURSING III LAB	4.0	06:45a-01:50p	MTF	VARIOUS	Hernandez,M STAFF
------	---------	---------------------	-----	---------------	-----	---------	----------------------

Note: 10 week class: 06/02 - 08/08

0746	VN 030L	VOC NURSING III LAB	4.0	06:45a-01:50p	MTF	VARIOUS	Hernandez,M STAFF
------	---------	---------------------	-----	---------------	-----	---------	----------------------

Note: 10 week class: 06/02 - 08/08
 Note: Registration requires HSED Division approval.
 Note: All sections of VN-030L will rotate through patient clinics, long term care, and acute care facilities.

Welding

WELD 012A students are introduced to the safe and efficient practices of GMAW welding.

0118	WELD 012A	INTRO GMAW WELD	2.0	05:00p-09:50p	MTWR	AS106	Carlisle,T
------	-----------	-----------------	-----	---------------	------	-------	------------

Note: 4 week class: 06/09 - 07/02
 Note: No class meetings June 19 and July 3

WELD 012B, is an intermediate GMAW welding course. Emphasis on vertical position. Prerequisite: WELD 012A

0127	WELD 012B	INTERM GMAW WELDING	2.0	05:00p-09:15p	MTWR	AS106	Carlisle,T
------	-----------	---------------------	-----	---------------	------	-------	------------

Note: 4 week class: 07/07 - 07/31

Work Experience, General

WEG 095A, a work experience course of supervised employment is designed to assist students in developing transferable employability skills, career awareness, learning industry culture, competencies and norms, and developing professional networks that support career mobility. To enroll, students must have a job or internship placement in a part-time or full-time capacity. Students must work 54 hours per unit enrolled. For hour/unit conversion and course details, visit the Work Experience Education webpage: www.collegeofthedesert.edu/workexperience. This work experience course of supervised employment meets four times during the semester (2 on-campus coaching sessions and 2 job-site visits). Required Application Form, syllabus, and course related information will be available via Canvas by the first day of each session.

0802	WEG 095A	WORK EXPERIENCE, GEN	1.0		TBA	AD5	Hernandez,A
------	----------	----------------------	-----	--	-----	-----	-------------

Note: 8 week class: 06/09 - 07/31

Handshake

Looking for a job or internship? Get started on creating your profile to connect with employers hiring COD talent.

Visit: <https://collegeofthedesert.join->



Career & Workforce Solutions Center
760 674-7799

The mission of the Career and Workforce Solutions Center is to enhance student success by empowering students with the tools and skills necessary to be active participants in their career development. The Center supports the economic vitality of the Coachella Valley and beyond by serving as a bridge between individuals seeking gainful employment and diverse industries needing to attract and retain a skilled and educated workforce.

- Resume Writing
- Job Search Assistance
- Interview Skills
- Explore Majors
- Career Assessments
- Career Counseling
- Work Experience
- Internships



INDIO CAMPUS EXPANSION

45524 OASIS STREET, INDIO, CA 92201
LAST UPDATED: 11/03/2024

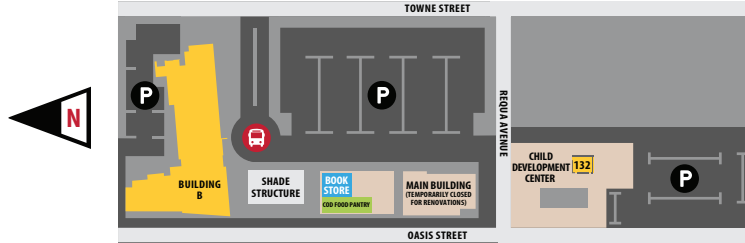

DRIVING DIRECTIONS FROM INTERSTATE 10:

- TAKE I-10 EAST
- EXIT JACKSON STREET (EXIT 143)
- TURN RIGHT ONTO REQUA AVENUE
- TURN RIGHT ONTO OASIS STREET
- INDIO CAMPUS IS ON THE RIGHT

- COD CLASSROOMS
- COMMON AREAS
- NOT ACCESSIBLE TO PUBLIC
- ACCESSIBLE TO PUBLIC
- PARKING
- EMERGENCY EXIT
- RESTROOMS
- GENDER NEUTRAL RESTROOM
- BUS STOP
- ELEVATORS
- WATER BOTTLE FILLING STATION
- LACTATION ROOM
- AED
- EMERGENCY EVACUATION CHAIR
- PUBLIC SAFETY 442-666-9439

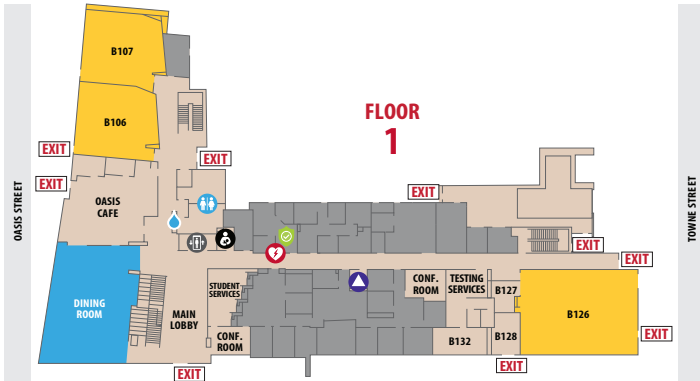
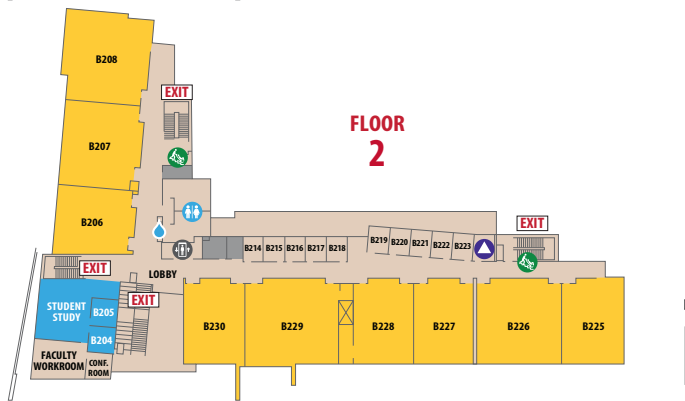
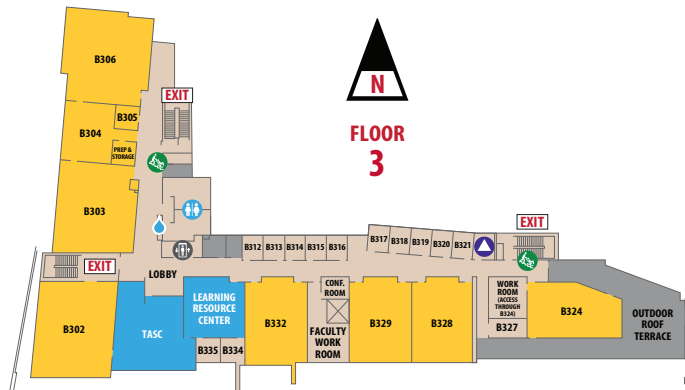

College of the Desert - Indio

Biology

BI 013 is the first of a two course sequence that offers an in depth study of the human body. This course covers anatomical terminology, cells and tissues, the integumentary system, the skeletal system, articulations, the muscular system, the nervous system and special senses.

Prerequisite: MATH 054 Advisory: ENG 061 IGETC: 5B, 5C

0632	BI 013	ANAT & PHYS I	4.0	09:00a-10:30a	MTWR	NDIOB303	Tesch,A
------	--------	---------------	-----	---------------	------	----------	---------

Note: 8 week class: 06/09 - 07/31 10:45a-12:15p MTWR NDIOB229

Note: This OFF-CAMPUS CLASS meets at the Indio Campus, 45524 Oasis Street, Indio. Students at off-campus sites should allow sufficient travel time to arrive on time and remain for the duration of the class. Non-Participation and excessive absences may be grounds for being dropped from a course.

Note: No class meetings June 19 and July 3

0672	BI 013	ANAT & PHYS I	4.0	02:00p-03:30p	MTWR	NDIOB303	Tesch,A
------	--------	---------------	-----	---------------	------	----------	---------

Note: 8 week class: 06/09 - 07/31 03:45p-05:15p MTWR NDIOB229

Note: This OFF-CAMPUS CLASS meets at the Indio Campus, 45524 Oasis Street, Indio. Students at off-campus sites should allow sufficient travel time to arrive on time and remain for the duration of the class. Non-Participation and excessive absences may be grounds for being dropped from a course.

Note: No class meetings June 19 and July 3

Counseling

COUN 300 provides an introduction to College of the Desert for all incoming college students. Through this course, students will gain an understanding of our college structure, academic programs offered, student planning, financial aid, college expectations and support services. Students receive a Pass/No Pass grade mark.

9322	COUN 300	STUD DEV EDGE	0.0	09:00a-10:50a	MW	NDIOB328	STAFF
------	----------	---------------	-----	---------------	----	----------	-------

Note: 3 week class: 06/09 - 06/25

9326	COUN 300	STUD DEV EDGE	0.0	12:00p-01:50p	MW	NDIOB302	STAFF
------	----------	---------------	-----	---------------	----	----------	-------

Note: 3 week class: 06/09 - 06/25

9324	COUN 300	STUD DEV EDGE	0.0	10:00a-12:10p	TR	NDIOB302	STAFF
------	----------	---------------	-----	---------------	----	----------	-------

Note: 3 week class: 06/10 - 06/26

Note: No class meeting June 19th

9330	COUN 300	STUD DEV EDGE	0.0	05:00p-06:50p	MW	NDIOB302	STAFF
------	----------	---------------	-----	---------------	----	----------	-------

Note: 3 week class: 06/09 - 06/25

9364	COUN 300	STUD DEV EDGE	0.0	09:00a-10:50a	MW	NDIOB328	STAFF
------	----------	---------------	-----	---------------	----	----------	-------

Note: 3 week class: 06/30 - 07/16

Child Development & Education

CDE 204 explores the application of child development theory to facilitate learning among young children, including: promoting self esteem, creativity, self discipline, development of physical and cognitive skills and literacy, and planning appropriate curriculum along with professional development of the teacher. Prerequisite: CDE 101 & CDE 102 & CDE 103 & CDE 104 & CDE 203 (formerly ECE 001, ECE 010, ECE 012, ECE 040 & ECE 046B)

0771	CDE 204	PRACTICUM	4.0	144 TOTAL HRS	TBA	HYFLEX	Avalos,M
------	---------	-----------	-----	---------------	-----	--------	----------

Note: 8 week class: 06/09 - 07/31

Note: Choose how you attend class: (1) in-class physically Monday at 5:00pm-8:45pm at the Child Development Center, 45742 Oasis Street, room NDIO 132, Indio, (2) live streaming class at the same days and times via Zoom, or (3) watching Zoom recordings on your own. You have the flexibility to attend any way your schedule permits. Additional work is completed and submitted online via Canvas. HyFlex courses help you complete your education while allowing you to adapt it to your life. Students must access Canvas at www.collegeofthedesert.edu/on or before June 9th, to begin the course.

Note: Students will complete student teaching practicum hours (108 hours) with a Mentor Teacher at sites in the Coachella Valley or with a Child Development Specialist at the COD McCarthy Family Child Development and Training Center.

Note: Students are required to have a valid TB skin test prior to working with children and can obtain it through the college by emailing the professor, maavalos@collegeofthedesert.edu Additional immunizations/vaccinations MMR, Tdap, COVID) will be required before starting lab hours.

DIRECTIONS see map on page 42 of this class schedule for directions to the Indio Campus.

All classes with "**NDIO**" rooms meet at the Indio Campus, 45524 Oasis Street, Indio.

There are additional off site locations on page 45. See section note for exact location.

For more information about our Indio location, registration and classes, call (760) 776-7200

Tutoring & Academic Skills Center (TASC)
June 9 - July 31
 (760) 773-2557

Monday - Thursday
 8:00 a.m. - 6:00 p.m.
 subject to change without notice.

Students at off campus sites should allow sufficient travel time to arrive on time and remain for the duration of the class. Non-participation and excessive absences may be grounds for being dropped from a course.

Department of Public Safety

Indio Campus
 (442) 400-5311
 or
 EXT 5311
 or
 (442) 666-9439 (cell)
 (442) 666-9438 (cell)

Evening Classes appear in BOLD print throughout this schedule.

Disabled Students Programs & Services

DSPS 315 is designed to support new college students with disabilities master the skills required to be a successful college student. Some of the topics include basic college technology skills, navigating the college systems, self-advocacy, and resources for success.

8834	DSPS 315	DSPS TRANSITION	0.0	09:00a-10:15a	MW	NDIOB302	Cambron,P
		Note: 8 week class: 06/09 - 07/30		18 TOTAL HRS	TBA	HYBRID	

Note: This is a hybrid online class that meets in person on Mondays and Wednesdays OFF-CAMPUS at the Indio Campus, 45524 Oasis Street. All remaining required hours will be asynchronous online in addition to homework assignments.

English

ENG 300 prepares incoming college students for the rigors of college-level reading and writing, and college-level English courses specifically. Students will learn and/or review the academic norms that lead to academic success and some foundational essay-writing concepts. Students receive a Pass/No Pass grade mark.

9321	ENG 300	ENGLISH EDGE	0.0	09:00a-10:50a	TR	NDIOB226	Spence,C
		Note: 3 week class: 06/09 - 06/26		12 TOTAL HRS	TBA	HYBRID	

Note: This is a hybrid class with in person meetings on Tuesdays and Thursdays. All required remaining hours will be online in addition to homework assignments.

9329	ENG 300	ENGLISH EDGE	0.0	05:00p-06:50p	TR	NDIOB226	Hernandez,M
		Note: 3 week class: 06/09 - 06/26		12 TOTAL HRS	TBA	HYBRID	

Note: This is a hybrid class with in person meetings on Tuesdays and Thursdays. All required remaining hours will be online in addition to homework assignments.

9345	ENG 300	ENGLISH EDGE	0.0	09:00a-10:50a	MW	NDIOB226	Rivera,J
		Note: 3 week class: 06/30 - 07/17		12 TOTAL HRS	TBA	HYBRID	

Note: This is a hybrid class with in person meetings on Mondays and Wednesdays. All required remaining hours will be online in addition to homework assignments.

9561	ENG 300	ENGLISH EDGE	0.0	09:00a-10:50a	MW	NDIOB226	Rivera,J
		Note: 3 week class: 07/21 - 08/07		12 TOTAL HRS	TBA	HYBRID	

Note: This is a hybrid class with in person meetings on Mondays and Wednesdays. All required remaining hours will be online in addition to homework assignments.

9563	ENG 300	ENGLISH EDGE	0.0	11:00a-12:50p	MW	NDIOB226	McKowan,C
		Note: 3 week class: 07/21 - 08/07		12 TOTAL HRS	TBA	HYBRID	

Note: This is a hybrid class with in person meetings on Mondays and Wednesdays. All required remaining hours will be online in addition to homework assignments.

English As A Second Language - Noncredit

Note: ESLN classes are 8 weeks starting June 9th and ending July 31st. Some classes are taught on TechConnect Zoom with assignments completed on Canvas, other sections meet in person. Students receive a Pass/No Pass grade mark.

ESLN 387A is the foundations-level vocabulary and beginning conversation practice using learned vocabulary on everyday life topics.

7948	ESLN 387A	ESL - CONVERSATION BEG	0.0	06:00p-07:50p	MTWR	NDIOB227	Camacho,A
------	-----------	------------------------	-----	---------------	------	----------	-----------

ESLN 388A is the low beginning conversation practice using learned vocabulary on everyday life topics.

7954	ESLN 388A	ESL - CONVERSATION I	0.0	06:00p-07:50p	MTWR	NDIOB225	Church,M
------	-----------	----------------------	-----	---------------	------	----------	----------

ESLN 388B is the high beginning conversation practice using learned vocabulary on everyday life topics.

7984	ESLN 388B	ESL - CONVERSATION II	0.0	06:00p-07:50p	MTWR	NDIOB230	Holster,M
------	-----------	-----------------------	-----	---------------	------	----------	-----------

ESLN 388C is the low intermediate conversation practice using learned vocabulary on everyday life topics.

7992	ESLN 388C	ESL - CONVERSATION III	0.0	06:00p-07:50p	MTWR	NDIOB228	Lua,A
------	-----------	------------------------	-----	---------------	------	----------	-------

ESLN 388D is the high intermediate conversation practice using learned vocabulary in a variety of situations.

7782	ESLN 388D	ESL - CONVERSATION IV	0.0	06:00p-07:50p	MTWR	NDIOB329	Hummer,K
------	-----------	-----------------------	-----	---------------	------	----------	----------

COD - East Valley

To learn more about the East Valley Education Centers, call 760-776-7200, visit us online at www.college-ofthedesert.edu/indio, or email offcampussites@collegeofthedesert.edu.

Self Service

College of the Desert has transitioned to a new way of registering and making changes to your class schedule.

Self Service is available for Summer and Fall registration.

Check out the information on page 7 of this class schedule. Watch the COD website for more details.

Adult Basic Education (ABE) and English As A Second Language (ESLN) Registration

Registration for new/continuing ABE students will begin on 4/15/2025.

English As A Second Language (ESLN) Registration:

Registration for new and continuing students will begin on 04/15/2025.

Please visit the College of the Desert Admissions webpage and click on the Adult Basic Education Registration link or the English As A Second Language link for details.

Mathematics

MATH 001B is the second semester of Calculus. It covers methods and applications of integration and infinite series. Prerequisite: MATH-001A IGETC: 2A

0341 MATH 001B CALCULUS II 4.0 11:00a-02:20p MTWR NDI0B206 Podlesny,B
Note: 8 week class: 06/09 - 07/31
 Note: No class meetings June 19 and July 3

MATH 005 is the first of a two semester sequence preparing students for Calculus. In this course, students will study functions with an emphasis on the trigonometric functions along with topics in analytic geometry. Prerequisite: MATH 049 or qualifying placement,

Advisory: ENG 001A and Advisory Corequisite: MATH 355A
 0349 MATH 005 TRIGONOMETRY 5.0 08:00a-10:50a MTWR NDI0B206 Podlesny,B
Note: 8 week class: 06/09 - 07/31

MATH 010 is a function oriented course including the concept of a function and function notation. Prerequisite: MATH 049 or qualifying placement, Advisory Prerequisite: ENG 001A and

Advisory Corequisite: MATH 351 IGETC: 2A
 0339 MATH 010 COLLEGE ALGEBRA 4.0 02:00p-05:20p MTWR NDI0B328 Palafox,D
Note: 8 week class: 06/09 - 07/31
 Note: No class meetings June 19 and July 3

MATH 012 is the second in a two semester sequence preparing students for Calculus. In this course, students will extend the concept of a function to polynomial, rational, exponential and logarithmic functions as well as studying analytic trigonometry. Prerequisite: MATH 005 or qualifying placement,

Advisory Corequisite: MATH 355B IGETC: 2A*
 0315 MATH 012 PRE-CALCULUS 5.0 01:00p-03:50p MTWR NDI0B225 McJilton,M
Note: 8 week class: 06/09 - 07/31
 Note: No class meetings June 19 and July 3

Note: Section 0315 is a DEMAND CLASS and may open for enrollment when other sections have filled.

0319 MATH 012 PRE-CALCULUS 5.0 05:15p-08:05p MTWR NDI0B206 McJilton,M
Note: 8 week class: 06/09 - 07/31
 Note: No class meetings June 19 and July 3

MATH 014 is an introduction to descriptive and inferential statistics using measures of central tendency and dispersion of samples, probability, confidence intervals, and hypothesis testing to draw inferences about one or more populations. Prerequisite: MATH 045 or MATH 049 or qualifying placement, Advisory: ENG 001A and Advisory Corequisite: MATH 310; IGETC: 2A*

0352 MATH 014 STATISTICAL METHODS 4.0 62 TOTAL HRS TBA HYBRID Palafox,D
Note: 8 week class: 06/09 - 07/31 05:50p-08:55p TR NDI0B328
 Note: Students must access the lecture portion of this hybrid class at www.collegeofthedesert.edu/ on or before June 9th, to begin the course. All lecture hours will be asynchronous online in addition to homework assignments. All lab hours will be face to face OFF-CAMPUS at the Indio Campus on Tuesdays and Thursdays.
 Note: No class meetings June 19 and July 3

MATH 300 combines a review of mathematical concepts and skills, an introduction to mathematics course offerings at College of the Desert, and guidance in the transition from high school to college mathematics. Students receive a Pass/No Pass grade mark

9458 MATH 300 MATH EDGE 0.0 12:00p-03:05p MTWR NDI0B226 STAFF
Note: 3 week class: 06/09 - 06/26
 Note: No class meeting June 19

9472 MATH 300 MATH EDGE 0.0 12:00p-03:05p MTWR NDI0B226 STAFF
Note: 3 week class: 06/30 - 07/17
 Note: No class meeting July 3

College of the Desert - Mecca/Thermal

9607 COUN 300 STUD DEV EDGE 0.0 11:00a-12:50p TR MECCB6 STAFF
Note: 3 week class: 07/22 - 08/07

College of the Desert - Desert Hot Springs

9368 COUN 300 STUD DEV EDGE 0.0 09:00a-11:10a TR CDHS41 STAFF
Note: 3 week class: 07/01 - 07/17
 Note: This OFF-CAMPUS CLASS meets at the Wenzlaff Center, 11625 West Drive in Desert Hot Springs.
 Note: No class meeting July 3.



The pLEDGE program provides 2025 high school graduates (or equivalent) from the Coachella Valley with two full years of tuition and fees at College of the Desert!

Participating students will complete at least one EDGE non-credit course to prepare for college and college-level coursework or a credit summer course to be eligible for pLEDGE.

EDGE non-credit courses: English EDGE (ENG-300), Math/Statistics EDGE (MATH-300 or SOC-300), or Student Development EDGE (COUN-300).

Students must also have a completed Financial Aid file, commit to full time enrollment, maintain good academic standing and participate in career preparation and community service. For more information, please contact the pLEDGE office at (760) 636-7970 or edge@collegeofthedesert.edu

If you signed up for an online, hybrid, or hyflex section of one of the courses below, you will need access to the following, in addition to a reliable Internet connection, a computer, and applications like Microsoft Excel, Word, etc. and/or the equivalent. Web browsers are needed to access various websites, including our learning management system (Canvas) and Proctorio.

Please note that this list can be amended as needed. An updated version can be found on the College of the Desert “Catalogs and Schedules” webpage.

Social Sciences and Arts:

- DDP 100 – Adobe Creative Cloud and desktop or laptop able to run the software
- DDP 101 – Adobe Photoshop and iPad Pro or similar device and desktop or laptop able to run the software and Certiport Adobe Certified Professional Exam
- DDP 102 – Adobe Illustrator and iPad Pro or similar device and desktop or laptop able to run the software and Certiport Adobe Certified Professional Exam
- DDP 111 – Adobe Creative Cloud and desktop or laptop able to run the software and Certiport Adobe Certified Professional Exam
- DDP 113 – Adobe Creative Cloud and desktop or laptop able to run the software and Certiport Adobe Certified Professional Exam
- DDP 116 – Adobe Creative Cloud and desktop or laptop able to run the software and Certiport Adobe Certified Professional Exam
- DDP 120 – Adobe Creative Cloud and desktop or laptop able to run the software and Certiport Adobe Certified Professional Exam
- DDP 121 – Adobe Creative Cloud and desktop or laptop able to run the software and Certiport Adobe Certified Professional Exam
- DDP 130 – Adobe Lightroom and iPad Pro or similar device and desktop or laptop able to run the software
- DDP 131 – DSL Camera and Adobe Photoshop and iPad Pro or similar device and desktop or laptop able to run the software
- DDP 132 – DSL Camera and Adobe Photoshop and iPad Pro or similar device and desktop or laptop able to run the software
- DDP 150 – Adobe Creative Cloud and desktop or laptop able to run the software and Certiport Adobe Certified Professional Exam
- DDP 195 – MS Office and Adobe Creative Cloud and desktop or laptop able to run the software and Certiport Adobe Certified Professional Exam
- MUS 012 – Any device with video recording capability like a smartphone or tablet
- MUS-078A – Software: VCV Rack, PreSonus Studio ONE; Hardware: Nektar ImpactLX25 and MIDI Controller
- MUS-078B – Software: PreSonus Studio ONE; Hardware: PreSonus Audiobox USB96, PreSonus M7 Microphone

Applied Sciences and Business:

- AIS 02A – TestOut
- AIS 03A – TestOut
- AIS 04A – TestOut
- AIS 072 – TestOut
- AIS 025 – Cengage
- AIS 005 – TestOut and/or LinkedIn Learning
- AIS 012 – LinkedIn Learning
- AIS 006 – Cengage and/or LinkedIn Learning

Health Sciences and Education

- HS 013 – My Diet Analysis app

A	AGRICULTURAL SCIENCE BLDG. Agricultural Science Classrooms	KINE	KINESIOLOGY/ATHLETICS OFFICE
ADMIN	ADMINISTRATION BUILDING Administrative Offices, COD FoundationKINE 101	Kinesiology/Fitness/Weight Room
.....AD-3	Faculty Resource Center (FRC)	LA	LIBERAL ARTS BUILDING
.....AD-5	Career & Workforce Solutions CenterLA 11	Berger Faculty Innovation Center
ALUM	COD Alumni Centre Street Fair Management	LIBRARY	City of Palm Desert Library
ART	ART STUDIO BUILDING	M	MAINTENANCE BUILDING
AS	APPLIED SCIENCES BUILDING School of Applied Sciences & BusinessM 2	Music Classroom
B	BUSINESS BUILDING	MARKS	Walter N. Marks Center for the Arts
C	Board of Trustees Meeting Room	MATH	MATH BUILDING
CDC	CHILD DEVELOPMENT CENTERMATH 4	Math and Science Office
CMH	CAROL MEIER LECTURE HALL	MSTC	Math/Science Lab
.....CMH PT	The POLLOCK TheatreMSTC 146	MATH SCIENCE TECHNOLOGY CENTER
COM	COMMUNICATION BUILDING School of Communication & Humanities	MCCALLUM	MESA Office
CRTS	ABE - Adult Basic Education	N	McCallum Theatre
CSSC	ESLN-English As A Second Language	BNC	NURSING BUILDING
	Tennis Courts	N.AN	Nursing, Voc. Nursing, Health Science
	CRAVENS STUDENT SERVICES CENTER	PSA	BARKER NURSING COMPLEX
	Admissions & Records (A&R)	S	School of Health Sciences and Education
	Bookstore	SOC	NORTH MODULAR ANNEX
	Bursar's Office	S.AN	PUBLIC SAFETY ACADEMY
	CalWORKSS.AN 1	SCIENCE BUILDING(closed for construction)
	Counseling CenterS.AN 2	SOCIAL SCIENCES BUILDING
	Disabled Students Programs & ServicesS.AN 4	School of Social Sciences and Arts
	DSPS High Tech CenterS.AN 5	SOUTH MODULAR ANNEX
	EOPS/CARES.AN 7	Dreamer Resource Center
	Financial Aid OfficeS.AN 10-12	Foster Youth Services
	Health Services/College NurseS.AN 13,14	MAKR SPACE classroom
	International Education OfficeS.AN 16	Pride Center
	Parking Services	SE.AN	Intensive English Academy
	Transfer Center	STG	Trio Programs
	Veterans Resource Center	T	Physical Therapist Assistant Lab
DH	Dining Hall - BEEPS		Department of Public Safety
	Student Government/Student Clubs		SOUTHEAST MODULAR ANNEX
	Office of Student Life		Human Resources
DM	DIESEL MECHANICS BUILDING		Fiscal Services
	Automotive Technology 1st Floor		STAGECRAFT BUILDING
	General Classrooms - 2nd Floor		THEATRE BLDG (Theatre Too)
ECE	EARLY CHILDHOOD EDUCATION BLDG.		
GOLFINST	COLLEGE GOLF CENTER		
.....GOLFRNGE	Golf Driving Range		
GYM	GYMNASIUM.		
.....GYM MAIN	Gym Main Floor		
HILB	COD LIBRARY		
	Learning Resources		
	Distance Education		
.....Second Floor	TUTORING & ACADEMIC SKILLS CTR		
	Computer Lab and Tutoring Center		
	Language Lab		

OFF CAMPUS ABBREVIATIONS

CDHS	Desert Hot Springs, 11625 West Drive
NDIO	Indio Campus
MECC	Mecca/Thermal Campus
PS	Palm Springs Temporary Campus
RWTC	Roy Wilson Training Center, Thousand Palms

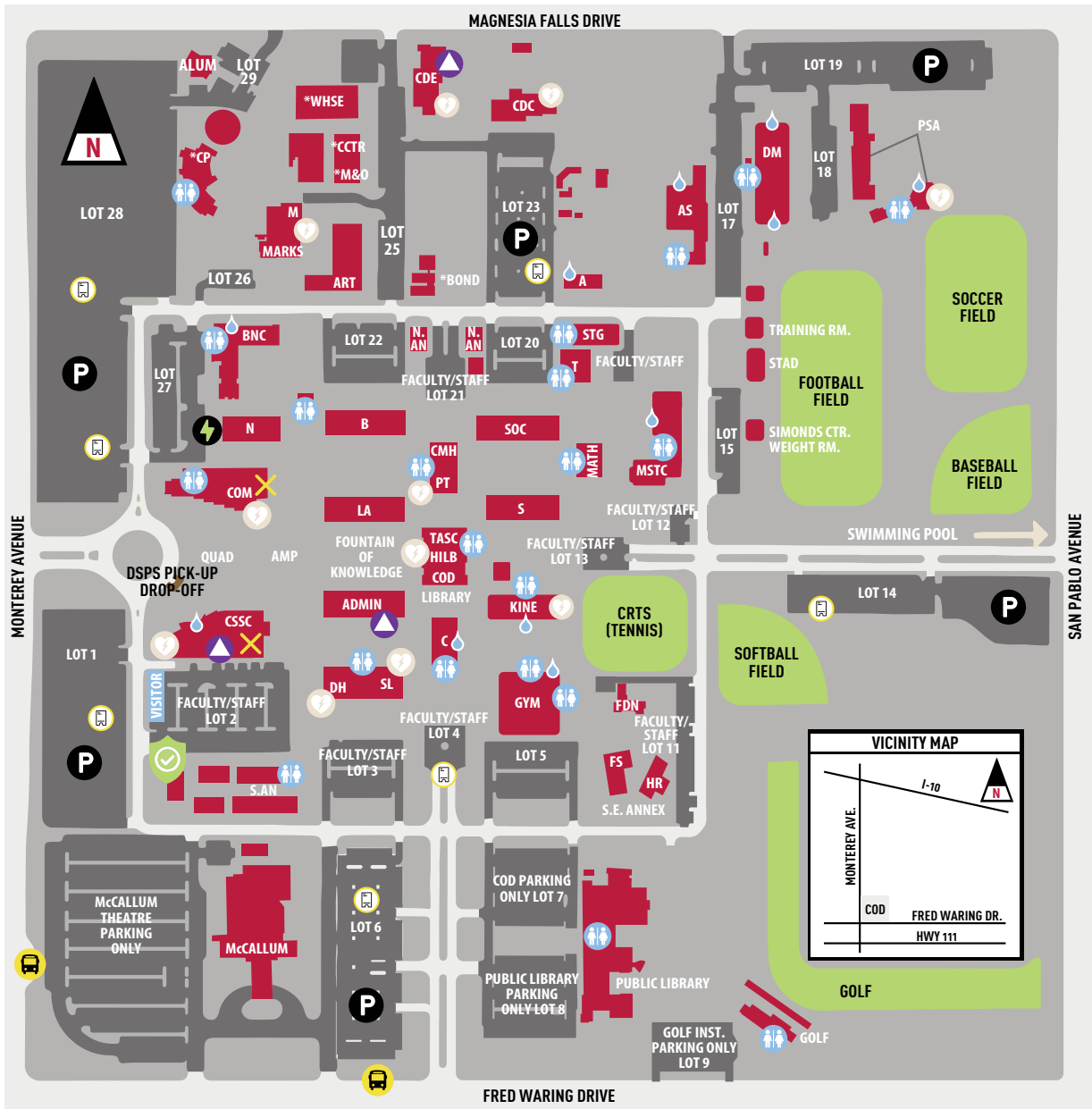

PUBLIC SAFETY
 PARKING
 RESTROOMS
 GENDER NEUTRAL RESTROOMS
 AED
 BUS STOP
 EVAC CHAIRS
 SELF SERVE ONE-DAY PARKING PERMIT DISPENSER
 EV CHARGING STATION
 WATER BOTTLE FILLING STATION

<p>A Agricultural Sciences ADMIN Administration ALUM Alumni Centre AMP Amphitheatre ART Art AS Applied Sciences B Business Building BNC Barker Nursing Center BOND Bond Office C Board Room CDC Child Development Center CMH Carol Meier Lecture Hall CP Central Plant CCTR Copy Center COM Communication</p>	<p>CRTS Tennis Courts CSSC Cravens Student Services Center DM Diesel Mechanics DH Dining Hall CDE Childhood Development Education FS Fiscal Services FDN Foundation GOLF College Golf Center GYM Gymnasium HILB Hilb Building COD Library HR Human Resources KINE Kinesiology LA Liberal Arts</p>	<p>M Music Classroom M&O Maintenance & Operations MARKS Walter N. Marks Center for the Arts MATH Math McCallum Theatre MSTC Math Science Technology Center N. Nursing N. AN Noth Annex PSA Public Safety Academy PT Pollock Theatre PUBLIC LIBRARY Public Library QUAD Student Plaza (Drop-off & Walkway) S Science SIMONDS Center Weight Room</p>	<p>S. AN South Annex SOC Social Sciences STAD Stadium STG Stagecraft Shop SL Student Life TASC Tutoring Academic Skills Center T Theatre Too Training Room Warehouse</p> <p style="text-align: right;">*STAFF ONLY</p>
---------------------------------------------------------------------------------------------------------------------------------------------------------------------------------------------------------------------------------------------------------------------------------------------------------------------------------------------------------------------------------------------------------------------------------------------------------------------------------------------------------------------------------------------------------------------------------------------------------------------	------------------------------------------------------------------------------------------------------------------------------------------------------------------------------------------------------------------------------------------------------------------------------------------------------------------------------------------------------------------------------------------------------------------------------------------------------------------------------------------------------------------------------------------------------------------------------------	-------------------------------------------------------------------------------------------------------------------------------------------------------------------------------------------------------------------------------------------------------------------------------------------------------------------------------------------------------------------------------------------------------------------------------------------------------------------------------------------------------------------------------------------------------------------------------------------------------------------------------------------------	-------------------------------------------------------------------------------------------------------------------------------------------------------------------------------------------------------------------------------------------------------------------------------------------------------------------------------------------------------------------------------------------------------

